

**SCHEDULE OF QUANTITIES**

RELOCATE  
 TEMPORARY CONCRETE BARRIER  
 STATION TO STATION FEET  
 702+90 705+90 300  
 TOTAL - 300

IMPACT ATTENUATORS, RELOCATE  
 (NON-REDIRECTIVE), TEST LEVEL 3 - 2 EACH

**LEGEND**

- TRAFFIC SIGNAL WITH BACKPLATE, SIGNAL DIRECTION INDICATED
- BASE COURSE WIDENING, 10"
- PAVEMENT REMOVAL
- HMA SHOULDER, 8"
- INCIDENTAL HMA SURFACING
- AGG SURF CSE, TYPE A
- TYPE III BARRICADES CLOSING A ROAD TO ALL TRAFFIC AS SHOWN ON STANDARD 701901

**GENERAL NOTES**

1. TRAFFIC CONTROL SHALL BE ERECTED AS SHOWN AND ACCORDING TO "TRAFFIC CONTROL AND PROTECTION, STANDARD 701321."
2. SEE SPECIAL PROVISIONS FOR ADDITIONAL TRAFFIC CONTROL REQUIREMENTS.
3. COORDINATE LOCATION OF SIGNALS WITH FINAL WORK AS DIRECTED BY THE ENGINEER.
4. CONSTRUCT TEMPORARY RUMBLE STRIPS AT LOCATIONS SHOWN ON STANDARD 701321.
5. ADDITIONAL SIGNAGE FOR ENTRANCES AND ADVANCE WIDTH RESTRICTION WARNING SIGN SHALL BE INCLUDED IN THE COST OF STANDARD 701321.
6. THE DIMENSION SHOWN ON THE WIDTH RESTRICTION SIGN (W12-1102(O)-48) SHOWN ON STANDARD 701321 AND ON THE ADVANCE WARNING SIGN (W12-1103) SHOWN ON THIS SHEET SHALL BE 10'-6" FOR STAGE II CONSTRUCTION.
7. SEE SHEET 11 FOR SECTION B-B.

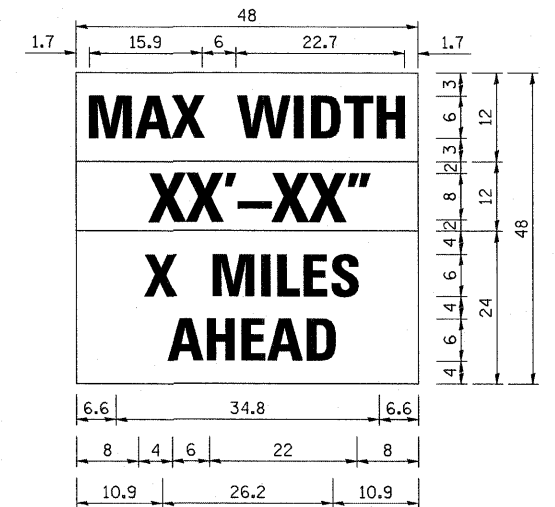
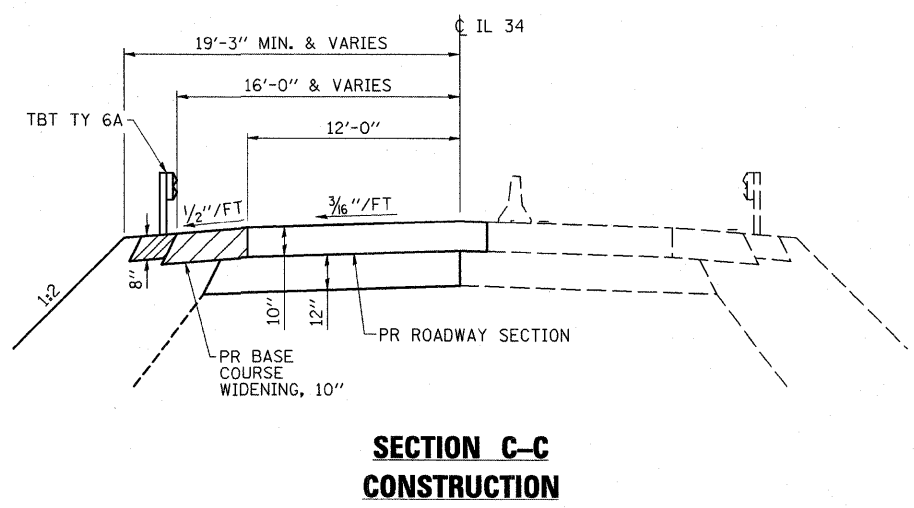
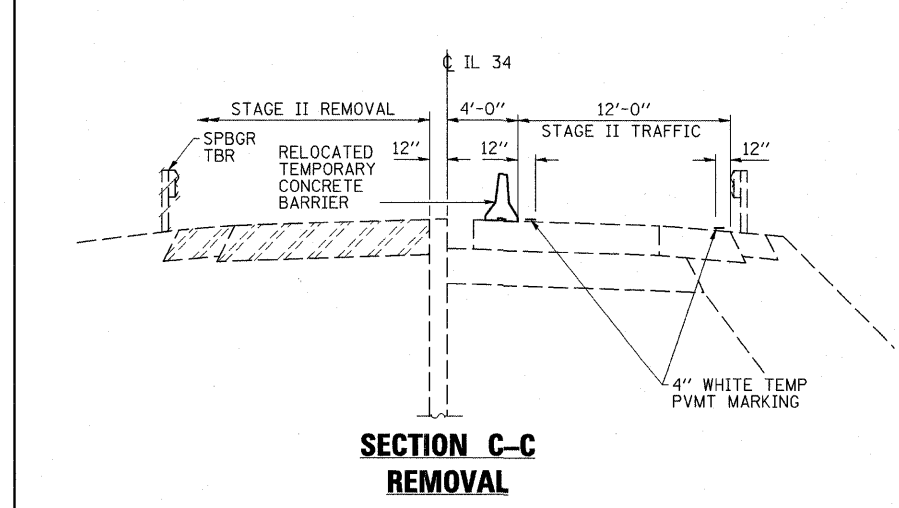
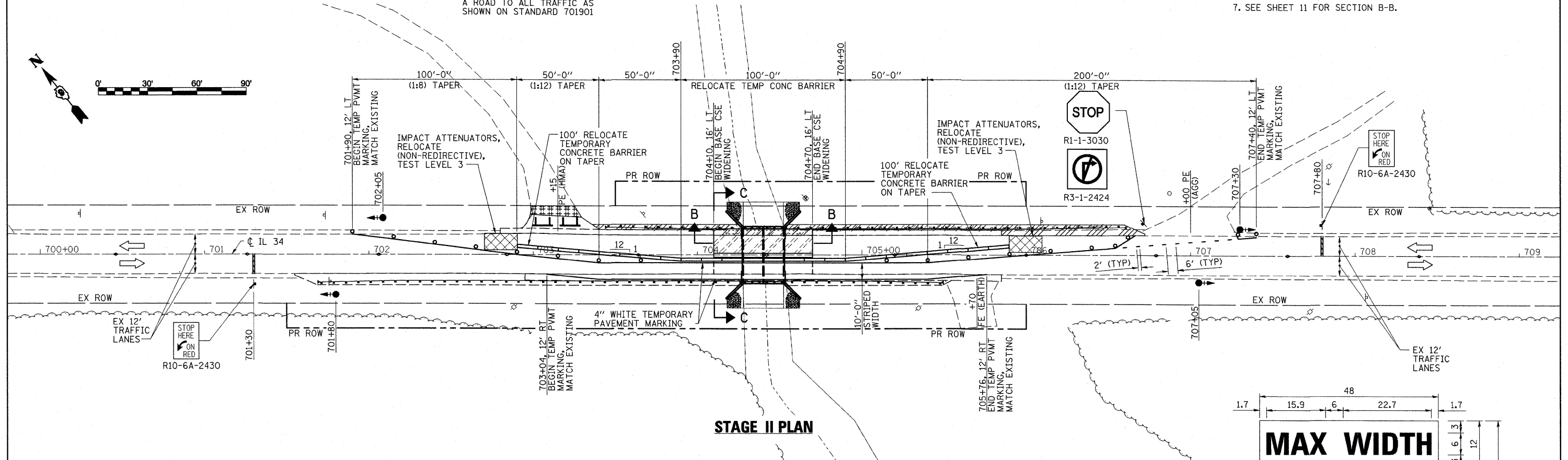

NOTE: THIS SIGN SHALL BE LOCATED AS DIRECTED BY THE ENGINEER. ONE SIGN SHALL BE PROVIDED FOR EACH APPROACH TO THE SITE.

**W12-1103**

W12-1103 (Width Is 8D);  
 No border, Black on White;  
 "MAX WIDTH" D;  
 No border, Black on Orange;  
 "XX'-XX'" D;  
 No border, Black on White;  
 "X MILES" D; "AHEAD" D

FILE NAME = D998854-sht-staging02.dgn	USER NAME = HAS	DESIGNED - DAJ	REVISED -	<b>STATE OF ILLINOIS DEPARTMENT OF TRANSPORTATION</b>	<b>STAGE CONSTRUCTION PLAN AND DETAILS STRUCTURE NO. 076-2006</b>	F.A.P. RTE. 778	SECTION 3B-1	COUNTY POPE	TOTAL SHEETS 50	SHEET NO. 12	
PLOT SCALE = 0.8833' / IN.	CHECKED - MTD	REVISED -	SCALE: 1"=30'-0"			SHEET NO. 4 OF 4 SHEETS	STA. 700+00 TO STA. 709+00	FED. ROAD DIST. NO. [ILLINOIS] FED. AID PROJECT		CONTRACT NO. 98854	
PLOT DATE = 12/27/2010 9:57:24 AM	DATE - 12/10	REVISED -									