

RTE	SECTION	COUNTY	TOTAL SHEETS	SHEET NO
344	(46-15&47)WRS-2	LAKE	234	31
STA. 343+59.42 TO STA. 1119+50		ILLINOIS FED. AID PROJECT		
CONTRACT NO. 60956				

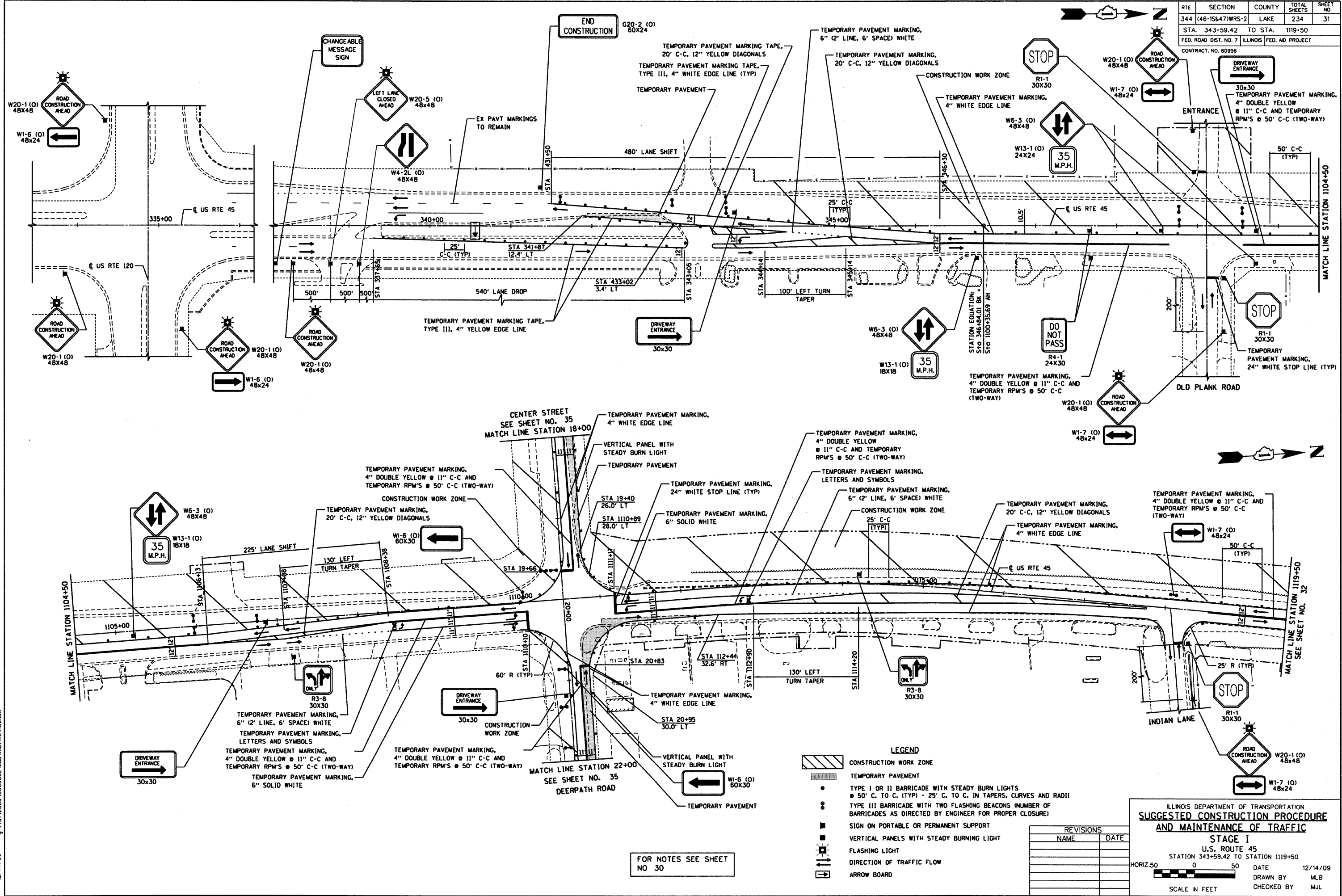

FOR NOTES SEE SHEET NO 30

**LEGEND**

- CONSTRUCTION WORK ZONE
- TEMPORARY PAVEMENT
- TYPE I OR II BARRICADE WITH STEADY BURN LIGHTS @ 50' C. TO C. (TYP) - 25' C. TO C. IN TAPERS, CURVES AND RADII
- TYPE III BARRICADE WITH TWO FLASHING BEACONS (NUMBER OF BARRICADES AS DIRECTED BY ENGINEER FOR PROPER CLOSURE)
- SIGN ON PORTABLE OR PERMANENT SUPPORT
- VERTICAL PANELS WITH STEADY BURNING LIGHT
- FLASHING LIGHT
- DIRECTION OF TRAFFIC FLOW
- ARROW BOARD

REVISIONS	
NAME	DATE

ILLINOIS DEPARTMENT OF TRANSPORTATION  
**SUGGESTED CONSTRUCTION PROCEDURE AND MAINTENANCE OF TRAFFIC**  
**STAGE I**  
 U.S. ROUTE 45  
 STATION 343+59.42 TO STATION 1119+50

DATE 12/14/09  
 DRAWN BY MLB  
 CHECKED BY MJL

HORIZ. 50 0 50  
 SCALE IN FEET

Tran Systems

12/14/09 - g:\401\2000\0005302\road\mol\34100.sht