

RTE	SECTION	COUNTY	TOTAL SHEETS	SHEET NO
344	(46-15&47)WRS-2	LAKE	234	33
STA.	1142+50	TO STA.	1165+50	
FED. ROAD DIST. NO. 7 ILLINOIS FED. AD PROJECT				
CONTRACT NO. 60956				

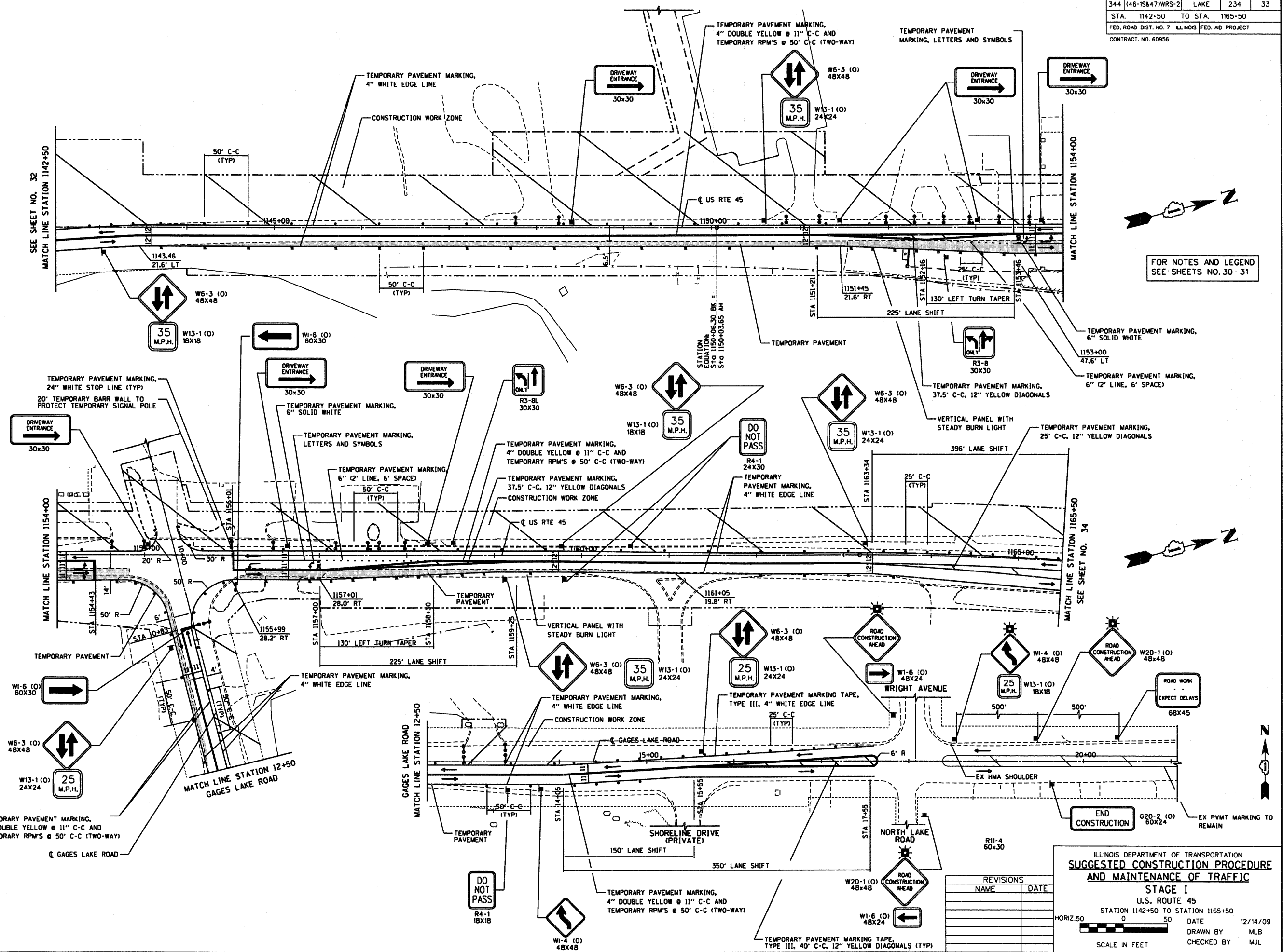

FOR NOTES AND LEGEND
SEE SHEETS NO. 30 - 31



12/14/09 - g:\401\2000\0005302\road\mot\114250.sht

REVISIONS	
NAME	DATE

ILLINOIS DEPARTMENT OF TRANSPORTATION
**SUGGESTED CONSTRUCTION PROCEDURE
AND MAINTENANCE OF TRAFFIC**

STAGE I
U.S. ROUTE 45
STATION 1142+50 TO STATION 1165+50

HORIZ. 50 0 50 DATE 12/14/09
SCALE IN FEET DRAWN BY MLB
CHECKED BY MJL