

RTE	SECTION	COUNTY	TOTAL SHEETS	SHEET NO
344	(46-1S&47)WRS-2	LAKE	234	37
STA.	1119+50	TO STA.	1142+50	
FED. ROAD DIST. NO. 7		ILLINOIS		FED. AID PROJECT
CONTRACT NO. 60956				

NOTE:  
 WIDENING AND RESURFACING OF THE SOUTHERN HALF OF BRAE LOCH ROAD FROM STATION 8+22 TO 15+97 SHALL BE CONSTRUCTED DURING STAGE II ACCORDING TO STANDARD 701501 FOR DAYTIME LANE CLOSURES. TRAFFIC IN BOTH DIRECTIONS MUST BE MAINTAINED DURING NON-WORKING HOURS.

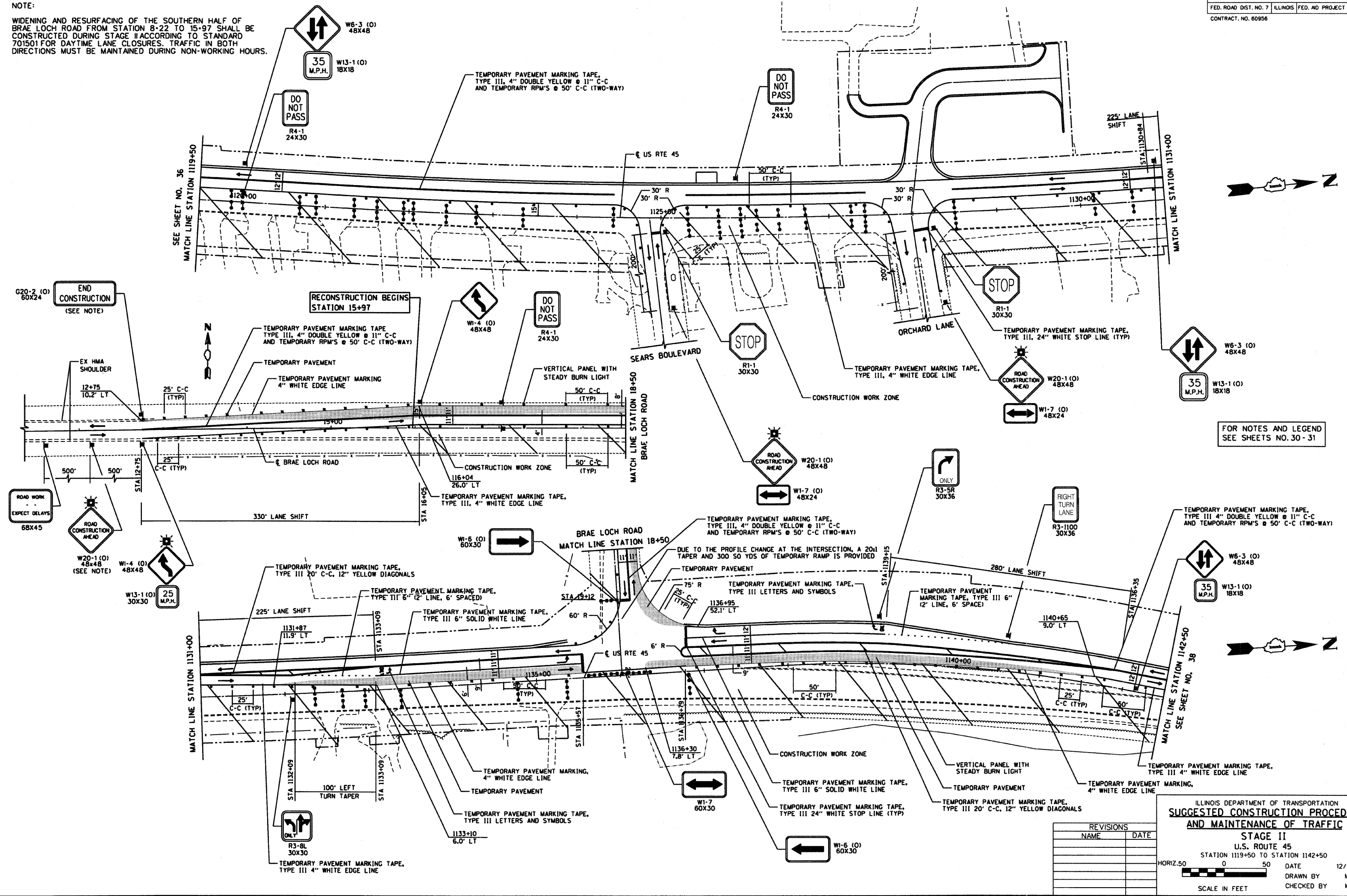

FOR NOTES AND LEGEND SEE SHEETS NO. 30 - 31

ILLINOIS DEPARTMENT OF TRANSPORTATION  
**SUGGESTED CONSTRUCTION PROCEDURE AND MAINTENANCE OF TRAFFIC**  
 STAGE II  
 U.S. ROUTE 45  
 STATION 1119+50 TO STATION 1142+50

REVISIONS	
NAME	DATE

HORIZ. 50 0 50 DATE 12/14/09  
 SCALE IN FEET DRAWN BY MLB CHECKED BY MJL



12/14/09 - g:\401\2000\0005302\cod\M012\_11950.SHT