

RTE	SECTION	COUNTY	TOTAL SHEETS	SHEET NO
344	(46-15&47)WRS-2	LAKE	234	38
STA.	1142+50	TO STA.	1165+50	
FED. ROAD DIST. NO. 7	ILLINOIS		FED. AID PROJECT	
CONTRACT NO. 60956				

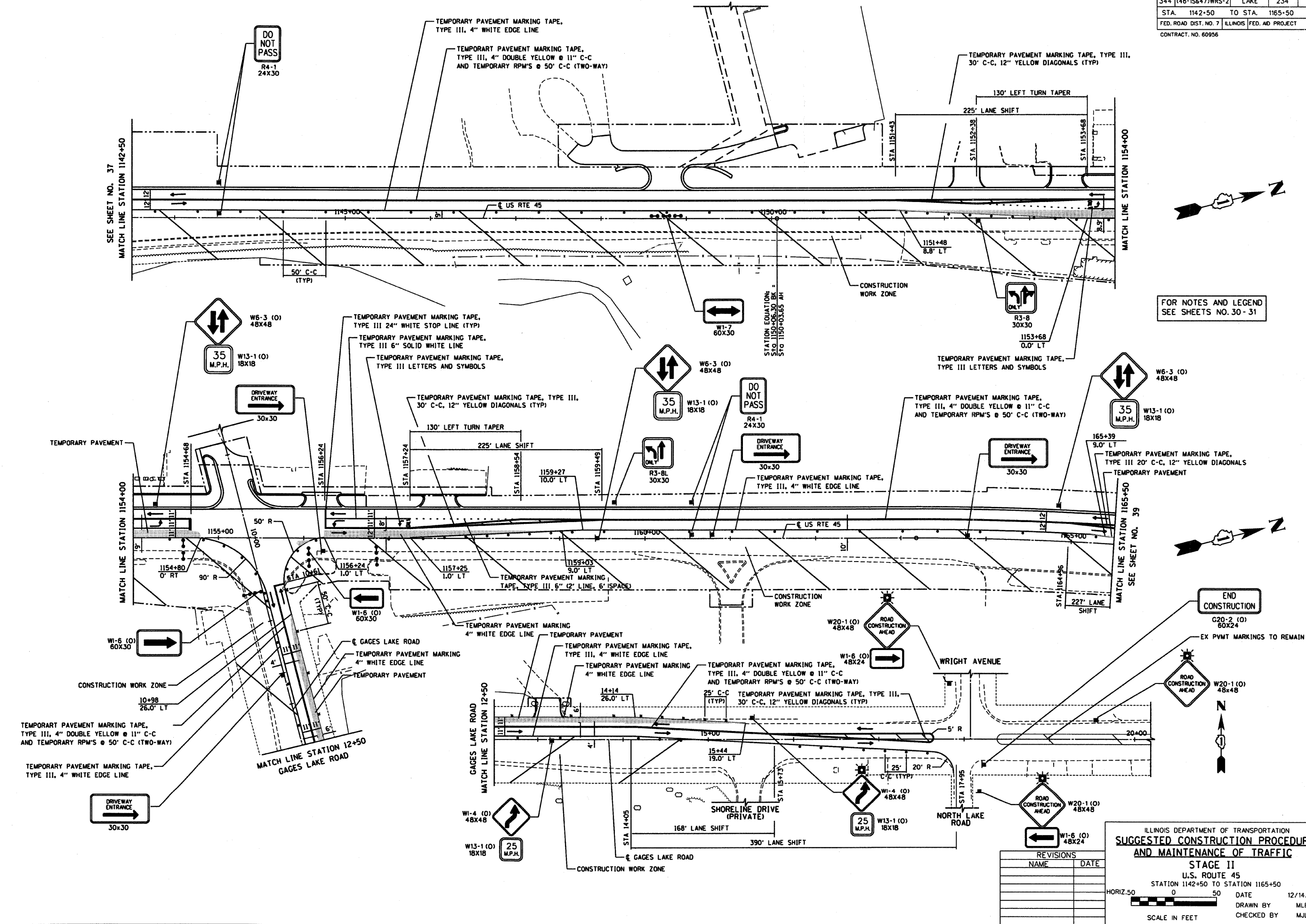

12/14/09 - g:\1401\2000\0005302\cadd\mol2_114250.sht



FOR NOTES AND LEGEND SEE SHEETS NO. 30-31

ILLINOIS DEPARTMENT OF TRANSPORTATION
SUGGESTED CONSTRUCTION PROCEDURE AND MAINTENANCE OF TRAFFIC
STAGE II
U.S. ROUTE 45
 STATION 1142+50 TO STATION 1165+50

REVISIONS	
NAME	DATE

HORIZ. 50 0 50 DATE 12/14/09
 SCALE IN FEET DRAWN BY MLB CHECKED BY MJL