

RTE	SECTION	COUNTY	TOTAL SHEETS	SHEET NO
344	(46-1S&47)WRS-2	LAKE	234	49
STA.	1142+50	TO STA.	1165+50	
FED. ROAD DIST. NO. 7	ILLINOIS	FED. AID PROJECT		
CONTRACT NO. 60956				

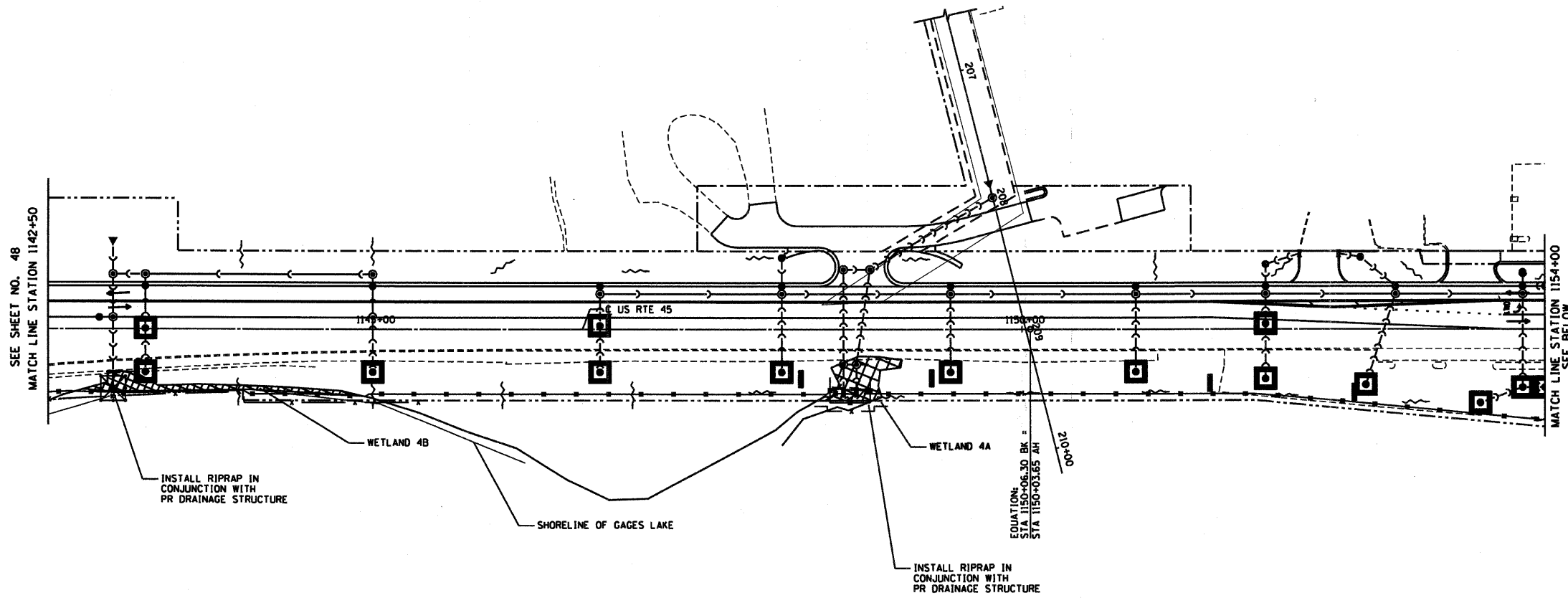

FOR LEGEND AND NOTES  
SEE SHEET NO. 41

ESTIMATED QUANTITIES FOR THIS SHEET

TEMPORARY DITCH CHECKS	7
INLET FILTERS	31
PERIMETER EROSION BARRIER	2734'
TEMPORARY FENCE	358'
PATCHING	0 SY

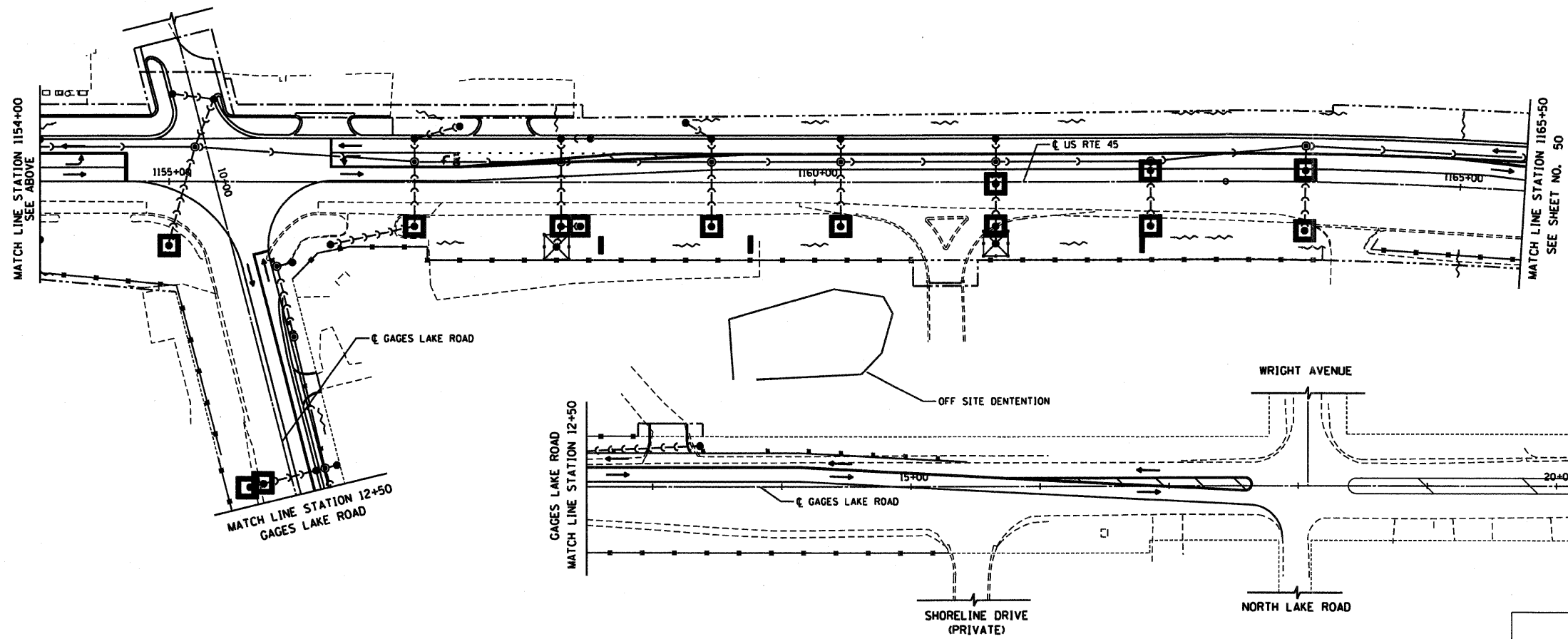

REVISIONS	
NAME	DATE

ILLINOIS DEPARTMENT OF TRANSPORTATION  
**EROSION CONTROL PLAN**  
**STAGE II**  
U.S. ROUTE 45  
STATION 1142+50 TO STATION 1165+50

HORIZ. 50 0 50 DATE 12/14/09  
DRAWN BY SAH  
CHECKED BY M.J.L.

SCALE IN FEET