

RTE	SECTION	COUNTY	TOTAL SHEETS	SHEET NO
344	(46-1S&47)WRS-2	LAKE	234	95
STA.		TO STA.		
FED. ROAD DIST. NO. 7		ILLINOIS	FED. NO	PROJECT
CONTRACT NO. 60956				

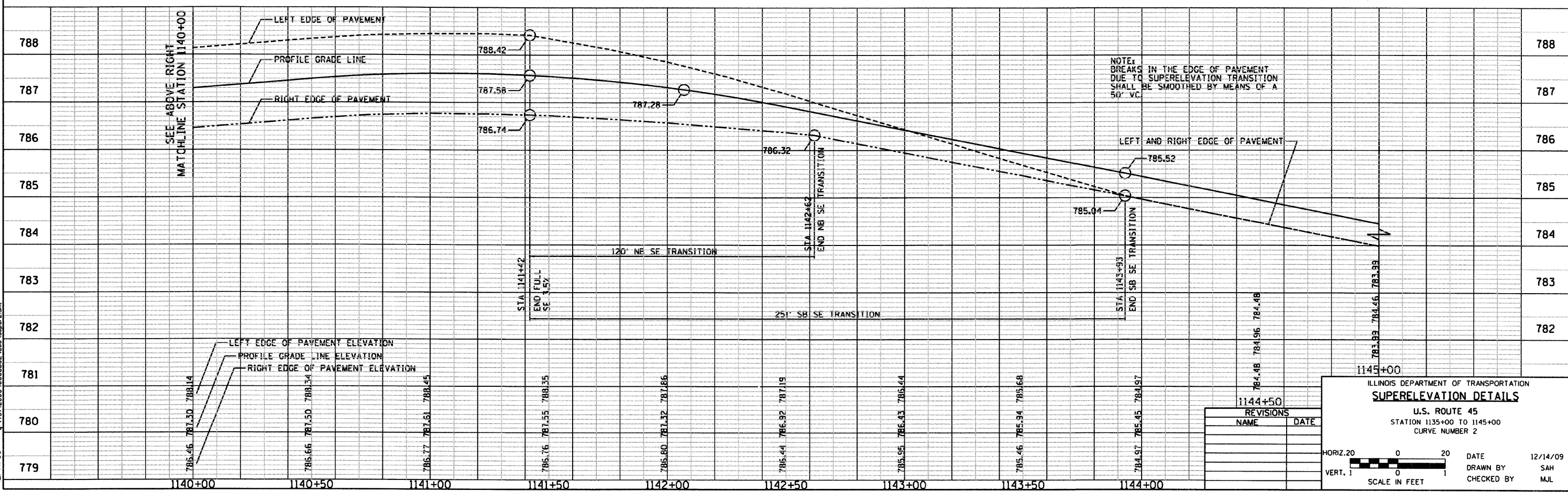
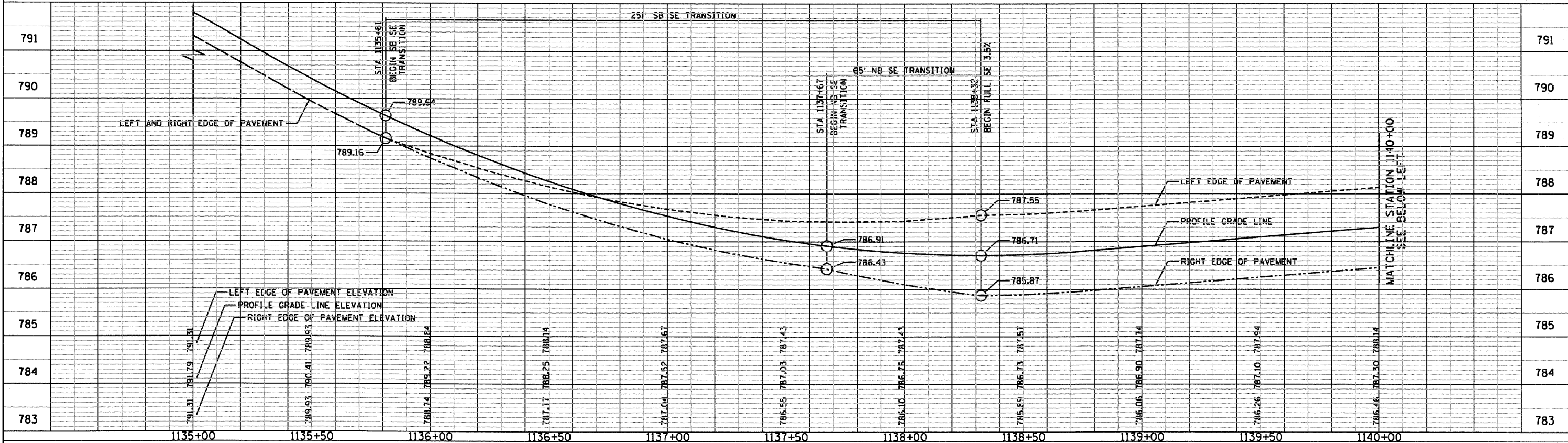

NOTE:  
BREAKS IN THE EDGE OF PAVEMENT  
DUE TO SUPERELEVATION TRANSITION  
SHALL BE SMOOTHED BY MEANS OF A  
50' VC.

REVISIONS	
NAME	DATE

ILLINOIS DEPARTMENT OF TRANSPORTATION  
**SUPERELEVATION DETAILS**  
U.S. ROUTE 45  
STATION 1135+00 TO 1145+00  
CURVE NUMBER 2

HORIZ. 20 0 20  
VERT. 1 0 1  
SCALE IN FEET

DATE 12/14/09  
DRAWN BY SAH  
CHECKED BY MJL



12/14/09 - g:\401\2000\0005302\cut\super2.dwt