

LAKE COUNTY FOREST PRESERVE DISTRICT

US ROUTE 45
 PROPOSED CURVE #12
 PI STA. = 1113+95.46
 $\Delta = 9^{\circ}24'24.90''$
 $D = 3^{\circ}00'00.00''$
 $R = 1,909.86'$
 $T = 157.14'$
 $L = 313.56'$
 $E = 6.45'$
 $SE = 0.033\%$
 PC STA. = 1112+38.32
 PT STA. = 1115+51.88

US ROUTE 45
 PROPOSED CURVE #13
 PI STA. = 1127+20.71
 $\Delta = 9^{\circ}14'28.75''$
 $D = 0^{\circ}45'00.00''$
 $R = 7,639.44'$
 $T = 617.43'$
 $L = 1232.18'$
 $E = 24.91'$
 $SE = 0.020\%$
 PC STA. = 1121+03.28
 PT STA. = 1133+35.46

RTE	SECTION	COUNTY	TOTAL SHEETS	SHEET NO
344	146-158471WRS-2	LAKE	234	120
STA.	TO STA.			
FED. ROAD DIST. NO. 7	ILLINOIS	FED. AID PROJECT		

CONTRACT NO. 60956

FOR INFORMATION ONLY

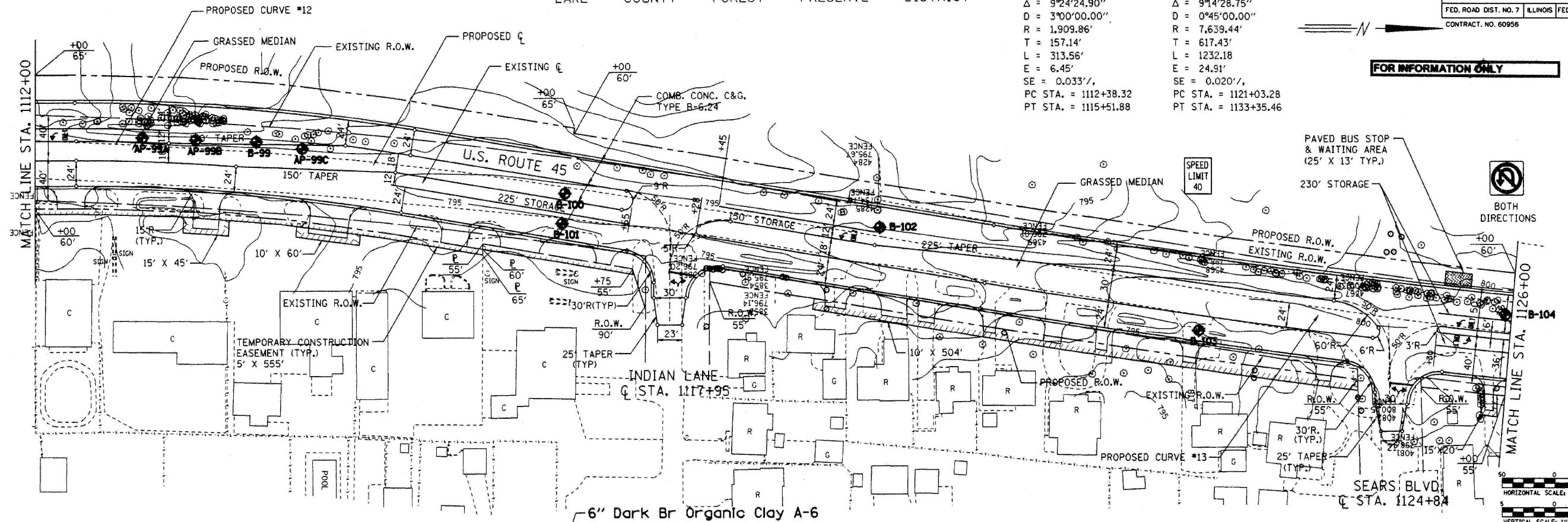

DATE	BY

PLAN
 SURVEYED
 GRADES CHECKED
 ALIGNMENT CHECKED
 R.O.W. CHECKED
 ROAD FILE NAME
 NO.

DATE	BY

PROFILE
 SURVEYED
 GRADES CHECKED
 STRUCTURE NOTATIONS CHECKED
 NO.

