

RTE	SECTION	COUNTY	TOTAL SHEETS	SHEET NO
344	(46-1S&47)WRS-2	LAKE	234	150
STA.		TO STA.		
FED. ROAD DIST. NO. 7		ILLINOIS	FED. AID PROJECT	
CONTRACT NO. 60956				

**TRAFFIC SIGNAL LEGEND**

	PROPOSED	EXISTING
CONTROLLER		
SERVICE INSTALLATION		
SIGNAL HEAD		
SIGNAL HEAD WITH BACKPLATE		
SIGNAL HEAD, PEDESTRIAN		
SIGNAL POST		
MAST ARM ASSEMBLY AND POLE, STEEL		
COMMON TRENCH		
UNIT DUCT		
HANDHOLE		
HEAVY DUTY HANDHOLE		
DOUBLE HANDHOLE		
G.S. CONDUIT IN TRENCH OR PUSHED		
DETECTOR LOOP		
EMERGENCY VEHICLE SYSTEM DETECTOR		
CONFIRMATION BEACON		
CONDUIT SPLICE		
UNINTERRUPTIBLE POWER SUPPLY		
RELOCATED		
PREFORMED LOOP		

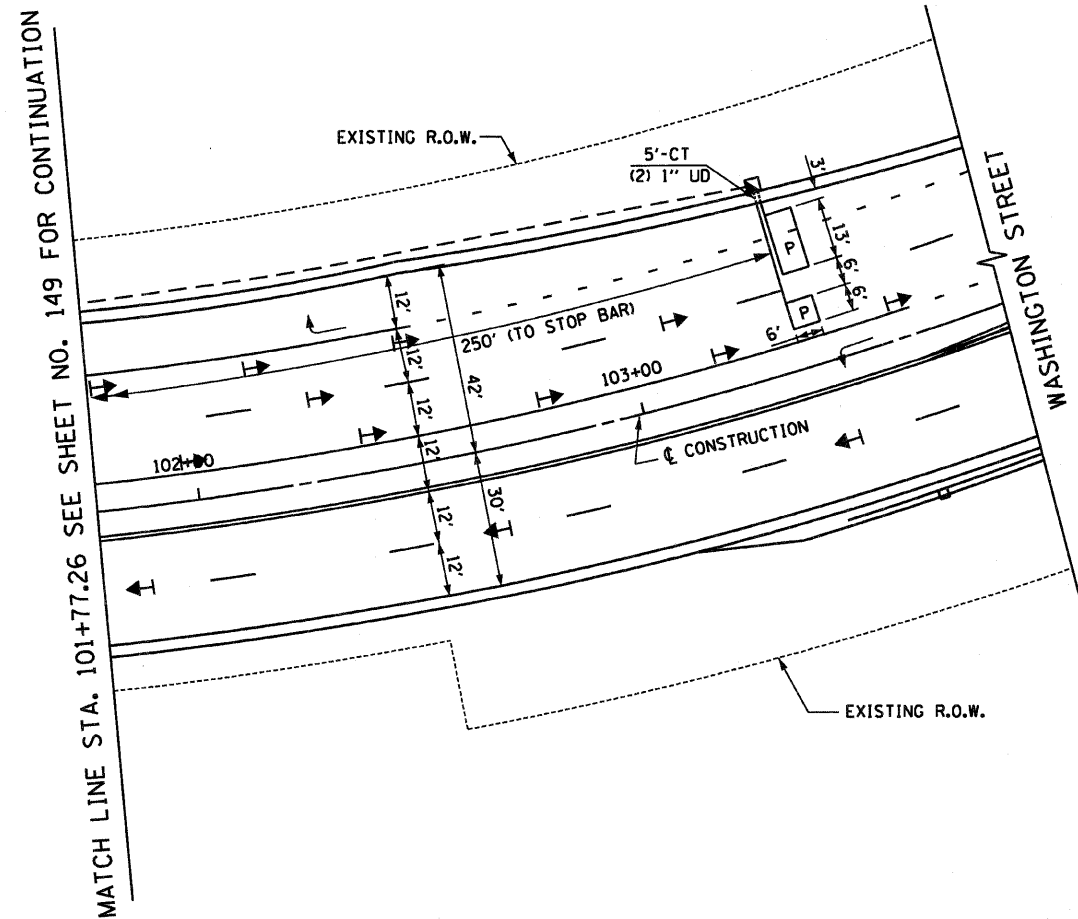
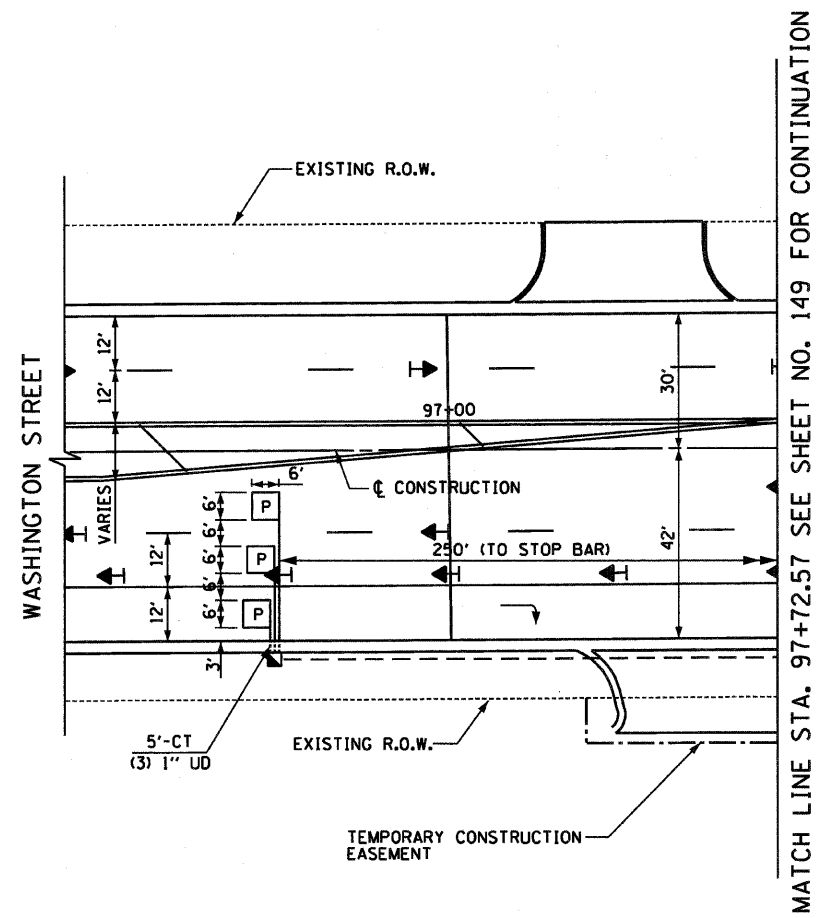

REVISIONS	
NAME	DATE

ILLINOIS DEPARTMENT OF TRANSPORTATION

**TRAFFIC SIGNAL INSTALLATION**

U.S. ROUTE 45 & WASHINGTON STREET

HORIZ. 20 0 20

SCALE IN FEET

DATE 12/14/09

DRAWN BY MB/AJP

CHECKED BY KMM



12/14/09 - p:\401\2000\0005302\scd\sheet1\signal12\_106.sht