

RTE	SECTION	COUNTY	TOTAL SHEETS	SHEET NO
344	(46-1S&47)WRS-2	LAKE	234	154
STA.		TO STA.		
FED. ROAD DIST. NO. 7		ILLINOIS FED. AID PROJECT		
CONTRACT NO. 60956				

THE TRAFFIC SIGNAL CONTROL EQUIPMENT FOR THIS PROJECT SHALL BE "EAGLE" TO MATCH THE EXISTING ADJACENT SYSTEM.

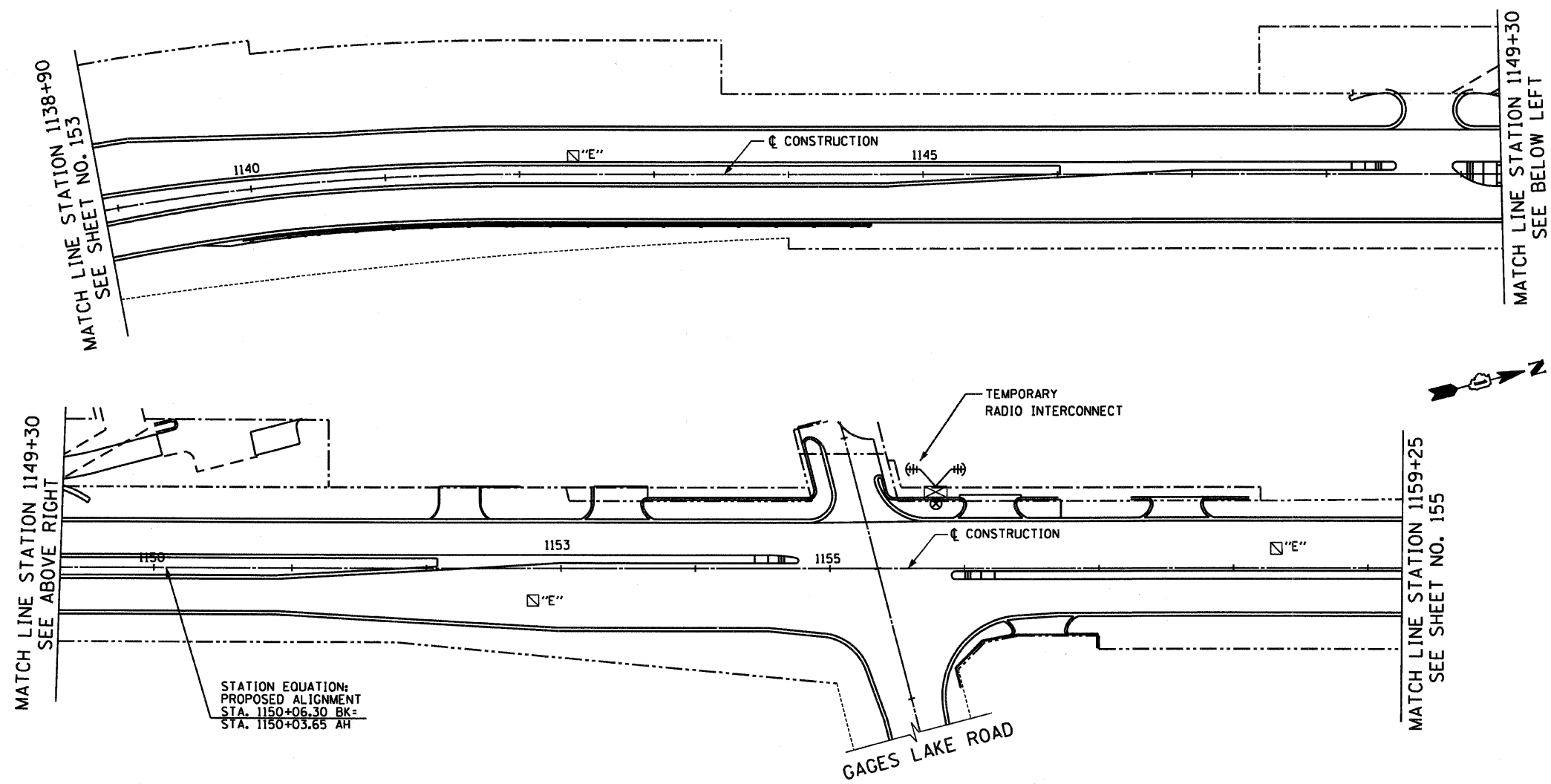

INTERCONNECT PLAN LEGEND

	PROPOSED	EXISTING
CONTROLLER	[Symbol]	[Symbol]
HANDHOLE	[Symbol]	[Symbol]
HEAVY DUTY HANDHOLE	[Symbol]	[Symbol]
DOUBLE HANDHOLE	[Symbol]	[Symbol]
G.S. CONDUIT IN TRENCH OR PUSHED	[Symbol]	[Symbol]
DETECTOR LOOP	[Symbol]	[Symbol]
COMMON TRENCH	CT	
UNIT DUCT	UD	
SYSTEM	S	
INTERSECTION	IP	
WOOD POLE	[Symbol]	[Symbol]
EXISTING HANDHOLE TO BE REMOVED	[Symbol]	[Symbol]
RADIO INTERCONNECT ANTENNA	[Symbol]	[Symbol]

REVISIONS	
NAME	DATE

ILLINOIS DEPARTMENT OF TRANSPORTATION
TEMPORARY TRAFFIC SIGNAL SYSTEM INTERCONNECT PLAN
 U.S. ROUTE 45
 STATION 1138+90 TO STATION 1159+25
 HORIZ. 50 0 50
 SCALE IN FEET
 DATE 12/14/09
 DRAWN BY MB/AJP
 CHECKED BY KMM



12/14/09 - g:\401\2000\0005\302\road\SHM\1\interconnect2_110.dwg