

RTE	SECTION	COUNTY	TOTAL SHEETS	SHEET NO
344	(46-1S&47)WRS-2	LAKE	234	158
STA.	TO STA.			
FED. ROAD DIST. NO. 7		ILLINOIS		FED. AID PROJECT
CONTRACT NO. 60956				

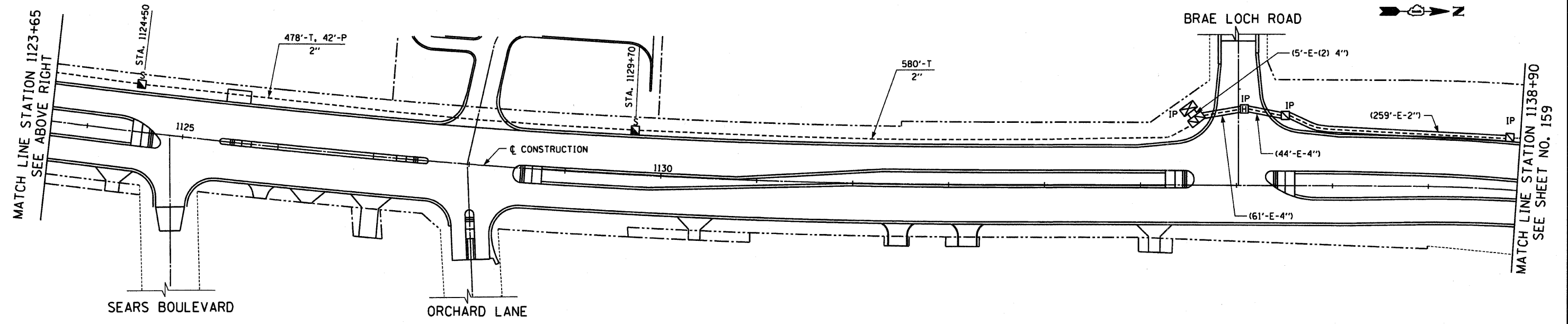
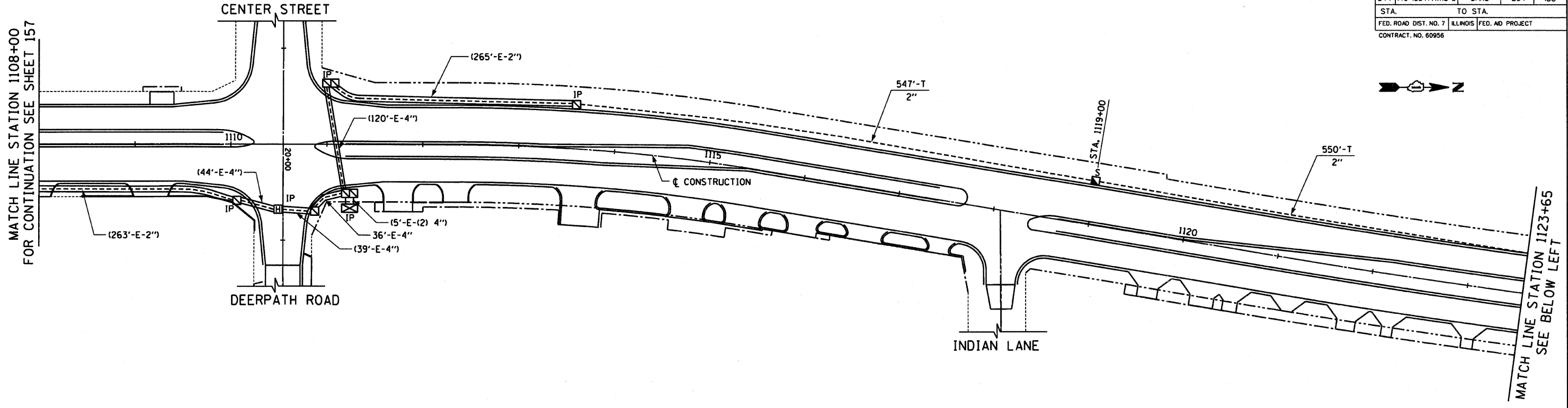

**INTERCONNECT PLAN LEGEND**

	PROPOSED	EXISTING
CONTROLLER		
HANDHOLE		
HEAVY DUTY HANDHOLE		
DOUBLE HANDHOLE		
G.S. CONDUIT IN TRENCH OR PUSHED		
DETECTOR LOOP		
COMMON TRENCH	CT	
UNIT DUCT	UD	
SYSTEM	S	
INTERSECTION	IP	I
WOOD POLE		
EXISTING HANDHOLE TO BE REMOVED		

**NOTES:**

1. QUANTITIES FOR ITEMS INSTALLED FOR TRAFFIC SIGNALS AT INTERSECTIONS, SUCH AS CONTROLLERS, AND SIGNAL HEADS, ARE INCLUDED ON THE APPROPRIATE TRAFFIC SIGNAL CABLE PLAN.
2. THE CONTRACTOR SHALL PLACE THE INTERCONNECTION SYSTEM HANDHOLES AND CONDUIT AS CLOSE TO THE RIGHT-OF-WAY LINES AS POSSIBLE OR, AS DIRECTED BY THE ENGINEER.

REVISIONS	
NAME	DATE

ILLINOIS DEPARTMENT OF TRANSPORTATION

**INTERCONNECT PLAN**

U.S. ROUTE 45  
STATION 1108+00 TO STATION 1138+90

HORIZ. 50 0 50  
SCALE IN FEET

DATE 12/14/09  
DRAWN BY MB/AJP  
CHECKED BY KMM



12/14/09 g:\401\2000\0005\302\cadd\SHAF\interconnect\_113.sht