

RTE	SECTION	COUNTY	TOTAL SHEETS	SHEET NO
344	(46-1S&47)WRS-2	LAKE	234	159
STA.	TO STA.			
FED. ROAD DIST. NO. 7		ILLINOIS	FED. AID PROJECT	
CONTRACT NO. 60956				

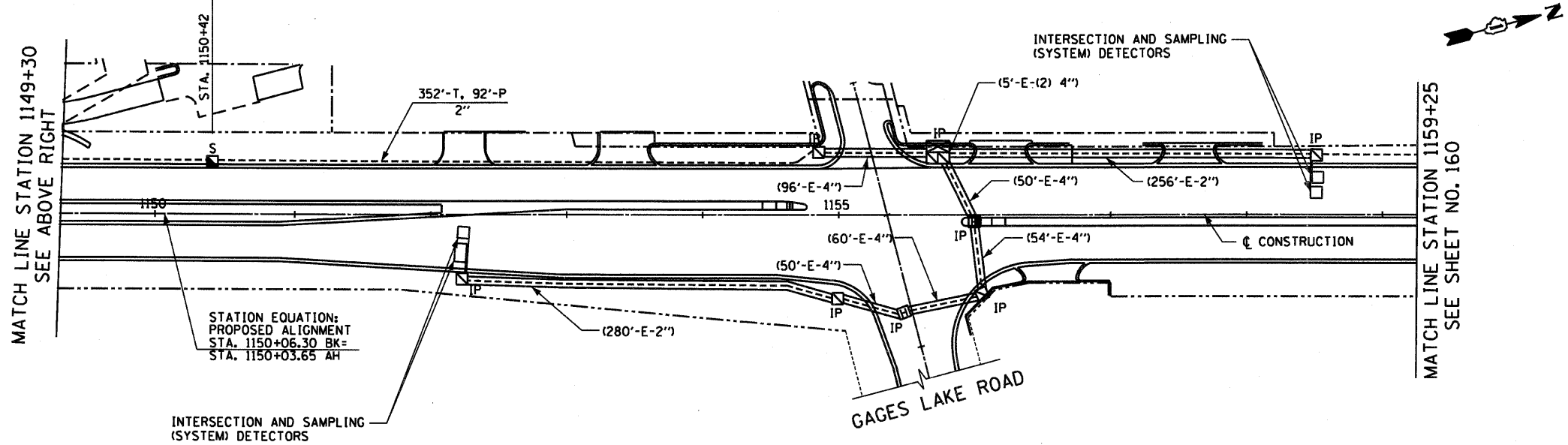
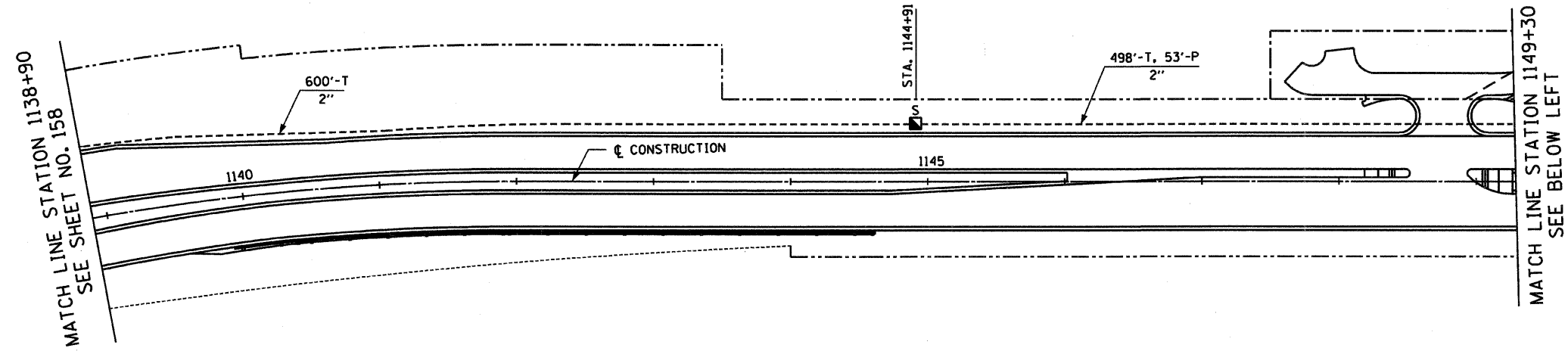

STATION EQUATION:
 PROPOSED ALIGNMENT
 STA. 1150+06.30 BK=
 STA. 1150+03.65 AH

INTERCONNECT PLAN LEGEND

CONTROLLER	PROPOSED	EXISTING
HANDHOLE		
HEAVY DUTY HANDHOLE		
DOUBLE HANDHOLE		
G.S. CONDUIT IN TRENCH OR PUSHED		
DETECTOR LOOP		
COMMON TRENCH	CT	
UNIT DUCT	UD	
SYSTEM	S	
INTERSECTION	IP	I
WOOD POLE		
EXISTING HANDHOLE TO BE REMOVED		

NOTES:

- QUANTITIES FOR ITEMS INSTALLED FOR TRAFFIC SIGNALS AT INTERSECTIONS, SUCH AS CONTROLLERS, AND SIGNAL HEADS, ARE INCLUDED ON THE APPROPRIATE TRAFFIC SIGNAL CABLE PLAN.
- THE CONTRACTOR SHALL PLACE THE INTERCONNECTION SYSTEM HANDHOLES AND CONDUIT AS CLOSE TO THE RIGHT-OF-WAY LINES AS POSSIBLE OR, AS DIRECTED BY THE ENGINEER.

REVISIONS	
NAME	DATE

ILLINOIS DEPARTMENT OF TRANSPORTATION

INTERCONNECT PLAN

U.S. ROUTE 45
 STATION 1138+90 TO STATION 1159+25

HORIZ. 50 0 50
 SCALE IN FEET

DATE 12/14/09
 DRAWN BY MB/AJP
 CHECKED BY KMM



12/14/09 g:\401\2000\0005\302\cadd\shon\interconnect2_114.sht