

QUANTITY
 4 (100) LINE = 64.1 ft. (19.7 m)
 21.1 sq. ft. (1.97 sq. m)

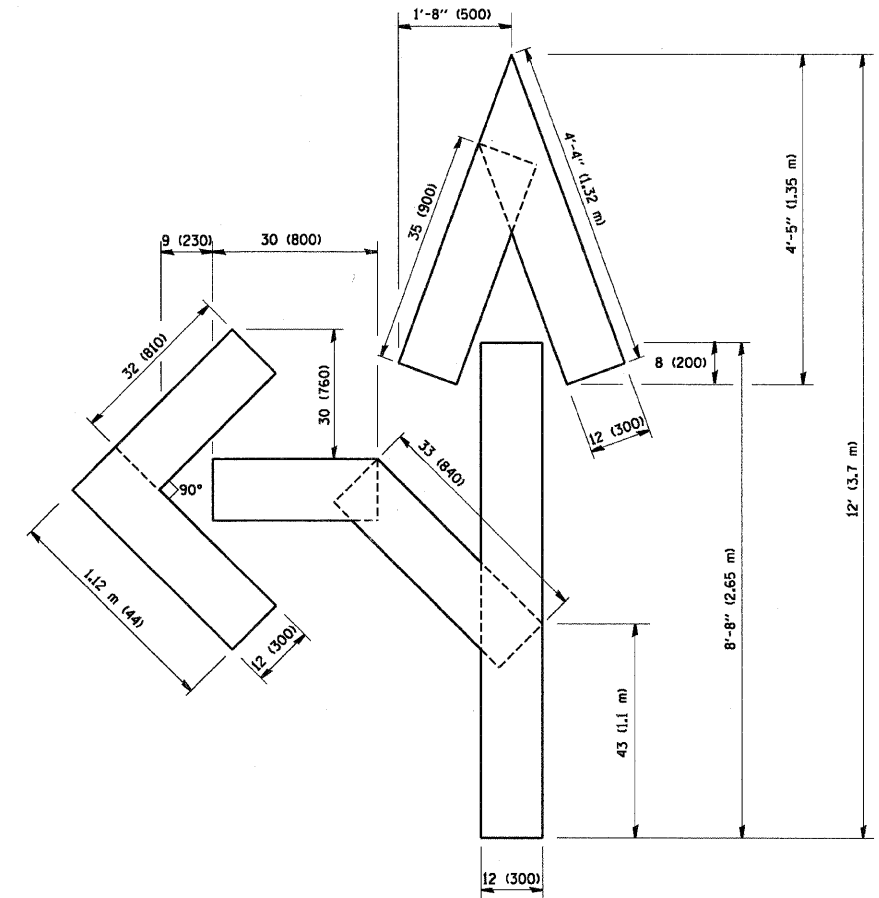

QUANTITY
 4 (100) LINE = 82.5 ft. (25.3 m)
 27.5 sq. ft. (2.53 sq. m)

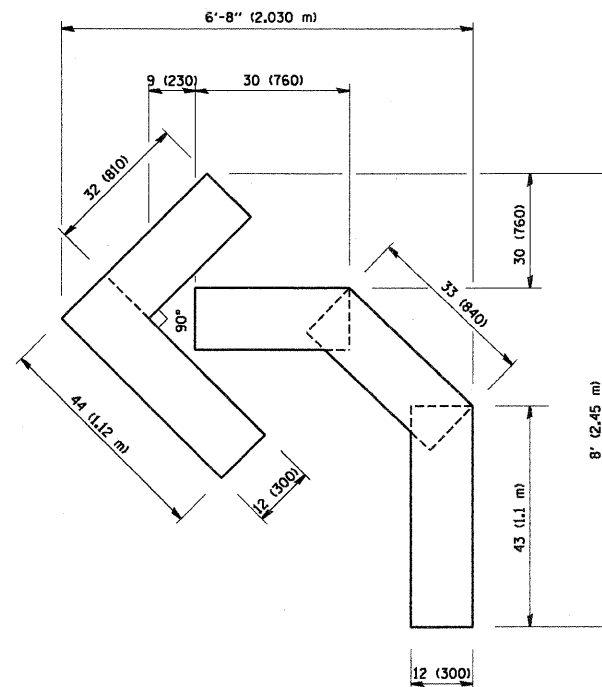

QUANTITY
 4 (100) LINE = 45.5 ft. (13.9 m)
 15.2 sq. ft. (1.39 sq. m)

All dimensions are in inches (millimeters) unless otherwise shown.

| | | | |
|--|-------------------------------|------------------------------|--|
| FILE NAME = W:\distatd\22x34\1c16.dgn | USER NAME = gaglianobt | DESIGNED - DRAWN - | REVISED -T. RAMMACHER 06-05-96 REVISED -T. RAMMACHER 11-04-97 |
| | PLOT SCALE = 50.0000' / 1" | CHECKED - DATE - 09-18-94 | REVISED -T. RAMMACHER 03-02-98 REVISED -E. GOMEZ 08-28-00 |

STATE OF ILLINOIS
 DEPARTMENT OF TRANSPORTATION

PAVEMENT MARKING LETTERS AND SYMBOLS
 FOR TRAFFIC STAGING

SCALE: NONE SHEET NO. 1 OF 1 SHEETS STA. TO STA.

| | | | | |
|---|----------------------------|----------------|---------------------|------------------|
| F.A. RTE. 344 | SECTION (46-1S&47)WRS-2 | COUNTY LAKE | TOTAL SHEETS 234 | SHEET NO. 185 |
| TC-16 | | | CONTRACT NO. 60956 | |
| FED. ROAD DIST. NO. 7 (ILLINOIS) FED. AID PROJECT | | | | |