

NOTE:  
STATIONS ARE GIVEN WITH RESPECT TO THE LEFT BASELINE

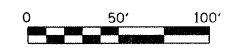
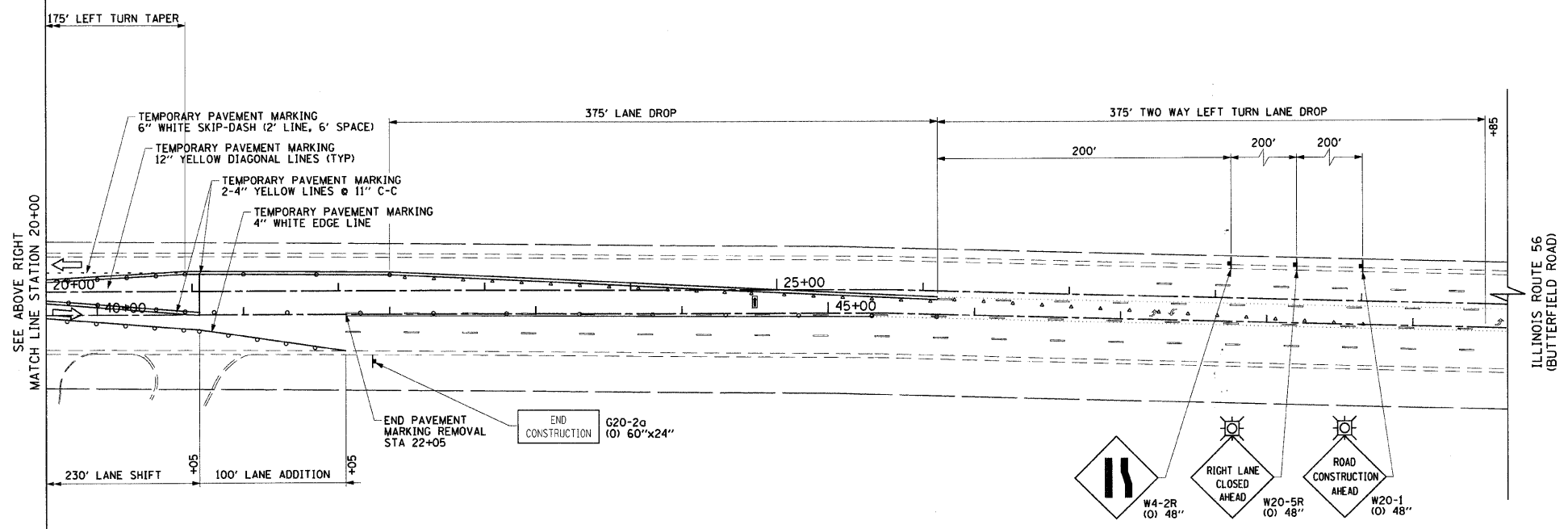

LEGEND	
	CONSTRUCTION WORK ZONE
	TEMPORARY PAVEMENT TO BE CONSTRUCTED PRIOR TO STAGE 1
	TEMPORARY PAVEMENT TO BE CONSTRUCTED PRIOR TO STAGE 2
	ARROW BOARD
	SIGN TO BE PLACED ON PERMANENT OR PORTABLE SUPPORT
	MONODIRECTIONAL FLASHING LIGHT
	DRUMS OR TYPE II BARRICADE WITH STEADY BURN LIGHT @ 50' C-C (TYP), 25' C-C IN CURVES AND RADII, AND 20' C-C IN TAPERS
	TYPE III BARRICADE
	VERTICAL PANELS WITH STEADY BURN LIGHT @ 50' C-C (TYP), 25' C-C IN CURVES AND RADII, AND 20' C-C IN TAPERS
	DIRECTION INDICATOR BARRICADES WITH STEADY BURN LIGHTS @ 20' C-C
	DIRECTION OF TRAFFIC FLOW
	DRIVEWAY ENTRANCE 30" X 30" SEE TC-26
	DRIVEWAY ENTRANCE 30" X 30" SEE TC-26
	R3-2 24" X 24"

FILE NAME =	USER NAME = BAW:torl	DESIGNED - TKH	REVISED -
g:\veh07\road\sheet\0160012-SHT-STAG-ING-BUTTERFIELD-1-B.dgn		DRAWN - BAW	REVISED -
PLDT SCALE = 50.0000' / IN.		CHECKED - JRH	REVISED -
PLDT DATE = 8/5/2009		DATE - 07/24/2009	REVISED -

**STATE OF ILLINOIS  
DEPARTMENT OF TRANSPORTATION**

**SUGGESTED CONSTRUCTION PROCEDURES AND  
MAINTENANCE OF TRAFFIC - ILLINOIS ROUTE 56 (BUTTERFIELD ROAD)  
STAGE 1B**

SCALE: 1"=50' SHEET NO. 69 OF 362 SHEETS STA. 12+00 TO STA. 25+50

F.A.U. RTE.	SECTION	COUNTY	TOTAL SHEETS	SHEET NO.
1453	55WRS	DuPAGE	362	69
FED. ROAD DIST. NO. 7 ILLINOIS FED. AID PROJECT				CONTRACT NO. 60D12