

- LEGEND**
- TEMPORARY DITCH CHECK, ROLLED EXCELSIOR SPACED 150' (TYP), UNLESS NOTED OTHERWISE ON THE PLANS (SEE STD 280001)
 - SEDIMENT CONTROL, SILT FENCE (SEE STD 280001)
 - INLET AND PIPE PROTECTION (SEE STANDARD 280001)
 - TEMPORARY FENCE
 - CONSTRUCTION WORK ZONE
 - TEMPORARY PAVEMENT
 - FLOWLINE FOR PROPOSED DITCH
 - FLOWLINE OF EXISTING DITCH
 - TREE REMOVED
 - TREE PRUNED

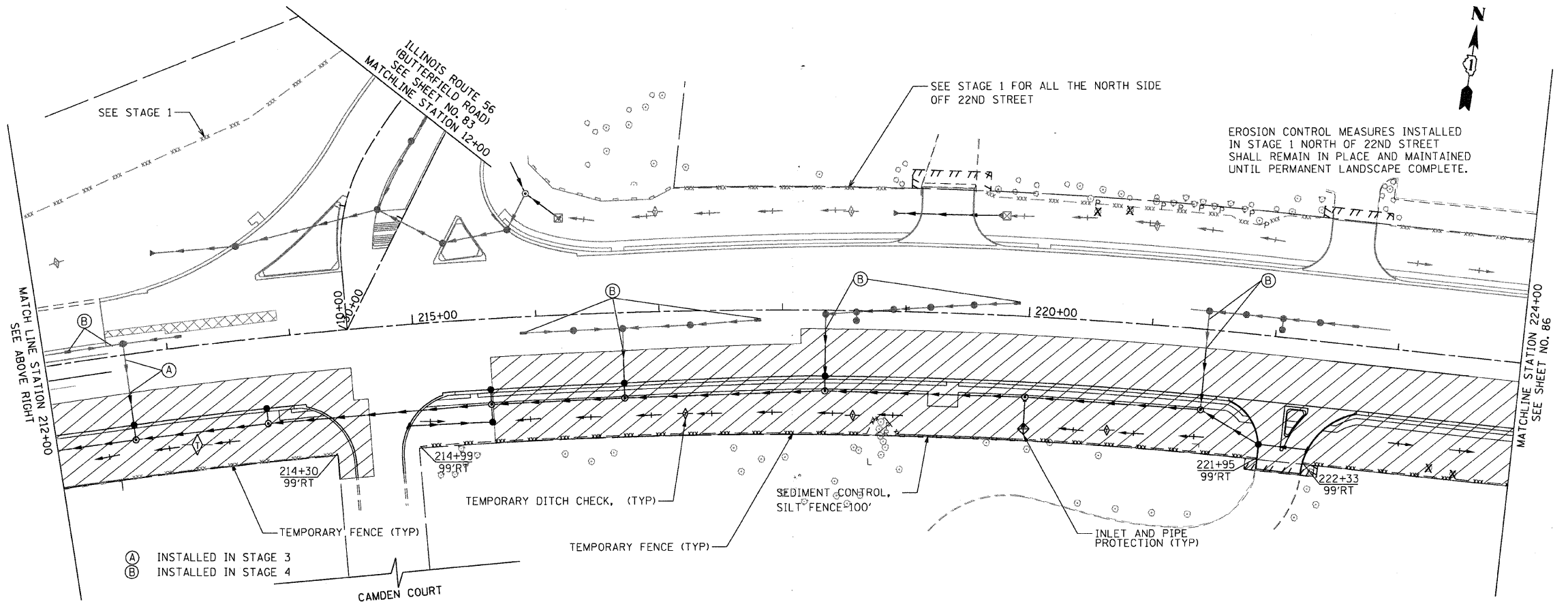
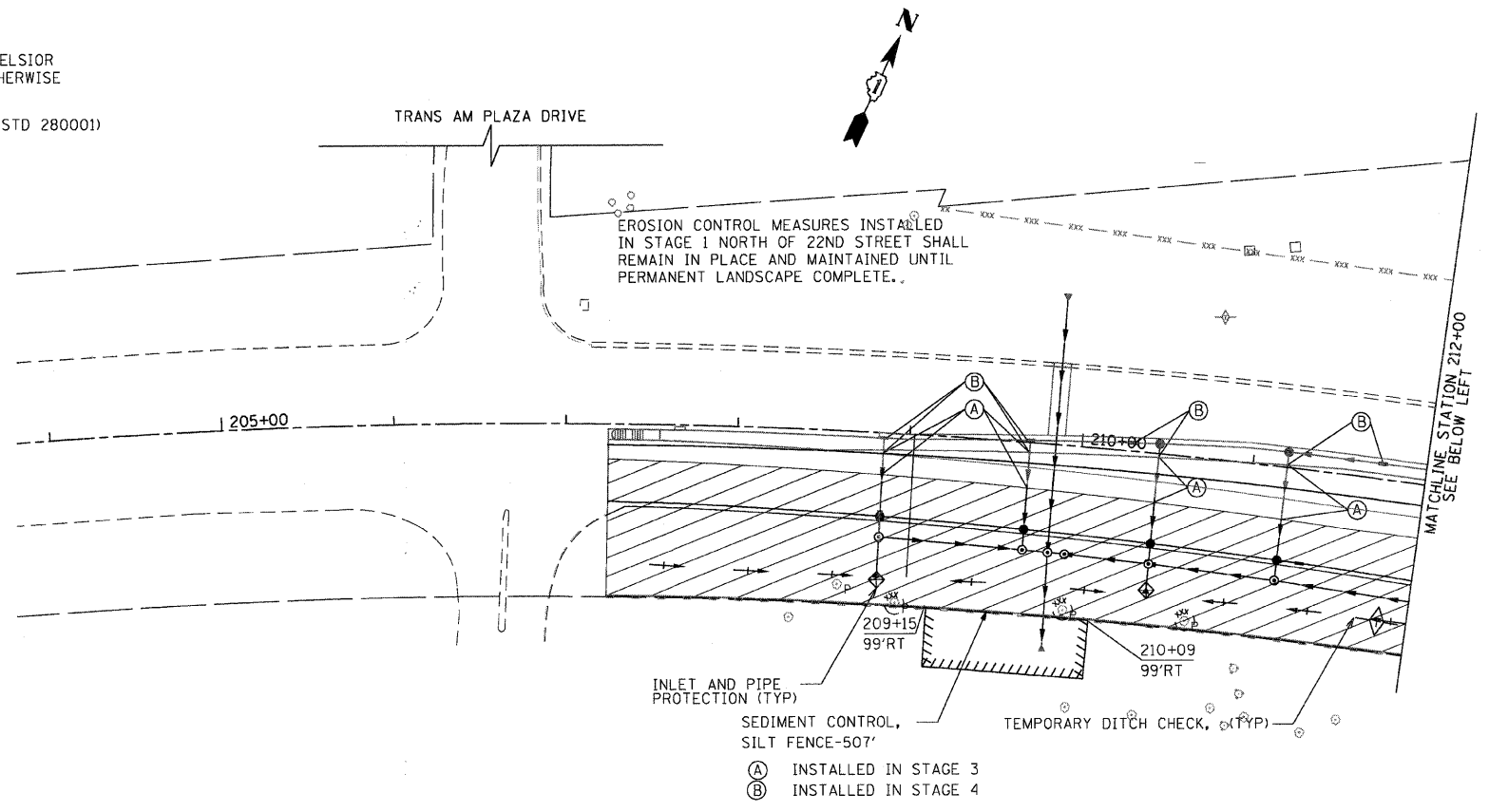

FILE NAME: E:\2007\m07081.22nd.st.erosion\cadd\Sheet\16012-SHT-EROS201.dgn
 PLOT SCALE: 1/4"=50'
 USER NAME: Millennium Engineering

MILLENNIA ENGINEERING

200 22ND Street, Suite 216, Lombard, IL 60148
 630.705.0110 voice, 630.839.2566 fax
 www.millenniaeng.com

DESIGNED - TVN	REVISED -
DRAWN - TVN	REVISED -
CHECKED - RPD	REVISED -
DATE - 7/24/2009	REVISED -

**STATE OF ILLINOIS
DEPARTMENT OF TRANSPORTATION**

**22nd STREET EROSION CONTROL PLAN
STAGE II**

SCALE: 1"=50' SHEET NO. 85 OF 362 SHEETS STA. 200+00 TO STA. 224+00

F.A.U. RTE.	SECTION	COUNTY	TOTAL SHEETS	SHEET NO.
1453	55WRS	DUPAGE	362	85
FED. ROAD DIST. NO. 7 ILLINOIS FED. AID PROJECT			CONTRACT NO. 60D12	

ER201

pr\2007\m07081.22nd.st.erosion\cadd\Sheet\16012-SHT-EROS201.dgn