

STAGE 1

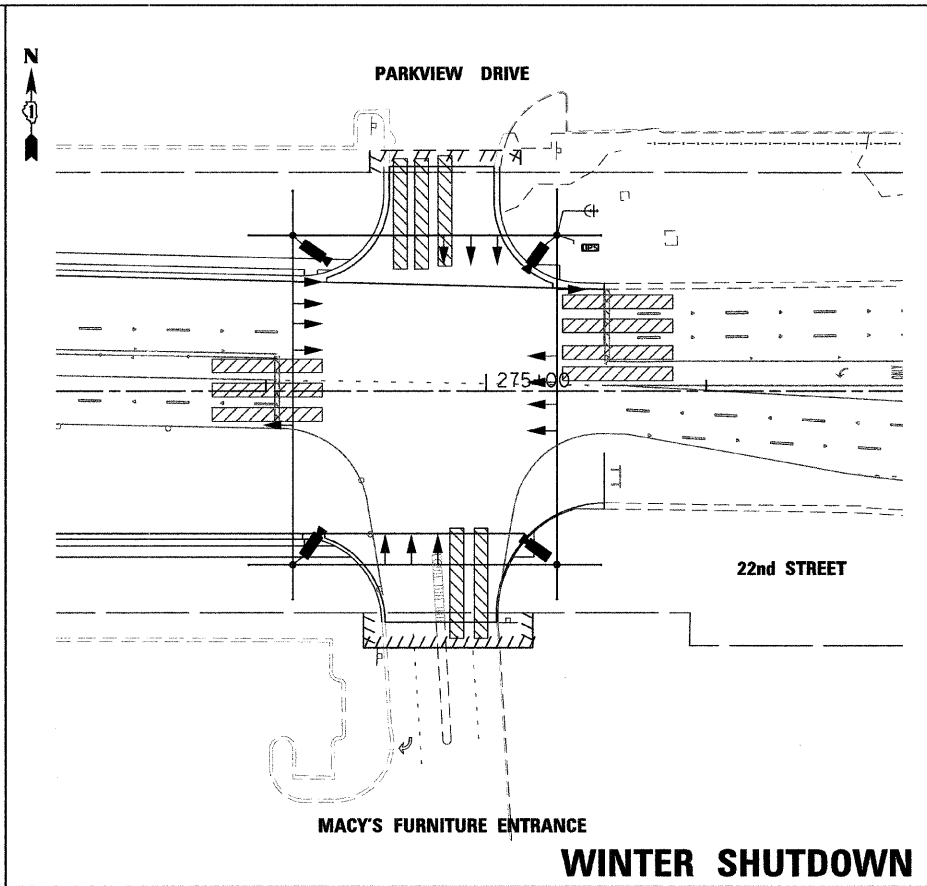

WINTER SHUTDOWN

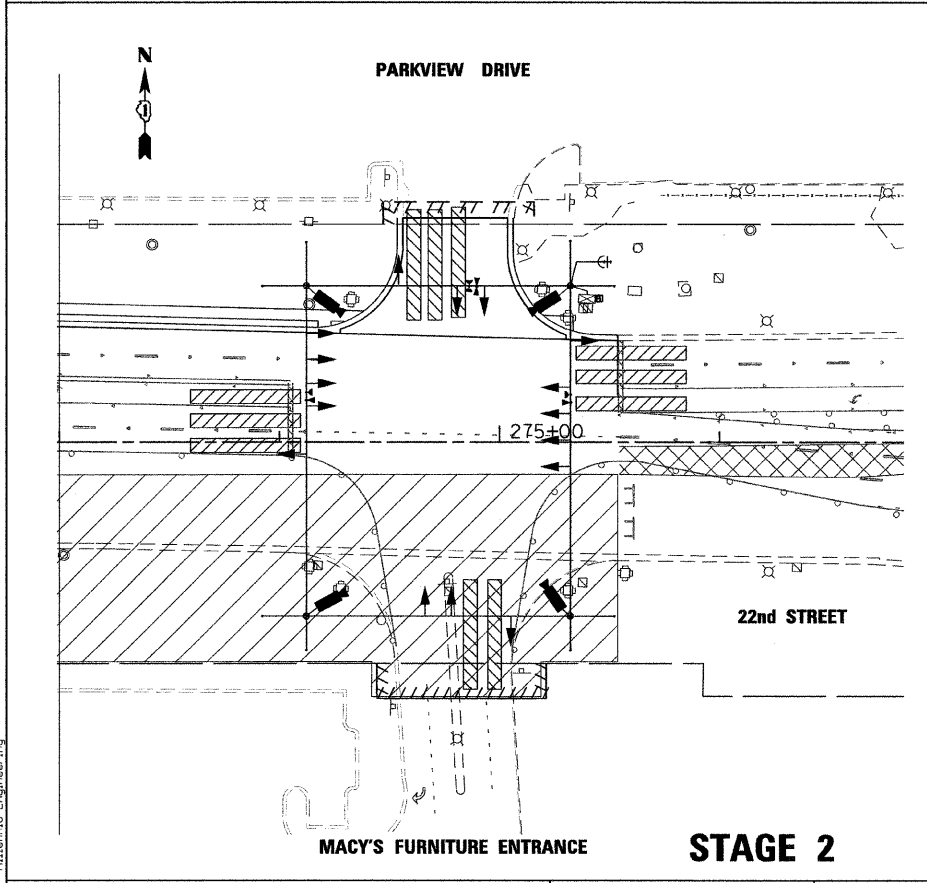

STAGE 2

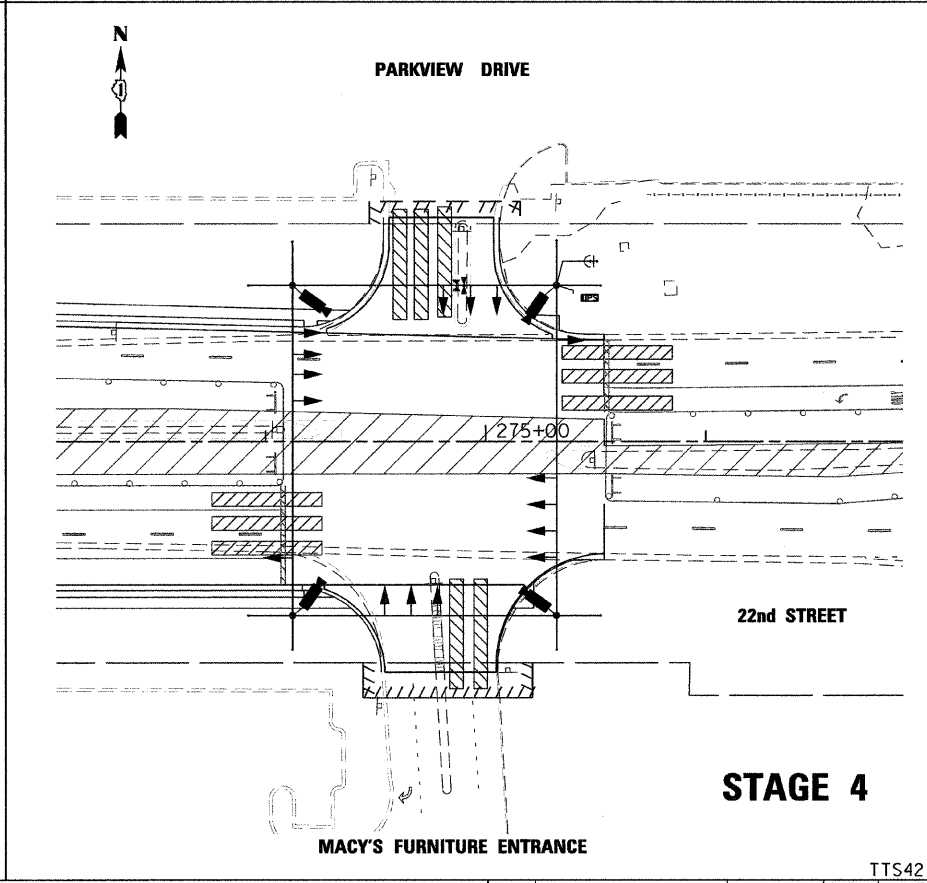

STAGE 4

FILE NAME : P:\2007\MET7881\22nd.Street\Cadd\Shs\0168012-SHT-TTS04-Parkview-02.dgn
 PLOT SCALE : 48.0000 / IN.
 USER NAME : Millennia Engineering



200 22ND Street, Suite 216, Lombard, IL 60148
 630.705.0110 voice, 630.839.2566 fax
 www.millenniaeng.com
MILLENNIA ENGINEERING

DESIGNED - TVN	REVISED -
DRAWN - TVN	REVISED -
CHECKED - RPD	REVISED -
DATE - 10/05/2009	REVISED -

STATE OF ILLINOIS
DEPARTMENT OF TRANSPORTATION

22nd STREET AT PARKVIEW DRIVE
TEMPORARY TRAFFIC SIGNAL M.O.T. STAGING PLAN

SCALE: SHEET NO. 211 OF 362 SHEETS STA. TO STA.

F.A.U. RTE. 1453	SECTION 55WRS	COUNTY	TOTAL SHEETS 362	SHEET NO. 211
FED. ROAD DIST. NO. 7 ILLINOIS FED. AID PROJECT			CONTRACT NO. 60D12	

TTS42

P:\2007\MET7881\22nd.Street\Cadd\Shs\0168012-SHT-TTS04-Parkview-02.dgn