

THE TRAFFIC SIGNAL CONTROL EQUIPMENT FOR THIS TEMPORARY SIGNAL SHALL BE "ECONOLITE" TO MATCH THE EXISTING ADJACENT SYSTEM.

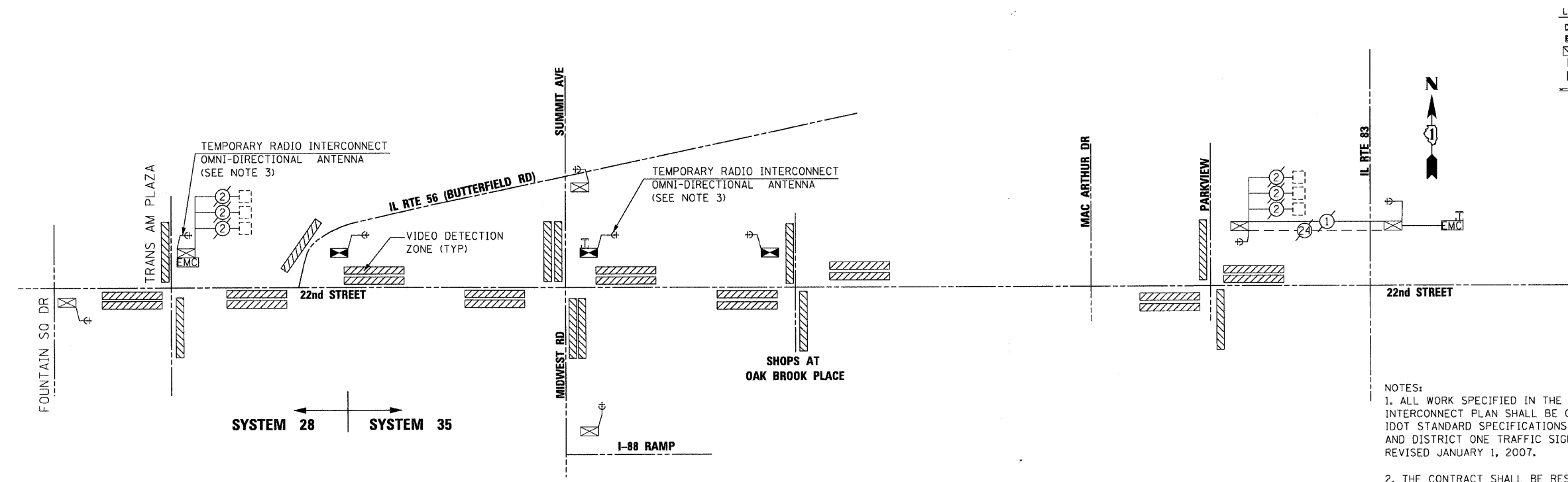

- LEGEND**
- EXISTING CONTROLLER
  - EXISTING MASTER CONTROLLER
  - EXISTING DOUBLE HANDHOLE
  - EXISTING HANDHOLE
  - HEAVY DUTY HANDHOLE
  - G.S. CONDUIT IN TRENCH OR PUSHED
  - INTERSECTION AND SAMPLING (SYSTEM) DETECTOR LOOP
  - TELEPHONE
  - TEMPORARY RADIO INTERCONNECT ANTENNA
  - TEMPORARY WOOD POLE

- NOTES:**
1. ALL WORK SPECIFIED IN THE TEMPORARY TRAFFIC SIGNAL INTERCONNECT PLAN SHALL BE COMPLETED ACCORDING TO IDOT STANDARD SPECIFICATIONS ADOPTED JANUARY 1, 2007, AND DISTRICT ONE TRAFFIC SIGNAL SPECIFICATIONS REVISED JANUARY 1, 2007.
  2. THE CONTRACT SHALL BE RESPONSIBLE FOR MAINTAINING THE EXISTING TRAFFIC SIGNAL INSTALLATIONS AT BUTTERFIELD RD/ AND FOUNTAIN SQUARE DR, BUTTERFIELD RD/SUMMIT AVE, MIDWEST RD/ I-88 RAMP, 22ND STREET/IL ROUTE 83 THE INTERCONNECT SYSTEM BETWEEN THE INTERSECTIONS.

FILE NAME = P:\2007\me07081\_22nd\_street\cadd\shs\0160012-SHT-TINTC05-Schematics.dgn  
 USER NAME = Millennium\_Engineering



200 22ND Street, Suite 216, Lombard, IL 60148  
 630.705.0110 voice, 630.839.2566 fax  
 www.millenniaeng.com  
**MILLENNIA ENGINEERING**

|                  |           |
|------------------|-----------|
| DESIGNED - TVN   | REVISED - |
| DRAWN - TVN      | REVISED - |
| CHECKED - RPD    | REVISED - |
| DATE - 7/24/2009 | REVISED - |

**STATE OF ILLINOIS**  
**DEPARTMENT OF TRANSPORTATION**

**22nd STREET**  
**TEMPORARY INTERCONNECT SCHEMATIC**

SCALE: NONE SHEET NO. 0160012 OF 362 SHEETS STA. TO STA.

|   |         |        |                    |           |
|---|---------|--------|--------------------|-----------|
| F.A.U. RTE.                                     | SECTION | COUNTY | TOTAL SHEETS       | SHEET NO. |
| 1453  | 55WRS   | DUPAGE | 362                | 219       |
| FED. ROAD DIST. NO. 7 ILLINOIS FED. AID PROJECT |         |        | CONTRACT NO. 60D12 |           |

P:\2007\me07081\_22nd\_street\cadd\shs\0160012-SHT-TINTC05-Schematics.dgn