

NOTES:
1. ALL SURFACES ARE CONCRETE UNLESS OTHERWISE NOTED.

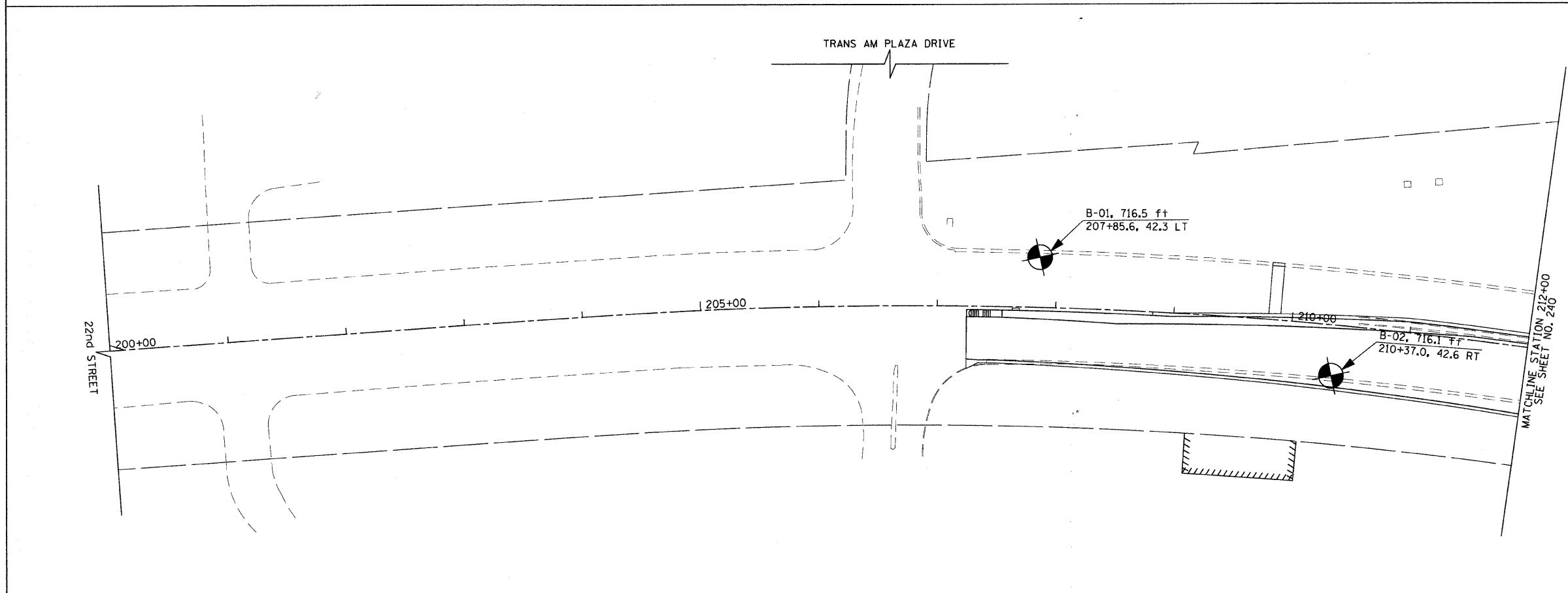

BORING LOCATION PLANS AND SOIL PROFILES:
22ND STREET IMPROVEMENTS, IDOT PROJECT NO. D-91-312-07

Horizontal Scale: _____ Date: 07/24/2009
Vertical Scale: _____ Checked By: S. Sugiarto

Sheet 1 of 11

Wang Engineering
1145 N. Main Street
Lombard, IL 60148
Phone: (630) 953-9928
www.wangeng.com

FOR TRANSSYSTEMS CORPORATION 790-31-01

F.A.U. RTE.	SECTION	COUNTY	TOTAL SHEETS	SHEET NO.
1453	55WRS	DuPAGE	362	239
CONTRACT NO. 60D12				

FED. ROAD DIST. NO. 7 ILLINOIS FED. AID PROJECT

FILE NAME = g:\ch07\0201\road\sheet\0160D12-SHT-501	USER NAME = BAW\jort	DESIGNED - JMG	REVISED -
	-01.dgn	DRAWN - BAW	REVISED -
	PLOT SCALE = 50.0000' / IN.	CHECKED - JRH	REVISED -
	PLOT DATE = 8/5/2009	DATE - 07/24/2009	REVISED -

**STATE OF ILLINOIS
DEPARTMENT OF TRANSPORTATION**

22nd STREET BORING LOCATION PLANS

SCALE: 1"=50' SHEET NO. 239 OF 362 SHEETS STA. 200+00 TO STA. 212+00