

NOTES:
1. ALL SURFACES ARE CONCRETE UNLESS OTHERWISE NOTED.

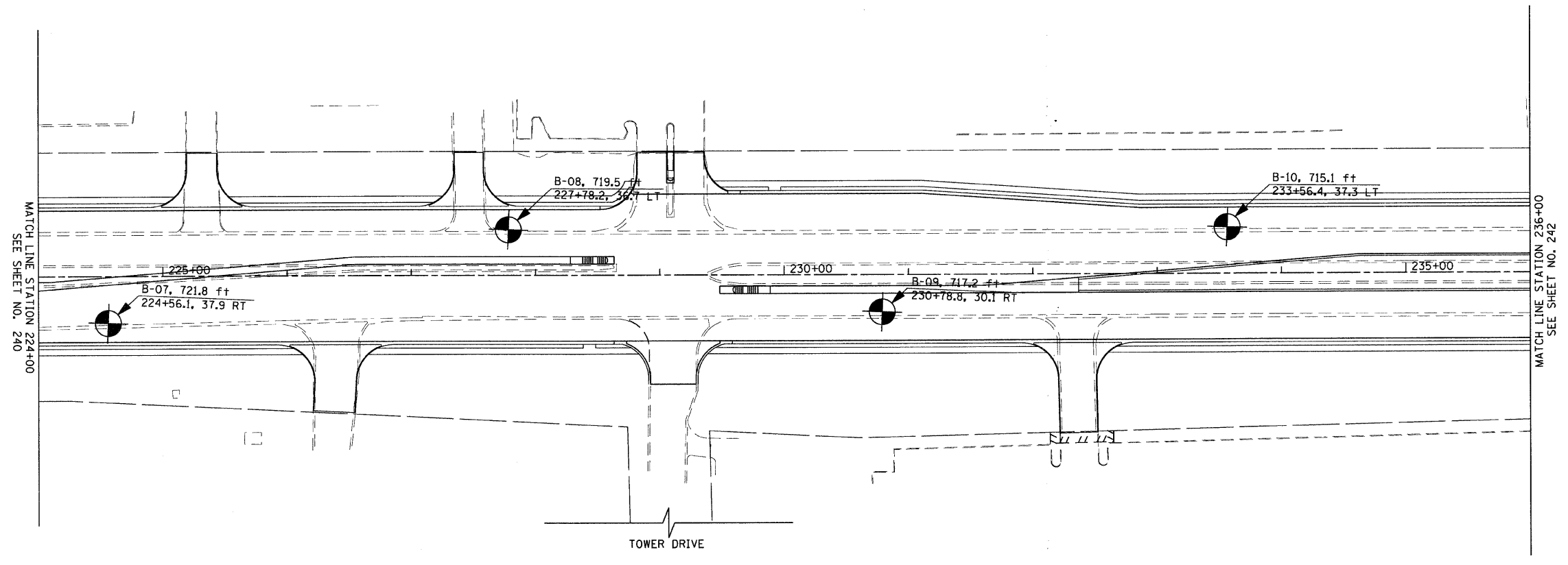

BORING LOCATION PLANS AND SOIL PROFILES:
22ND STREET IMPROVEMENTS, IDOT PROJECT NO. D-91-312-07

Horizontal Scale: _____ Vertical Scale: _____

Sheet 3 of 11

Drawn By: W. Wang
Checked By: S. Sugiarto

Wang Engineering
1145 N. Main Street
Lombard, IL 60148
Phone: (630) 953-9928
www.wangeng.com

FOR TRANSYSTEMS CORPORATION 790-31-01

FILE NAME = g:\ch\07\0061\road\sheet\DI60D12-SHT-501-03.dgn	USER NAME = BAW\stort	DESIGNED - JMG	REVISED -	STATE OF ILLINOIS DEPARTMENT OF TRANSPORTATION	22nd STREET BORING LOCATION PLANS			F.A.U. RTE. 1453	SECTION 55WRS	COUNTY	TOTAL SHEETS 362	SHEET NO. 241
PLOT SCALE = 50.0000' / IN.	CHECKED - JRH	DRAWN - BAW	REVISED -		SCALE: 1"=50'	SHEET NO. 241 OF 362 SHEETS	STA. 224+00 TO STA. 236+00	CONTRACT NO. 60D12		FED. ROAD DIST. NO. 7 ILLINOIS FED. AID PROJECT		
PLOT DATE = 8/5/2009	DATE - 07/24/2009	CHECKED - JRH	REVISED -									
		DATE - 07/24/2009	REVISED -									