

SEE SHEET NO. 241
MATCH LINE STATION 236+00

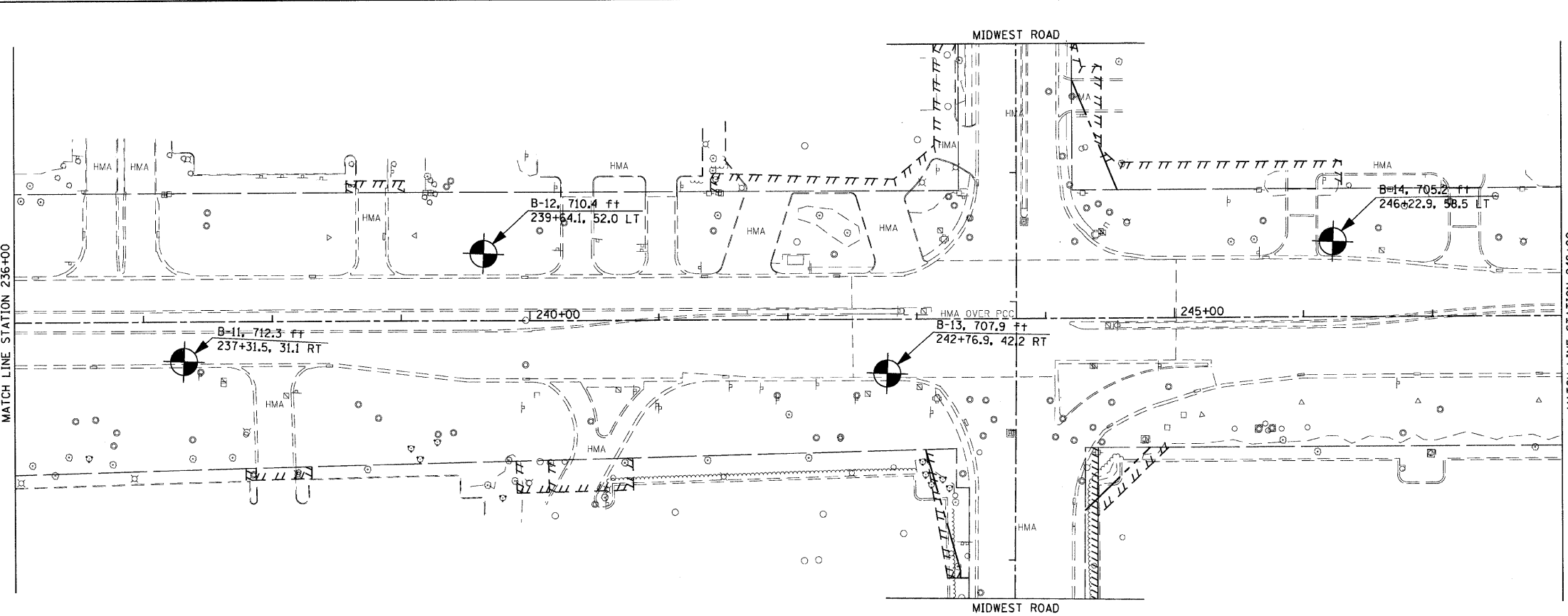

MATCH LINE STATION 248+00
SEE SHEET NO. 243

NOTES:
1. ALL SURFACES ARE CONCRETE UNLESS OTHERWISE NOTED.



SEE SHEET NO. 241
MATCH LINE STATION 236+00

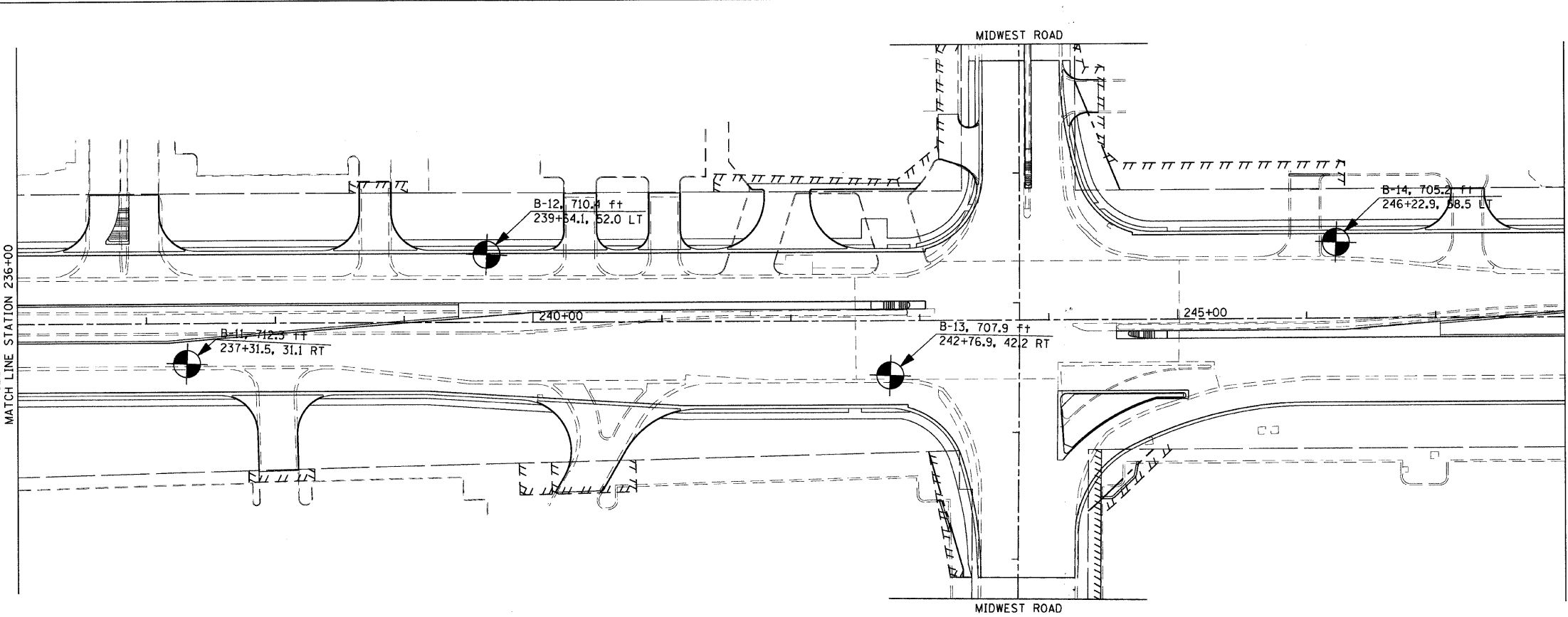

MATCH LINE STATION 248+00
SEE SHEET NO. 243



BORING LOCATION PLANS AND SOIL PROFILES:
22ND STREET IMPROVEMENTS, IDOT PROJECT NO. D-91-312-07

Horizontal Scale: Vertical Scale: Sheet 4 of 11 Drawn By: W. Wang Checked By: S. Sigars



FOR TRANSYSTEMS CORPORATION 790-31-01

FILE NAME = g:\ch07\0061\road\sheet\DI60012-SHT-501.dgn

USER NAME = BAW\bart
PLOT SCALE = 50,0000' / IN.
PLOT DATE = 8/5/2009

DESIGNED - JMG
DRAWN - BAW
CHECKED - JRH
DATE - 07/24/2009

REVISED -
REVISED -
REVISED -
REVISED -

STATE OF ILLINOIS
DEPARTMENT OF TRANSPORTATION

22nd STREET BORING LOCATION PLANS

SCALE: 1"=50' SHEET NO. 242 OF 362 SHEETS STA. 236+00 TO STA. 248+00

F.A.U. RTE.	SECTION	COUNTY	TOTAL SHEETS	SHEET NO.
1453	55WRS	DuPAGE	362	242
FED. ROAD DIST. NO. 7 (ILLINOIS) FED. AID PROJECT			CONTRACT NO. 60D12	