

NOTES:
 1. ALL SURFACES ARE CONCRETE UNLESS OTHERWISE NOTED.

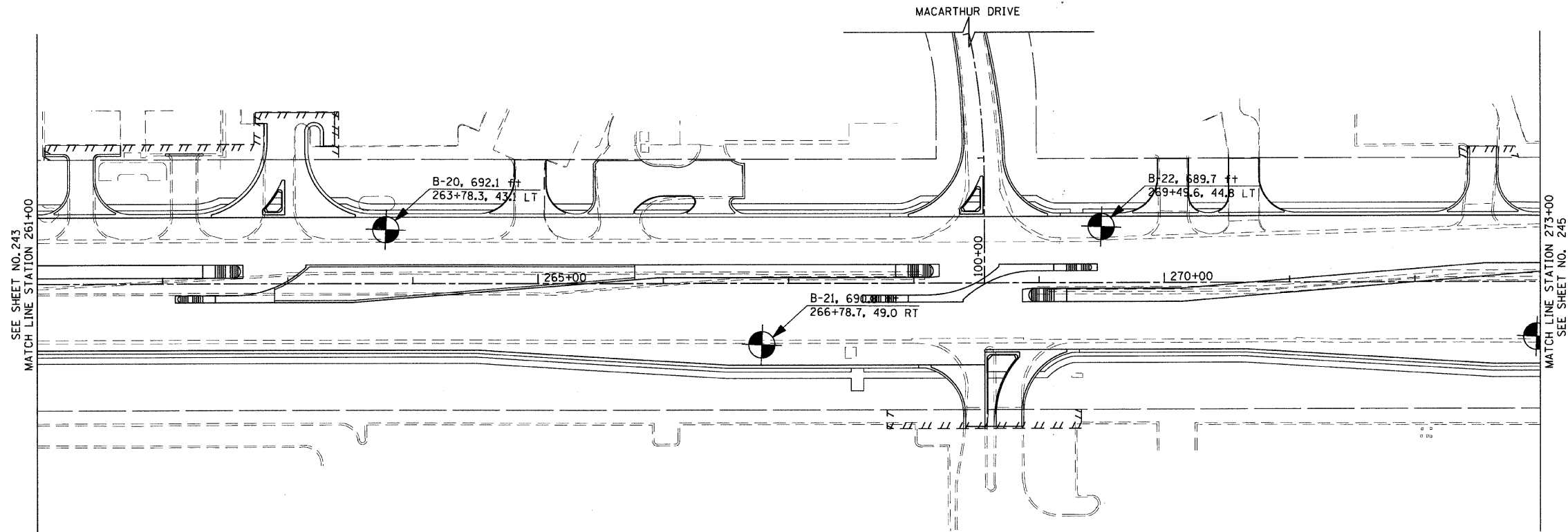

BORING LOCATION PLANS AND SOIL PROFILES: 22ND STREET IMPROVEMENTS, IDOT PROJECT NO. D-91-312-07				
Horizontal Scale:		Sheet 6 of 11		Drawn By: W. Wang
Vertical Scale:				Checked By: S. Sargent
Wang Engineering				
FOR TRANSYSTEMS CORPORATION				
F.A.U. RTE.	SECTION	COUNTY	TOTAL SHEETS	SHEET NO.
1453	55WRS	DuPAGE	362	244
CONTRACT NO. 60D12				
FED. ROAD DIST. NO. 7 ILLINOIS FED. AID PROJECT				

FILE NAME =	USER NAME = BAW1start	DESIGNED - JMG	REVISED -
g:\ch87\0061\road\sheet\0160D12-SHT-50	-06.dgn	DRAWN - BAW	REVISED -
	PLOT SCALE = 50.0000' / IN.	CHECKED - JRH	REVISED -
	PLOT DATE = 8/5/2009	DATE - 07/24/2009	REVISED -

**STATE OF ILLINOIS
DEPARTMENT OF TRANSPORTATION**

22nd STREET BORING LOCATION PLANS

SCALE: 1"=50' SHEET NO. 244 OF 362 SHEETS STA. 261+00 TO STA. 273+00