

DATE	
BY	
FINAL SURVEY	
PLOTTED	
NOTE BOOK	
AREAS CHECKED	
NO.	

DATE	
BY	
ORIGINAL SURVEY	
PLOTTED	
NOTE BOOK	
AREAS CHECKED	
NO.	

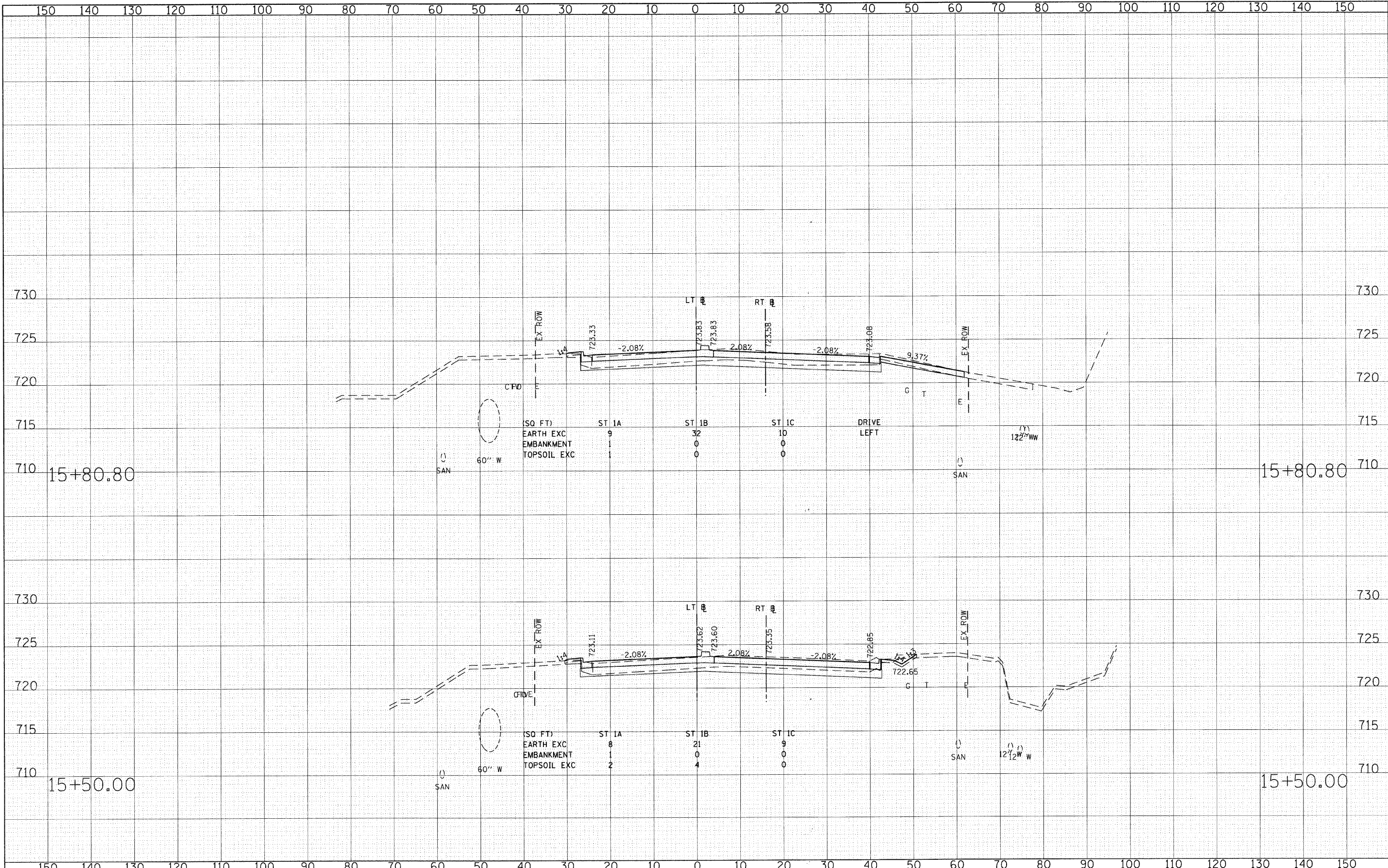

FILE NAME = g:\ch07\0061\road\sheet\160012-SHT-XSHT2.dgn	USER NAME = BAWitor	DESIGNED - JMG	REVISED -	STATE OF ILLINOIS DEPARTMENT OF TRANSPORTATION	CROSS SECTIONS - ILLINOIS ROUTE 56 (BUTTERFIELD ROAD)	F.A. RTE. 1453	SECTION 55WRS	COUNTY DuPAGE	TOTAL SHEETS 362	SHEET NO. 354			
PLOT SCALE = 1/8"=1'-0"	CHECKED - JRH	REVISED -	SCALE: HORIZ: 1"=10'			SHEET NO. 354 OF 362 SHEETS	STA. 15+50.00 TO STA. 15+80.80	FED. ROAD DIST. NO. 7	ILLINOIS FED. AID PROJECT	CONTRACT NO. 60D12			
PLOT DATE = 8/5/2009	DATE - 07/24/2009	REVISED -											