

STATE OF ILLINOIS
DEPARTMENT OF TRANSPORTATION
DIVISION OF HIGHWAYS

**PROPOSED
HIGHWAY PLANS**

F.A.P. ROUTE 104 (IL ROUTE 59) AT SQUAW CREEK
SECTION W-EXT-1
PROJECT NO. NHF-0104(020)
BRIDGE DECK OVERLAY
LAKE COUNTY
JOB NO. C-91-242-10

F.A.P. RTE.	SECTION	COUNTY	TOTAL SHEETS	SHEET NO.
104	W-EXT-1	LAKE	21	1
FED. ROAD DIST. NO. 1		ILLINOIS	CONTRACT NO. 60J52	

#21 + 11 = 32

D-91-242-10



LOCATION OF SECTION INDICATED THIS: -

PREPARED BY:
LIN ENGINEERING, LTD.
CHATHAM, ILLINOIS 62629
(217) 483-4168

FOR INDEX OF SHEETS, SEE SHEET NO. 2
FOR LIST OF STANDARDS, SEE SHEET NO. 2

IMPROVEMENT LOCATED IN
FOX LAKE, IL

S.N. 049-0017
ADT = 14,000 (2007)
POSTED SPEED: 40 MPH

PROJECT LOCATION:

R 9E, 3rd P.M.

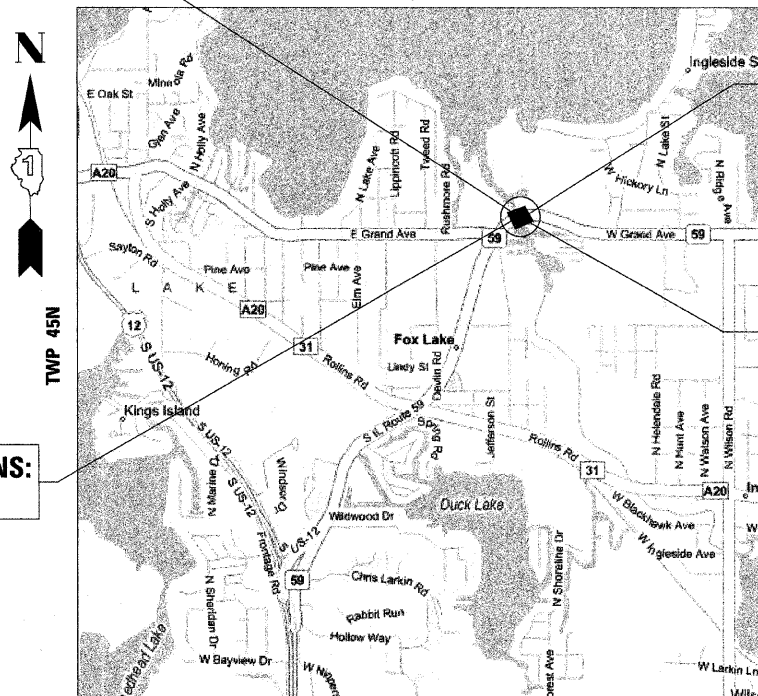

IMPROVEMENT ENDS:
STA. 110+50.00

IL 59 OVER SQUAW CREEK
EXISTING S.N. 049-0017

IMPROVEMENT BEGINS:
STA. 66+30.00

GRANT TOWNSHIP
LOCATION MAP

GROSS AND NET LENGTH OF IMPROVEMENT = 4,420 FEET = 0.84 MILE

GRAPHIC SCALES:

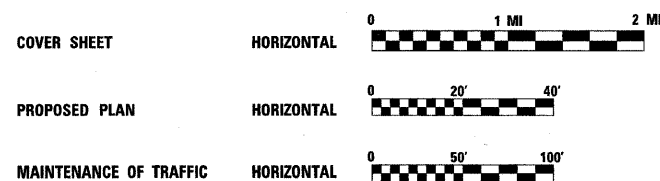

FULL SIZE PLANS HAVE BEEN PREPARED USING STANDARD ENGINEERING SCALES. REDUCED SIZED PLANS WILL NOT CONFORM TO STANDARD SCALES. IN MAKING MEASUREMENTS ON REDUCED PLANS, THE ABOVE SCALES MAY BE USED.

J.U.L.I.E.
JOINT UTILITY LOCATION INFORMATION FOR EXCAVATION
1-800-892-0123
OR 811

PROJECT ENGINEER: MICHELLE A. AQUINO - (847) 705-4606
PROJECT MANAGER: RAJENDRA C. SHAH - (847) 705-4555
CONTRACT NO.: 60J52

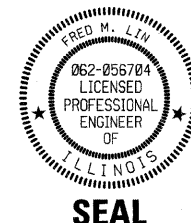

Fred M. Lin

FRED M. LIN, P.E.
ILLINOIS REGISTERED ENGINEER NO. 062-056704
REGISTRATION EXPIRES NOV. 30, 2011

STATE OF ILLINOIS
DEPARTMENT OF TRANSPORTATION
DIVISION OF HIGHWAYS

SUBMITTED JANUARY 22, 2010
Diana M. O'Keefe
DEPUTY DIRECTOR OF HIGHWAYS, REGION ENGINEER

March 19, 2010
Scott E. Stitt, P.E.
ACTING ENGINEER OF DESIGN AND ENVIRONMENT

March 19, 2010
Christine M. Reed
DIRECTOR OF HIGHWAYS, CHIEF ENGINEER

PRINTED BY THE AUTHORITY
OF THE STATE OF ILLINOIS