

NOTE FOR ALL SIDE STREETS:
 RESURFACING LIMITS ARE AT THE RADIUS RETURNS UNLESS OTHERWISE NOTED
 -PROPOSED HOT-MIX ASPHALT SURFACE REMOVAL 2-1/4"
 -PROPOSED HOT-MIX ASPHALT SURFACE COURSE, MIX "D", N 70, 1-1/2"
 -PPROPOSED POLYMERIZED LEVELING BINDER (MACHINE METHOD), IL-4.75, N50, 3/4"

NOTE:
 -FOR RAISED REFLECTIVE PAVEMENT MARKERS, REFER TO TYPICAL APPLICATIONS REISED REFLECTIVE PAVEMENT MARKERS (SNOW PLOW RESISTANT) AND DISTRICT TYPICAL PAVEMENT MARKINGS

△ SHEET ADDED - 03/24/2010

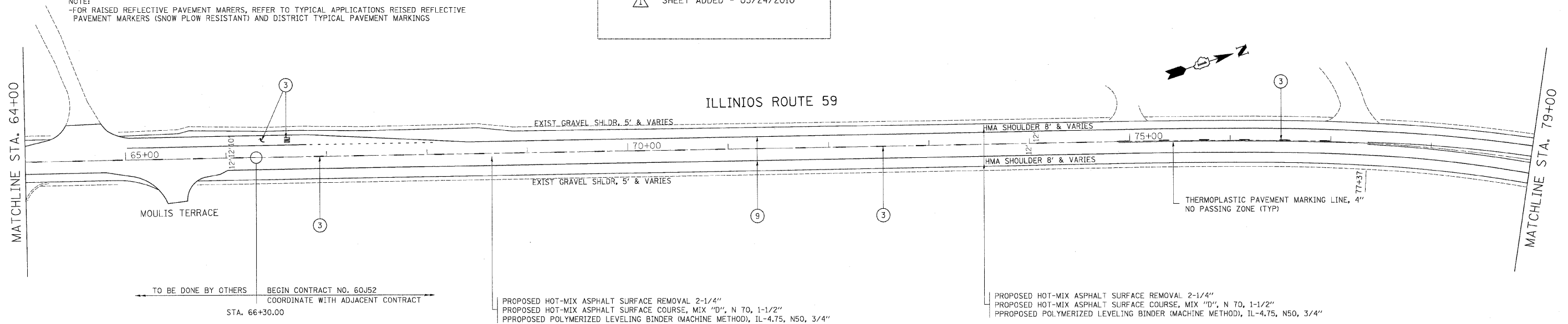

TO BE DONE BY OTHERS
 BEGIN CONTRACT NO. 60J52
 COORDINATE WITH ADJACENT CONTRACT
 STA. 66+30.00

PROPOSED HOT-MIX ASPHALT SURFACE REMOVAL 2-1/4"
 PROPOSED HOT-MIX ASPHALT SURFACE COURSE, MIX "D", N 70, 1-1/2"
 PPROPOSED POLYMERIZED LEVELING BINDER (MACHINE METHOD), IL-4.75, N50, 3/4"

PROPOSED HOT-MIX ASPHALT SURFACE REMOVAL 2-1/4"
 PROPOSED HOT-MIX ASPHALT SURFACE COURSE, MIX "D", N 70, 1-1/2"
 PPROPOSED POLYMERIZED LEVELING BINDER (MACHINE METHOD), IL-4.75, N50, 3/4"

PROPOSED HOT-MIX ASPHALT SURFACE REMOVAL 2-1/4"
 PROPOSED HOT-MIX ASPHALT SURFACE COURSE, MIX "D", N 70, 1-1/2"
 PPROPOSED POLYMERIZED LEVELING BINDER (MACHINE METHOD), IL-4.75, N50, 3/4"

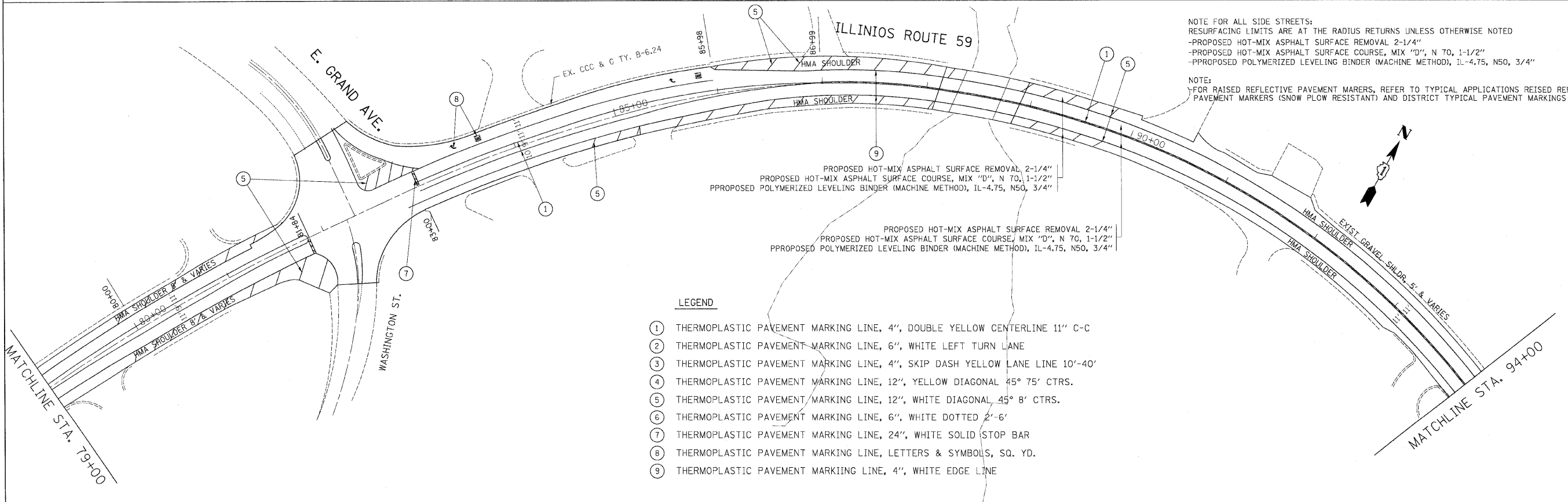

NOTE FOR ALL SIDE STREETS:
 RESURFACING LIMITS ARE AT THE RADIUS RETURNS UNLESS OTHERWISE NOTED
 -PROPOSED HOT-MIX ASPHALT SURFACE REMOVAL 2-1/4"
 -PROPOSED HOT-MIX ASPHALT SURFACE COURSE, MIX "D", N 70, 1-1/2"
 -PPROPOSED POLYMERIZED LEVELING BINDER (MACHINE METHOD), IL-4.75, N50, 3/4"

NOTE:
 -FOR RAISED REFLECTIVE PAVEMENT MARKERS, REFER TO TYPICAL APPLICATIONS REISED REFLECTIVE PAVEMENT MARKERS (SNOW PLOW RESISTANT) AND DISTRICT TYPICAL PAVEMENT MARKINGS

PROPOSED HOT-MIX ASPHALT SURFACE REMOVAL 2-1/4"
 PROPOSED HOT-MIX ASPHALT SURFACE COURSE, MIX "D", N 70, 1-1/2"
 PPROPOSED POLYMERIZED LEVELING BINDER (MACHINE METHOD), IL-4.75, N50, 3/4"

PROPOSED HOT-MIX ASPHALT SURFACE REMOVAL 2-1/4"
 PROPOSED HOT-MIX ASPHALT SURFACE COURSE, MIX "D", N 70, 1-1/2"
 PPROPOSED POLYMERIZED LEVELING BINDER (MACHINE METHOD), IL-4.75, N50, 3/4"

LEGEND

- ① THERMOPLASTIC PAVEMENT MARKING LINE, 4", DOUBLE YELLOW CENTERLINE 11" C-C
- ② THERMOPLASTIC PAVEMENT MARKING LINE, 6", WHITE LEFT TURN LANE
- ③ THERMOPLASTIC PAVEMENT MARKING LINE, 4", SKIP DASH YELLOW LANE LINE 10'-40'
- ④ THERMOPLASTIC PAVEMENT MARKING LINE, 12", YELLOW DIAGONAL 45° 75' CTRS.
- ⑤ THERMOPLASTIC PAVEMENT MARKING LINE, 12", WHITE DIAGONAL 45° 8' CTRS.
- ⑥ THERMOPLASTIC PAVEMENT MARKING LINE, 6", WHITE DOTTED 2'-6"
- ⑦ THERMOPLASTIC PAVEMENT MARKING LINE, 24", WHITE SOLID STOP BAR
- ⑧ THERMOPLASTIC PAVEMENT MARKING LINE, LETTERS & SYMBOLS, SQ. YD.
- ⑨ THERMOPLASTIC PAVEMENT MARKING LINE, 4", WHITE EDGE LINE

FILE NAME =	USER NAME = #USER#	DESIGNED -	REVISED -	STATE OF ILLINOIS DEPARTMENT OF TRANSPORTATION	IL. ROUTE 59 RESURFACING & PAVEMENT MARKING PLANS	F.A.P. RTE.	SECTION	COUNTY	TOTAL SHEETS	SHEET NO.	
#FILE#		DRAWN -	REVISED -			104	W-EXT-1	LAKE	21	4A	
		CHECKED -	REVISED -			CONTRACT NO. 60J52					
		DATE -	REVISED -			ILLINOIS FED. AID PROJECT					
PLOT SCALE = #SCALE#		PLOT DATE = #DATE#		SCALE:		SHEET NO. OF SHEETS		STA. TO STA.			