

STATE OF ILLINOIS
DEPARTMENT OF TRANSPORTATION

Existing Structure:

The existing structure is a three span steel beam bridge with a 7 inch reinforced concrete deck and a 1.75 inch bituminous overlay. The original structure was built in 1954 as Section K-VB. In 1984 the structure was widened with transverse joint replacement, scupper replacement, and deck and substructure repairs.

A detour will be utilized to redirect traffic around the structure.

No salvage.

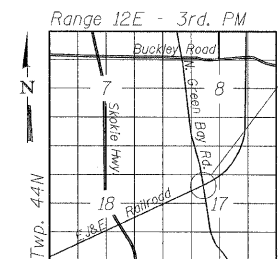

LOCATION SKETCH

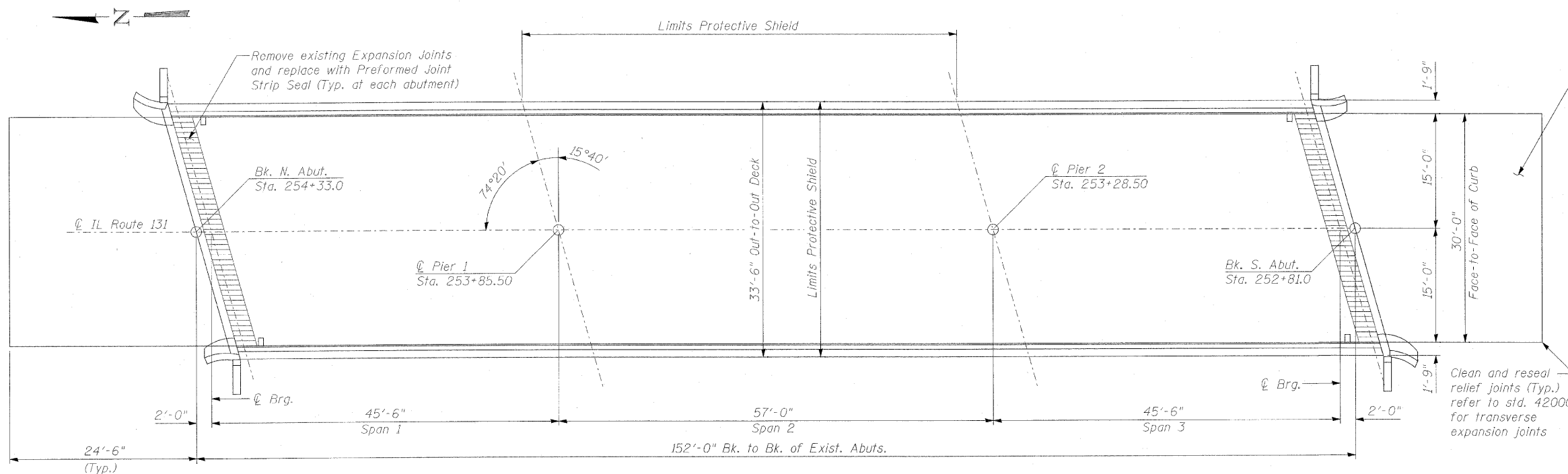

PLAN

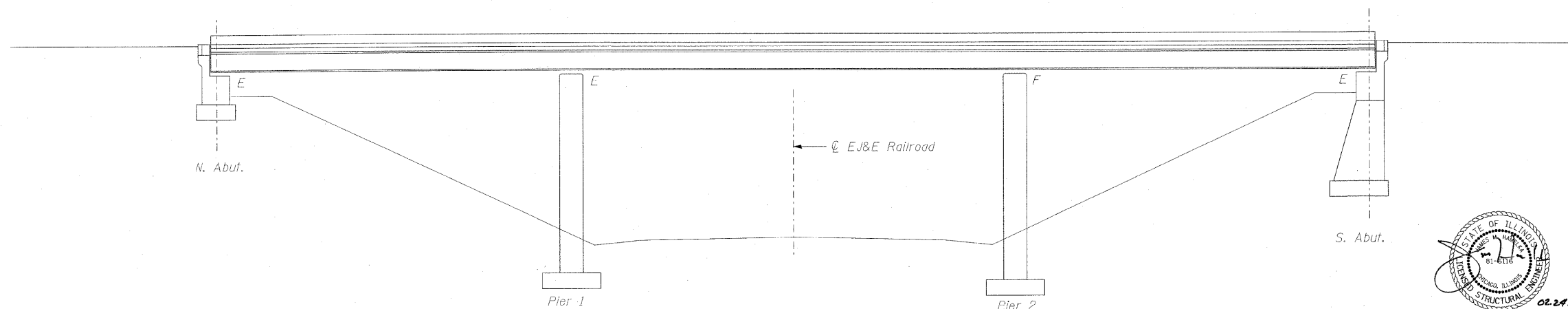

ELEVATION

SCOPE OF WORK

1. Remove and replace existing expansion bearings with elastomeric bearings.
2. Bridge deck and approach overlay removal.
3. Bridge deck hydro-scarification.
4. Repair bridge deck and approaches.
5. Reconstruct deck joints at each abutment with preformed strip seal.
6. Place new latex concrete overlay on bridge deck.
7. Place new HMA overlay on approaches.
8. Repair substructures.
9. Clean and reseal pavement relief joints.
10. Place rip-rap at eroded slopes.
11. Remove and replace existing drains. Install drainage system.
12. Repair ends of 30WF116 beams. Replace end diaphragms.

DESIGN SPECIFICATIONS

2002 AASHTO Standard Specifications for Highway Bridges, 17th Edition

DESIGN STRESSES

$f'_c = 3,500$ psi
 $f_y = 60,000$ psi

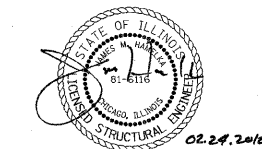

COLLINS ENGINEERS, INC.
JAMES M. HAMELKA
NO. 81-6116
EXPIRES 11-30-2010

GENERAL PLAN & ELEVATION
F.A.U. ROUTE 2711 SEC. K-VB-I
LAKE COUNTY
STATION 253+57
STRUCTURE NO. 049-0012

DESIGNED JWK	2010
CHECKED JMH	EXAMINED
DRAWN DR	PASSED
CHECKED JWK	ENGINEER OF STRUCTURAL SERVICES
	ENGINEER OF BRIDGES AND STRUCTURES

SHEET NO. S1 OF S15 SHEETS	F.A.U. RTE.	SECTION	COUNTY	TOTAL SHEETS	SHEET NO.
	2711	K-VB-I	LAKE	21	4
CONTRACT NO. 60J63					
ILLINOIS FED. AID PROJECT					