

STATE OF ILLINOIS  
DEPARTMENT OF TRANSPORTATION

Existing Structure: The structure is a single span reinforced concrete slab bridge with a hot-mix asphalt overlay.  
The original structure was built in 1926 as Section 3025-I 1.

Salvage: None.

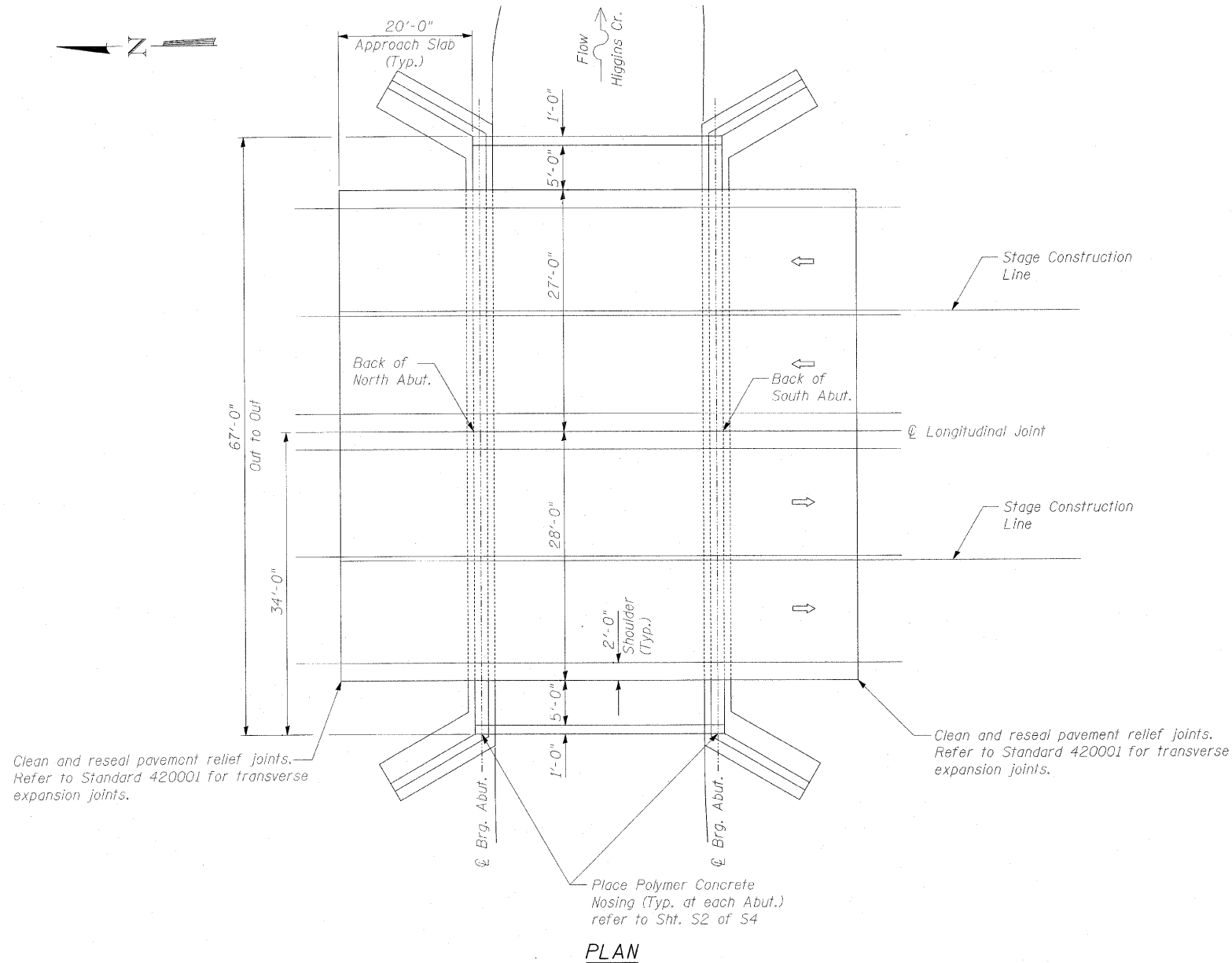

PLAN

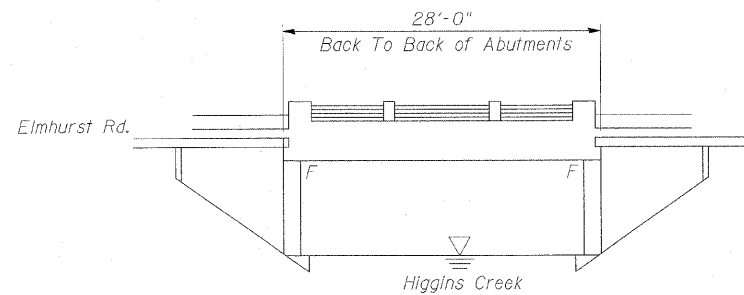

ELEVATION

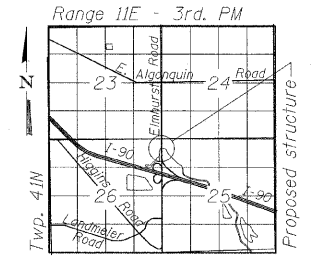

LOCATION SKETCH

**DESIGN SPECIFICATIONS**  
2002 AASHTO Standard Specifications  
for Highway Bridges, 17th Edition

**DESIGN STRESSES**  
 $f'_c = 3,500$  psi  
 $f_y = 60,000$  psi

- SCOPE OF WORK**
1. Bridge deck and approach pavement overlay removal.
  2. Bridge deck hydro-scarification.
  3. Reconstruct longitudinal joint.
  4. Repair bridge deck.
  5. Repair approach slabs.
  6. Repair parapets and sidewalks.
  7. Place new overlay.
  8. Clean and reseal pavement relief joints.

Clean and reseal pavement relief joints.  
Refer to Standard 420001 for transverse expansion joints.

Clean and reseal pavement relief joints.  
Refer to Standard 420001 for transverse expansion joints.

Place Polymer Concrete Nosing (Typ. at each Abut.)  
refer to Sht. S2 of S4

COLLINS ENGINEERS, INC.  
JAMES M. HAMELKA  
NO. 81-6116  
EXPIRES 11-30-2010

**GENERAL PLAN AND ELEVATION**  
**F.A.U. ROUTE 2678 SEC. 3025-I-1**  
**ELMHURST ROAD OVER HIGGINS CREEK**  
**COOK COUNTY**  
**STATION 51+88**  
**STRUCTURE NO. 016-0677**

DESIGNED	JMC/JMH
CHECKED	JMH
DRAWN	JMC
CHECKED	SLK

EXAMINED	2010
PASSED	ENGINEER OF STRUCTURAL SERVICES
	ENGINEER OF BRIDGES AND STRUCTURES

SHEET NO. S1 OF S4 SHEETS	F.A.U. RTE.	SECTION	COUNTY	TOTAL SHEETS	SHEET NO.
	2678	3025-I-1	COOK	10	5
CONTRACT NO. 60J70					
ILLINOIS FED. AID PROJECT					