

EXISTING TYPICAL CROSS SECTION

**LEGEND**

- ① EXISTING PCC PAVEMENT
- ② EXISTING PCC BASE COURSE 9"
- ③ EXISTING HMA SURFACE ± 3 3/4" (AFTER MILLING)
- ④ EXISTING COMB. CONCRETE CURB & GUTTER, VARIOUS TYPES
- ⑤ EXISTING AGGREGATE & HMA SHOULDER
- ⑥ PROP. HMA SURFACE REMOVAL, 2 1/4"
- ⑦ PROP. POLYMERIZED LEVELING BINDER (MM), IL-4.75, N50, 3/4"
- ⑧ PROP. HMA SURFACE COURSE, MIX "D", N70 1 1/2"
- ⑨ PROP. GRADING & SHAPING SHOULDERS

REMOVAL ITEM

\* WIDTHS OF HMA AND AGGREGATE SHOULDERS MAY VARY

**NOTE:**

THE CONTRACTOR SHALL MILL FIRST BEFORE PATCHING

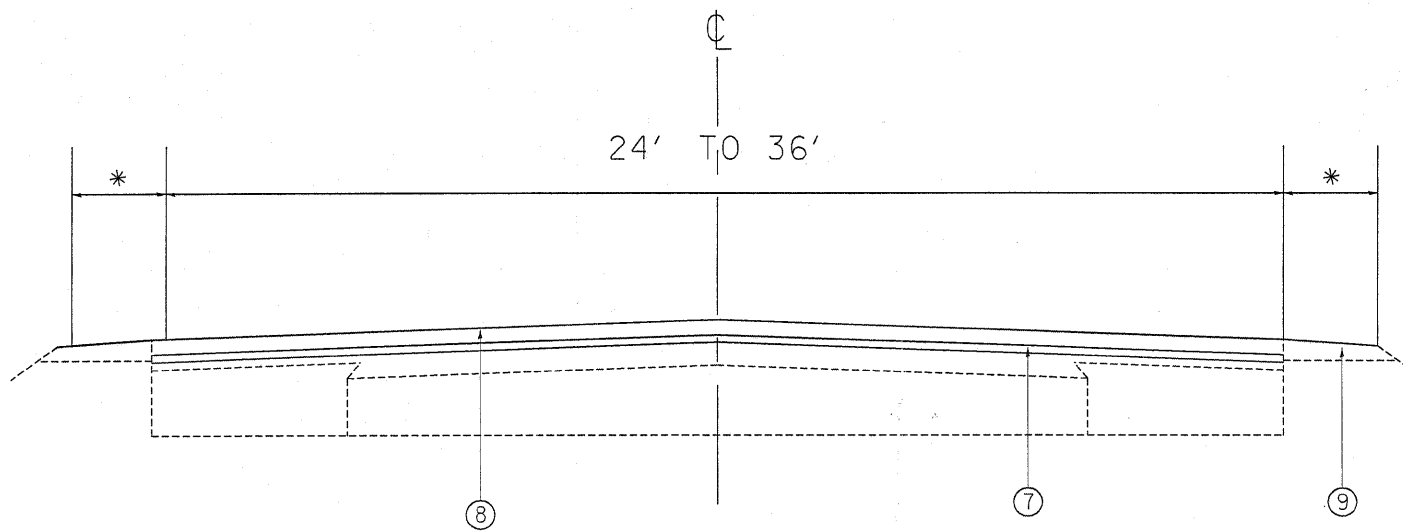

PROPOSED TYPICAL CROSS SECTION

FILE NAME =	USER NAME = m05550	DESIGNED -	REVISED -	<b>STATE OF ILLINOIS DEPARTMENT OF TRANSPORTATION</b>	SCALE:	SHEET NO. OF SHEETS STA. TO STA.	F.A.P. RTE.	SECTION	COUNTY	TOTAL SHEETS	SHEET NO.
ct:\pw_work\PWIDOT\M05550\02177698\01316	@-shh-plan.dgn	DRAWN -	REVISED -				866	3 RS - 3	LAKE	35	5
	PLOT SCALE = 50.0000' / IN.	CHECKED -	REVISED -				CONTRACT NO. 60J94				
	PLOT DATE = 2/3/2010	DATE -	REVISED -				ILLINOIS FED. AID PROJECT				