

**TRAFFIC SIGNAL LEGEND**

- DETECTOR LOOP
- SIGNAL HEAD
- G.S. CONDUIT IN TRENCH OR PUSHED
- SIGNAL HEAD WITH BACKPLATE
- RACEWAY FOR MAGNETIC DETECTOR, TYPE I OR II
- VEHICLE DETECTOR, NON-COMPENSATED MAGNETIC TYPE

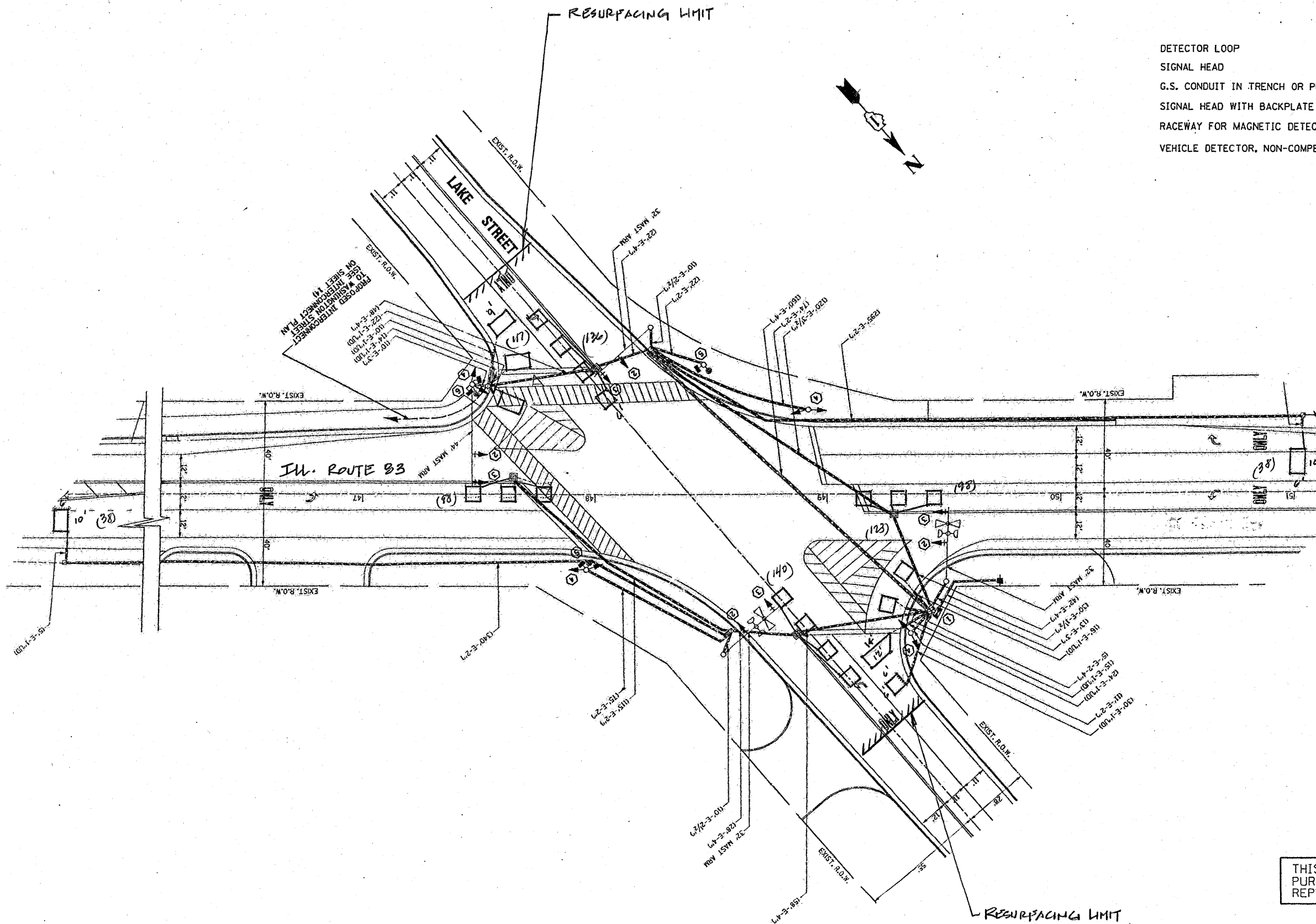
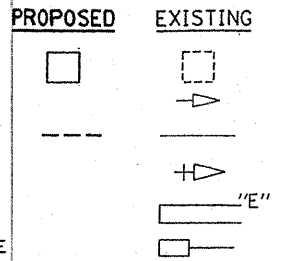

THIS PLAN IS FOR THE SOLE PURPOSE OF DETECTOR LOOP REPLACEMENTS ONLY

REPLACE ALL DETECTOR LOOPS AS SHOWN (WITHIN THE RESURFACING LIMITS)

CODE	QUANTITY	UNIT	ITEM
86600600	788	FOOT	DETECTOR LOOP, REPLACEMENT

FILE NAME =	USER NAME = kenthphixeybc	DESIGNED - BCK	REVISED -	<b>STATE OF ILLINOIS DEPARTMENT OF TRANSPORTATION</b>	<b>DISTRICT ONE - DETECTOR LOOP REPLACEMENT ILL. ROUTE 83 @ LAKE STREET</b>	F.A.P. RTE.	SECTION	COUNTY	TOTAL SHEETS	SHEET NO.	
ct:\pwork\VPWIDOT\KANTHAPHIXAYBC\d01126	traffic.legend.v7.dgn	DRAWN - BCK	REVISED -			8660	3 RS-3	LAKE	35	22	
	PLOT SCALE = 3/4" = 1' IN.	CHECKED - DAD	REVISED -			CONTRACT NO.					
	PLOT DATE = 4/3/2009	DATE	REVISED -			SCALE: NONE	SHEET NO. OF SHEETS	STA. TO STA.	FED. ROAD DIST. NO.	ILLINOIS FED. AID PROJECT	