

STATE OF ILLINOIS
 DEPARTMENT OF TRANSPORTATION
 DIVISION OF HIGHWAYS
**PROPOSED
 HIGHWAY PLANS**
 FAP ROUTE 366 / CENTRAL AVENUE
 SECTION 0203 RS-2

F.A.P. RTE.	SECTION	COUNTY	TOTAL SHEETS	SHEET NO.
366	0203 RS-2	COOK	23	1
		ILLINOIS	CONTRACT NO. 60J99	

FOR INDEX OF SHEETS, SEE SHEET NO. 2

PROJECT IS LOCATED
 IN THE CITY OF CHICAGO
 AND VILLAGE OF FOREST VIEW

47TH STREET TO 63RD STREET
 RESURFACING
 COOK COUNTY
 C-91-321-10

R 13 E

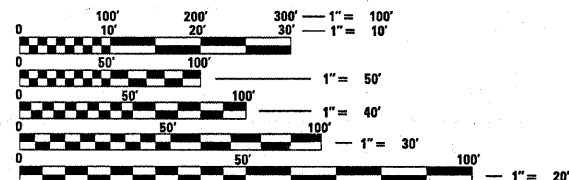
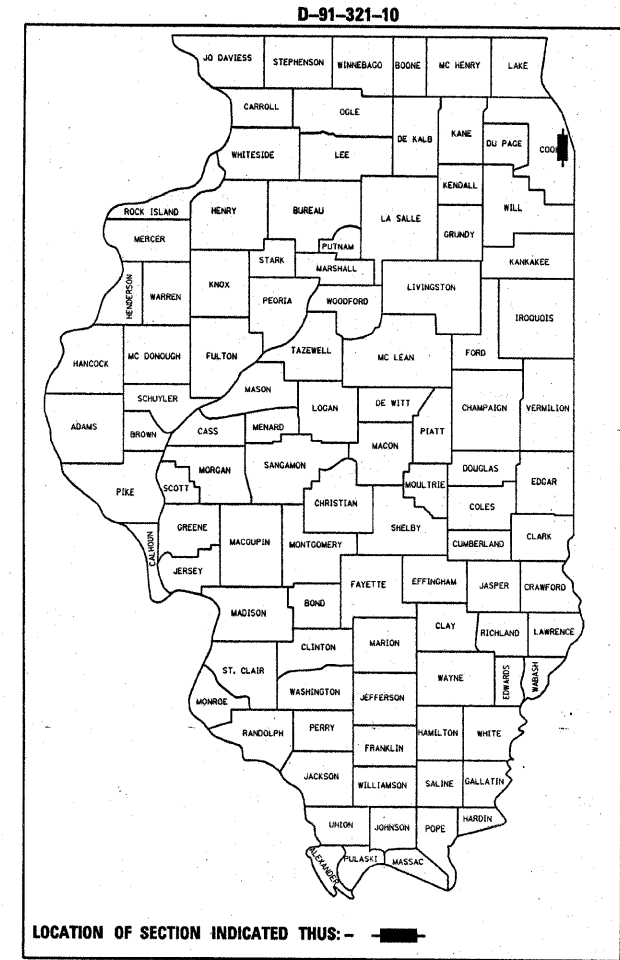

FULL SIZE PLANS HAVE BEEN PREPARED USING STANDARD ENGINEERING SCALES. REDUCED SIZED PLANS WILL NOT CONFORM TO STANDARD SCALES. IN MAKING MEASUREMENTS ON REDUCED PLANS, THE ABOVE SCALES MAY BE USED.

J.U.L.I.E.
 JOINT UTILITY LOCATION INFORMATION FOR EXCAVATION
 1-800-892-0123
 OR 811

PROJECT ENGINEER: KARI SMITH (847)705-4437
 PROJECT MANAGER: KEN ENG

CONTRACT NO. 60J99

PROJECT ENDS
 STA 112+34

RAIL ROAD OMISSION
 FROM STA. 66+35
 TO STA. 66+47

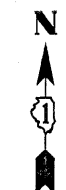
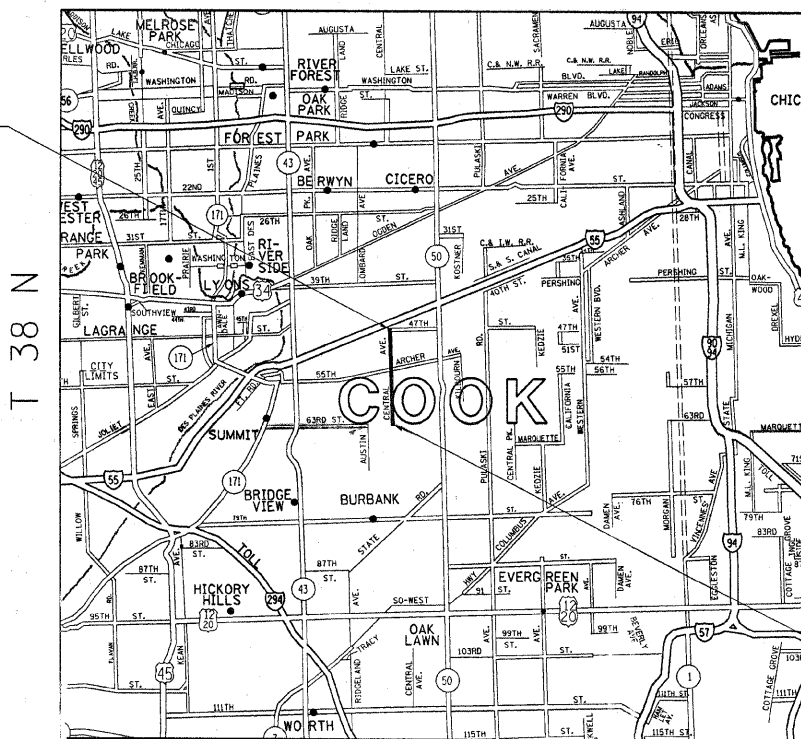

TRAFFIC DATA
 2006 ADT: 34,300
 POSTED SPEED LIMIT: 30 MPH

PROJECT BEGINS
 STA 4+78

STICKNEY TOWNSHIP

GROSS & NET LENGTH OF PROJECT = 10,756 FT. = 2.037 MILES

STATE OF ILLINOIS
 DEPARTMENT OF TRANSPORTATION
 DIVISION OF HIGHWAYS

SUBMITTED FEBRUARY 5, 2010

Dina M. O'Keefe DEPUTY DIRECTOR OF HIGHWAYS, REGION ENGINEER
 March 19, 2010

Scott E. Still, P.E. ENGINEER OF DESIGN AND ENVIRONMENT
 March 19, 2010

Christine M. Reed DIRECTOR OF HIGHWAYS, CHIEF ENGINEER

PRINTED BY THE AUTHORITY
 OF THE STATE OF ILLINOIS