

**LEGEND**

- ① THERMOPLASTIC PAVEMENT MARKING LINE, 4", DOUBLE YELLOW CENTERLINE 11" C-C (TYP.)
- ② THERMOPLASTIC PAVEMENT MARKING LINE, 6", WHITE LEFT TURN LANE (TYP.)
- ③ THERMOPLASTIC PAVEMENT MARKING LINE, 4", SKIP DASH WHITE LANE LINE 10'-40' (TYP.)
- ④ THERMOPLASTIC PAVEMENT MARKING LINE, 12", YELLOW DIAGONAL 45° 75' CTRS. (TYP.)
- ⑤ THERMOPLASTIC PAVEMENT MARKING LINE, 12", WHITE DIAGONAL 45° 8' CTRS. (TYP.)
- ⑥ THERMOPLASTIC PAVEMENT MARKING LINE, 6", WHITE DOTTED 2'-6' (TYP.)
- ⑦ THERMOPLASTIC PAVEMENT MARKING LINE, 24", WHITE SOLID STOP BAR (TYP.)
- ⑧ THERMOPLASTIC PAVEMENT MARKING LINE, LETTERS & SYMBOLS, SQ. YD. (TYP.)
- ⑨ THERMOPLASTIC PAVEMENT MARKING LINE, 6" SOLID WHITE, CROSSWALK (TYP.)
- ⑩ THERMOPLASTIC PAVEMENT MARKING LINES, MEDIAN, 4" YELLOW 5-1/2" C-C (TYP.)
- ⑪ THERMOPLASTIC PAVEMENT MARKING LINE, LETTERS AND SYMBOLS, MEDIAN WITH TWO-WAY LEFT TURN LANE, SQ. YD. (TYP.)

NOTE FOR ALL SIDE STREETS:  
 RESURFACING LIMITS ARE AT THE RADIUS RETURNS UNLESS OTHERWISE NOTED  
 -PROPOSED HOT-MIX ASPHALT SURFACE REMOVAL 2-1/2"  
 -PROPOSED POLYMERIZED HOT-MIX ASPHALT SURFACE COURSE, MIX "F", N 90, 1-3/4"  
 -PROPOSED POLYMERIZED LEVELING BINDER (MACHINE METHOD), IL-4.75, N50, 3/4"

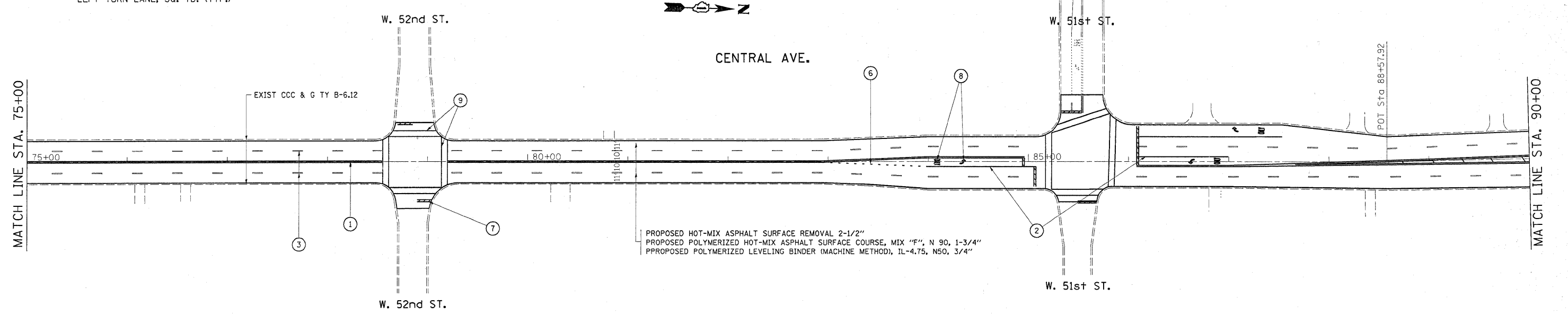

PROPOSED HOT-MIX ASPHALT SURFACE REMOVAL 2-1/2"  
 PROPOSED POLYMERIZED HOT-MIX ASPHALT SURFACE COURSE, MIX "F", N 90, 1-3/4"  
 PROPOSED POLYMERIZED LEVELING BINDER (MACHINE METHOD), IL-4.75, N50, 3/4"

FILE NAME =	USER NAME = byunsh	DESIGNED -	REVISED -	<b>STATE OF ILLINOIS DEPARTMENT OF TRANSPORTATION</b>	<b>CENTRAL AVENUE 47TH STREET TO 63RD STREET ROADWAY AND PAVEMENT MARKING PLAN</b>			F.A.P. RTE. 366	SECTION 0203 RS-2	COUNTY COOK	TOTAL SHEETS 23	SHEET NO. 8	
CONTRACT NO. 60J99	ILLINOIS FED. AID PROJECT												
PLOT SCALE = 50,0000' / IN.	CHECKED -	REVISED -	REVISED -		SCALE:	SHEET NO.	OF	SHEETS	STA.	TO STA.			
PLOT DATE = 2/9/2010	DATE -	REVISED -	REVISED -										