

F.A. RTE.	SECTION	COUNTY	TOTAL SHEETS	SHEET NO.
301	177-2 (-1A, B-1, VB-1)	STEPHENSON	386	65
STA.	TO STA.			
620+00	635+00			
FED. ROAD DIST. NO.	ILLINOIS	FED. AID PROJECT		
P-92-029-02			PLN-16 OF 32	
CONTRACT #64799				

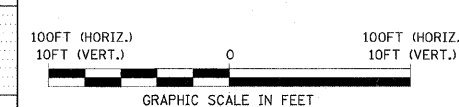
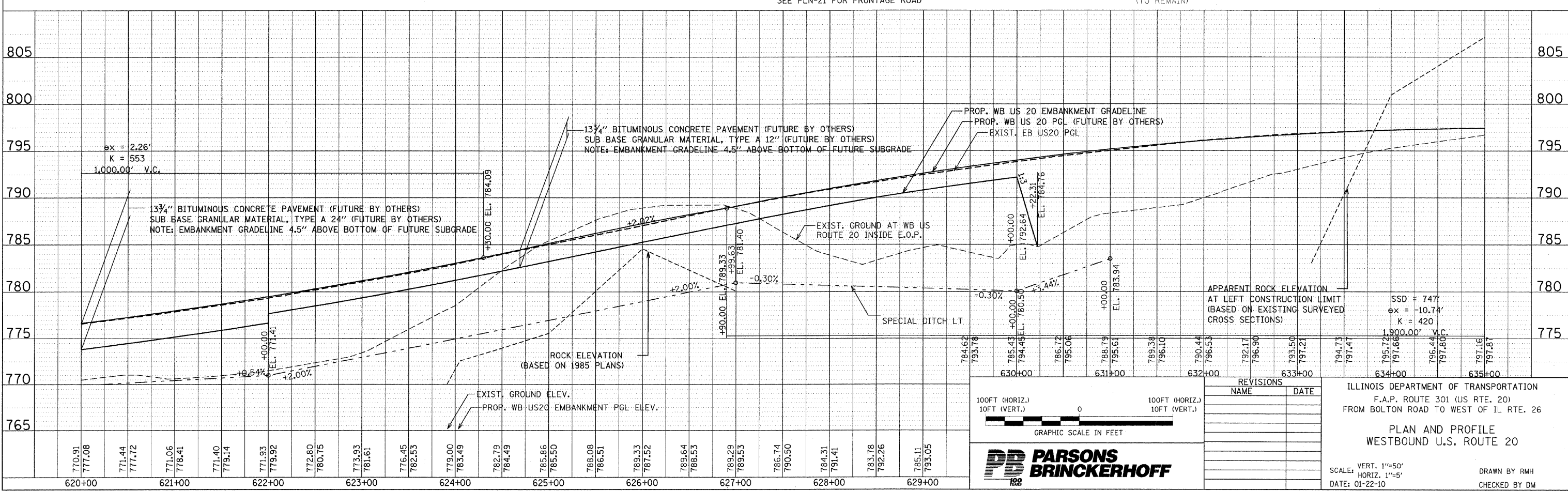
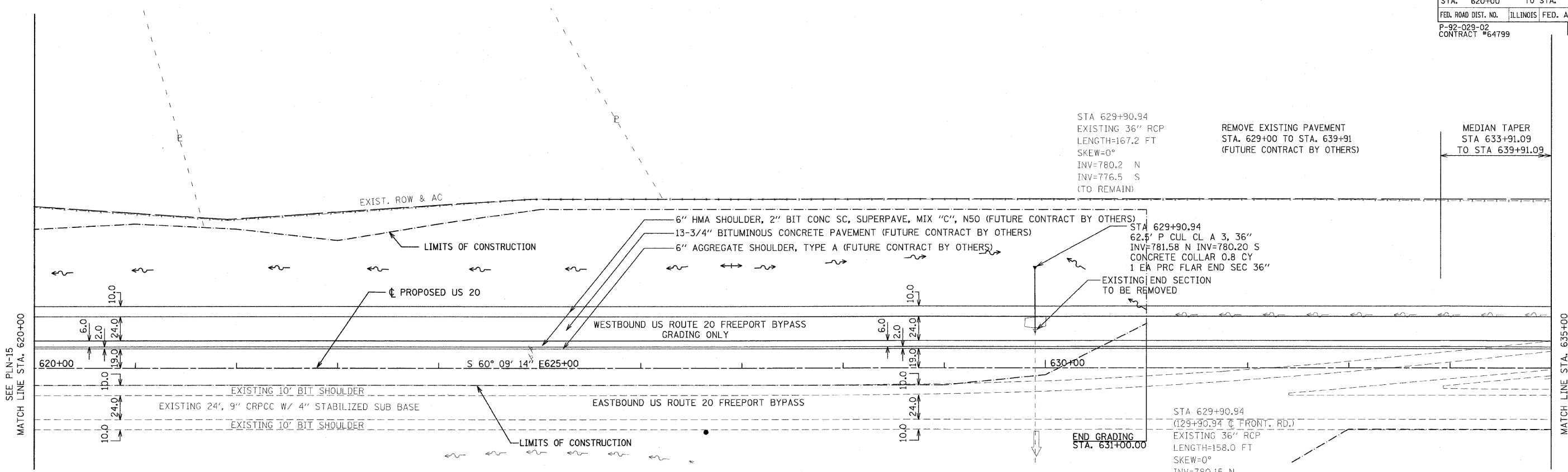

REVISIONS	NAME	DATE

ILLINOIS DEPARTMENT OF TRANSPORTATION  
 F.A.P. ROUTE 301 (US RTE. 20)  
 FROM BOLTON ROAD TO WEST OF IL RTE. 26

PLAN AND PROFILE  
 WESTBOUND U.S. ROUTE 20

SCALE: VERT. 1"=50'  
 HORIZ. 1"=50'

DATE: 01-22-10

DRAWN BY RMH  
 CHECKED BY DM