

MATCH LINE STA 14+00  
SEE SHEET 76

EXIST. CURVE RC57B  
PI STA. = 11+62.44  
Δ = 30° 00' 00" (RT)  
D = 15° 00' 00"  
R = 381.97'  
T = 102.35'  
L = 200.00'  
E = 13.47'  
EX & PR S.E. = 8.0% (35 MPH DESIGN)  
P.C. STA. = 10+60.09  
P.T. STA. = 12+60.09

EXIST. CURVE RC57A  
PI STA. = 9+12.05  
Δ = 22° 30' 00" (RT)  
D = 7° 30' 00"  
R = 763.94'  
T = 151.96'  
L = 300.00'  
E = 14.97'  
EX & PR S.E. = 8.0% (50 MPH DESIGN)  
P.C. STA. = 7+60.09  
P.T. STA. = 10+60.09  
S.E. ATTAINED:  
STA 6+02.09 TO STA 8+10.09

EXIST. CURVE C2  
PI STA. = 101+50.75  
Δ = 39° 42' 50" (RT)  
D = 2° 00' 00"  
R = 2,864.79'  
T = 1,034.60'  
L = 1,985.69'  
E = 181.10'  
EX & PR S.E. = 6.0% (70 MPH DESIGN)  
T.R. = 38.60'  
S.E. RUN = 270.00'  
P.C. STA. = 91+16.15  
P.T. STA. = 111+01.84  
S.E. ATTAINED:  
STA 88+97.55 TO STA 92+06.15  
STA 110+11.84 TO STA 113+20.44

FOR IL RTE 57 IMPROVEMENTS  
SEE SHEETS 80-85

SEE SHEETS 102-118  
FOR S.N. 001-0064  
BRIDGE REPAIR DETAILS

SEE SHEETS 102-118  
FOR S.N. 001-0065  
BRIDGE REPAIR DETAILS

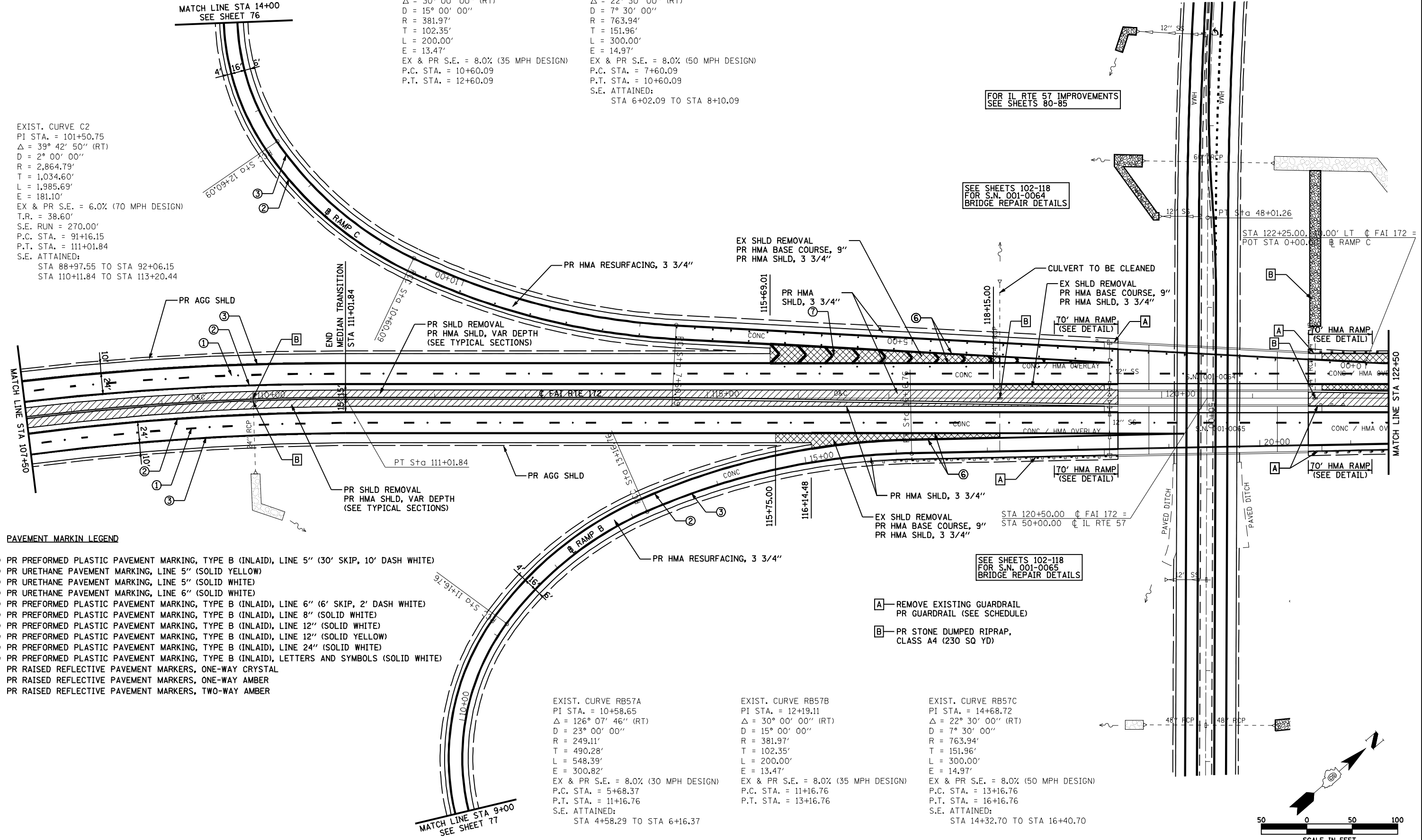

**PAVEMENT MARKING LEGEND**

- ① PR PREFORMED PLASTIC PAVEMENT MARKING, TYPE B (INLAID), LINE 5" (30' SKIP, 10' DASH WHITE)
- ② PR URETHANE PAVEMENT MARKING, LINE 5" (SOLID YELLOW)
- ③ PR URETHANE PAVEMENT MARKING, LINE 5" (SOLID WHITE)
- ④ PR URETHANE PAVEMENT MARKING, LINE 6" (SOLID WHITE)
- ⑤ PR PREFORMED PLASTIC PAVEMENT MARKING, TYPE B (INLAID), LINE 6" (6' SKIP, 2' DASH WHITE)
- ⑥ PR PREFORMED PLASTIC PAVEMENT MARKING, TYPE B (INLAID), LINE 8" (SOLID WHITE)
- ⑦ PR PREFORMED PLASTIC PAVEMENT MARKING, TYPE B (INLAID), LINE 12" (SOLID WHITE)
- ⑧ PR PREFORMED PLASTIC PAVEMENT MARKING, TYPE B (INLAID), LINE 12" (SOLID YELLOW)
- ⑨ PR PREFORMED PLASTIC PAVEMENT MARKING, TYPE B (INLAID), LINE 24" (SOLID WHITE)
- ⑩ PR PREFORMED PLASTIC PAVEMENT MARKING, TYPE B (INLAID), LETTERS AND SYMBOLS (SOLID WHITE)
- ▶ PR RAISED REFLECTIVE PAVEMENT MARKERS, ONE-WAY CRYSTAL
- ▶ PR RAISED REFLECTIVE PAVEMENT MARKERS, ONE-WAY AMBER
- ◆ PR RAISED REFLECTIVE PAVEMENT MARKERS, TWO-WAY AMBER

- A REMOVE EXISTING GUARDRAIL  
PR GUARDRAIL (SEE SCHEDULE)
- B PR STONE DUMPED RIPRAP,  
CLASS A4 (230 SQ YD)

EXIST. CURVE RB57A  
PI STA. = 10+58.65  
Δ = 126° 07' 46" (RT)  
D = 23° 00' 00"  
R = 249.11'  
T = 490.28'  
L = 548.39'  
E = 300.82'  
EX & PR S.E. = 8.0% (30 MPH DESIGN)  
P.C. STA. = 5+68.37  
P.T. STA. = 11+16.76  
S.E. ATTAINED:  
STA 4+58.29 TO STA 6+16.37

EXIST. CURVE RB57B  
PI STA. = 12+19.11  
Δ = 30° 00' 00" (RT)  
D = 15° 00' 00"  
R = 381.97'  
T = 102.35'  
L = 200.00'  
E = 13.47'  
EX & PR S.E. = 8.0% (35 MPH DESIGN)  
P.C. STA. = 11+16.76  
P.T. STA. = 13+16.76

EXIST. CURVE RB57C  
PI STA. = 14+68.72  
Δ = 22° 30' 00" (RT)  
D = 7° 30' 00"  
R = 763.94'  
T = 151.96'  
L = 300.00'  
E = 14.97'  
EX & PR S.E. = 8.0% (50 MPH DESIGN)  
P.C. STA. = 13+16.76  
P.T. STA. = 16+16.76  
S.E. ATTAINED:  
STA 14+32.70 TO STA 16+40.70

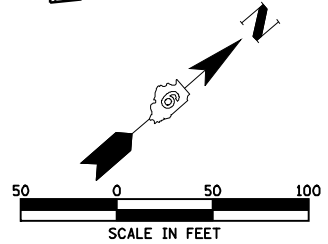

FILE NAME =	USER NAME = laughlinr1	DESIGNED -	REVISED -	<b>STATE OF ILLINOIS DEPARTMENT OF TRANSPORTATION</b>	<b>FAI RTE 172 PLAN</b>			F.A.I RTE.	SECTION	COUNTY	TOTAL SHEETS	SHEET NO.	
es:\pwork\p\WIDOT\LAUGHLINRL\0182983\047_Plan.dgn		DRAWN -	REVISED -		SCALE: 1"=50'	SHEET NO. 9	OF 52 SHEETS	STA. 107+50	TO STA. 122+50	172	1-(1,2,3,4,5)RS	ADAMS	165 47
PLOT SCALE = 100.0000' / IN.		CHECKED -	REVISED -		CONTRACT NO. 72A09								
PLOT DATE = Feb-01-2010 09:35:19AM		DATE -	REVISED -		FED. ROAD DIST. NO. ILLINOIS FED. AID PROJECT								