

EXIST. CURVE C6
 PI STA. = 181+71.55
 $\Delta = 82^\circ 07' 42''$ (RT)
 $D = 2^\circ 00' 00''$
 $R = 2,864.79'$
 $T = 2,495.96'$
 $L = 4,106.41'$
 $E = 934.79'$
 EX & PR S.E. = 6.0% (70 MPH DESIGN)
 T.R. = 38.60'
 S.E. RUN = 270.00'
 P.C. STA. = 156+75.59
 P.T. STA. = 197+82.00
 S.E. ATTAINED:
 STA 154+56.99 TO STA 157+65.59
 STA 196+92.00 TO STA 33+06.18

SEE SHEETS 135-151
 FOR S.N. 001-0062
 BRIDGE REPAIR DETAILS

A REMOVE EXISTING GUARDRAIL
 PR GUARDRAIL (SEE SCHEDULE)

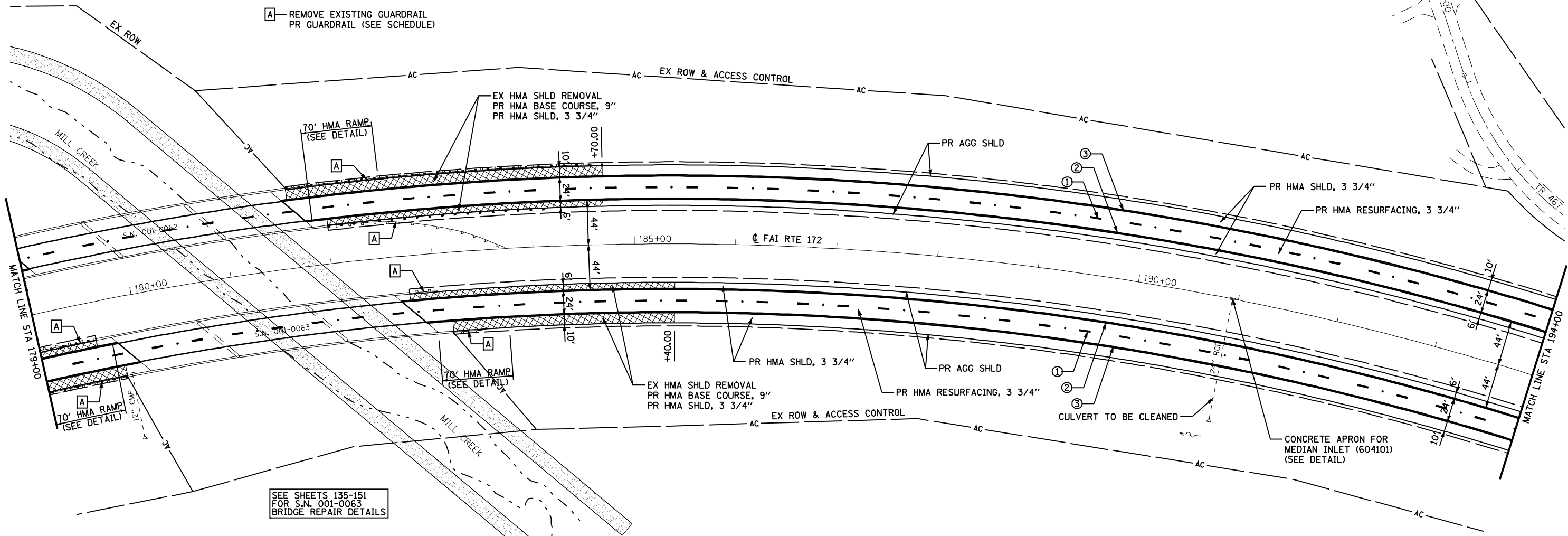

SEE SHEETS 135-151
 FOR S.N. 001-0063
 BRIDGE REPAIR DETAILS

PAVEMENT MARKING LEGEND

- ① PR PREFORMED PLASTIC PAVEMENT MARKING, TYPE B (INLAID), LINE 5" (30' SKIP, 10' DASH WHITE)
- ② PR URETHANE PAVEMENT MARKING, LINE 5" (SOLID YELLOW)
- ③ PR URETHANE PAVEMENT MARKING, LINE 5" (SOLID WHITE)
- ④ PR URETHANE PAVEMENT MARKING, LINE 6" (SOLID WHITE)
- ⑤ PR PREFORMED PLASTIC PAVEMENT MARKING, TYPE B (INLAID), LINE 6" (6' SKIP, 2' DASH WHITE)
- ⑥ PR PREFORMED PLASTIC PAVEMENT MARKING, TYPE B (INLAID), LINE 8" (SOLID WHITE)
- ⑦ PR PREFORMED PLASTIC PAVEMENT MARKING, TYPE B (INLAID), LINE 12" (SOLID WHITE)
- ⑧ PR PREFORMED PLASTIC PAVEMENT MARKING, TYPE B (INLAID), LINE 12" (SOLID YELLOW)
- ⑨ PR PREFORMED PLASTIC PAVEMENT MARKING, TYPE B (INLAID), LINE 24" (SOLID WHITE)
- ⑩ PR PREFORMED PLASTIC PAVEMENT MARKING, TYPE B (INLAID), LETTERS AND SYMBOLS (SOLID WHITE)
- ▷ PR RAISED REFLECTIVE PAVEMENT MARKERS, ONE-WAY CRYSTAL
- ▶ PR RAISED REFLECTIVE PAVEMENT MARKERS, ONE-WAY AMBER
- ◆ PR RAISED REFLECTIVE PAVEMENT MARKERS, TWO-WAY AMBER

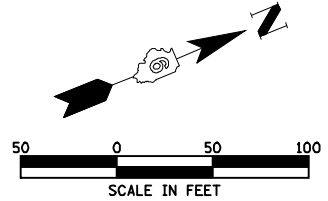

FILE NAME =	USER NAME = laughlinr1	DESIGNED -	REVISED -
es:\pwwork\pwwid07\LAUGHLINRL\0182983\071.Plan.dgn		DRAWN -	REVISED -
PLOT SCALE = 100.0000' / IN.		CHECKED -	REVISED -
PLOT DATE = Feb-01-2010 09:36:26AM		DATE -	REVISED -

STATE OF ILLINOIS
 DEPARTMENT OF TRANSPORTATION

FAI RTE 172 PLAN

SCALE: 1"=50' SHEET NO. 33 OF 52 SHEETS STA. 179+00 TO STA. 194+00

F.A.I. RTE.	SECTION	COUNTY	TOTAL SHEETS	SHEET NO.
172	1-(1,2,3,4,5)RS	ADAMS	165	71
CONTRACT NO. 72A09				
FED. ROAD DIST. NO. ILLINOIS FED. AID PROJECT				