

OVERHEAD S.N. 001-0044 CLEARANCES

LOCATION	SOUTHBOUND LANE			NORTHBOUND LANE		
	EOP	CL	EOP	EOP	CL	EOP
IL 96	18.31'	18.03'	18.01'	16.72'	16.44'	16.39'
NORTH BEAM	18.31'	18.03'	18.01'	16.72'	16.44'	16.39'
SOUTH BEAM	18.73'	18.45'	18.48'	16.94'	16.65'	16.69'

NOTE:
PRIOR TO RESURFACING ACTIVITIES, THE CONTRACTOR AND THE ENGINEER SHALL VERIFY AND DOCUMENT THE EXISTING MINIMUM VERTICAL CLEARANCE AT ALL OVERHEAD STRUCTURES. IF NECESSARY, THE ENGINEER WILL MAKE ADJUSTMENTS TO THE RESURFACING THICKNESS SHOWN IN THE PLANS. UPON COMPLETION OF THE RESURFACING, THE ENGINEER WILL MEASURE AND DOCUMENT THE MINIMUM VERTICAL CLEARANCE AT ALL OVERHEAD STRUCTURES. IF THE MINIMUM VERTICAL CLEARANCE IS LESS THAN 16'-0", THE CONTRACTOR SHALL REMOVE AND REPLACE THE HOT-MIX ASPHALT SURFACE COURSE AS DIRECTED BY THE ENGINEER. THE COST OF THIS WORK OR ANY INCONVENIENCE CAUSED BY COMPLYING WITH THIS REQUIREMENT WILL NOT BE PAID FOR SEPARATELY, BUT SHALL BE INCLUDED IN THE COST OF THE RESURFACING PAY ITEMS IN THIS CONTRACT.

EXIST. CURVE RD96B
PI STA. = 10+13.71
 $\Delta = 42^\circ 08' 07''$ (RT)
D = 7° 30' 00"
R = 763.94'
T = 294.28'
L = 561.80'
E = 54.72'
EX & PR S.E. = 8.0% (50 MPH DESIGN)
P.C. STA. = 7+19.43
P.T. STA. = 12+81.23
S.E. ATTAINED:
STA 5+91.42 TO STA 8+47.42
STA 11+48.22 TO STA 13+56.22

EXIST. CURVE RD96A
PI STA. = 3+61.42
 $\Delta = 27^\circ 35' 21''$ (LT)
D = 11° 27' 33"
R = 500.00'
T = 122.76'
L = 240.76'
E = 14.85'
EX & PR S.E. = 8.0% (40 MPH DESIGN)
P.C. STA. = 2+38.66
P.T. STA. = 4+79.42
S.E. ATTAINED:
STA 1+19.41 TO STA 2+98.29
STA 3+71.26 TO STA 5+91.42

SEE SHEETS 158-161 FOR S.N. 001-0044 BRIDGE REPAIR DETAILS

PR STONE DUMPED RIPRAP, CLASS A4 (50 SQ YD) (SEE DETAIL)

STA 56+09.43 @ FAI 172 =
STA 50+00.00 @ IL RTE 96

PR STONE DUMPED RIPRAP, CLASS A4 (50 SQ YD) (SEE DETAIL)

A PCC SURFACE REMOVAL, VARIABLE DEPTH (PAVEMENT)
HMA SURFACE REMOVAL, VARIABLE DEPTH (SHOULDERS)
(SEE DETAIL)

FOR IL RTE 96 IMPROVEMENTS SEE SHEETS 86-90

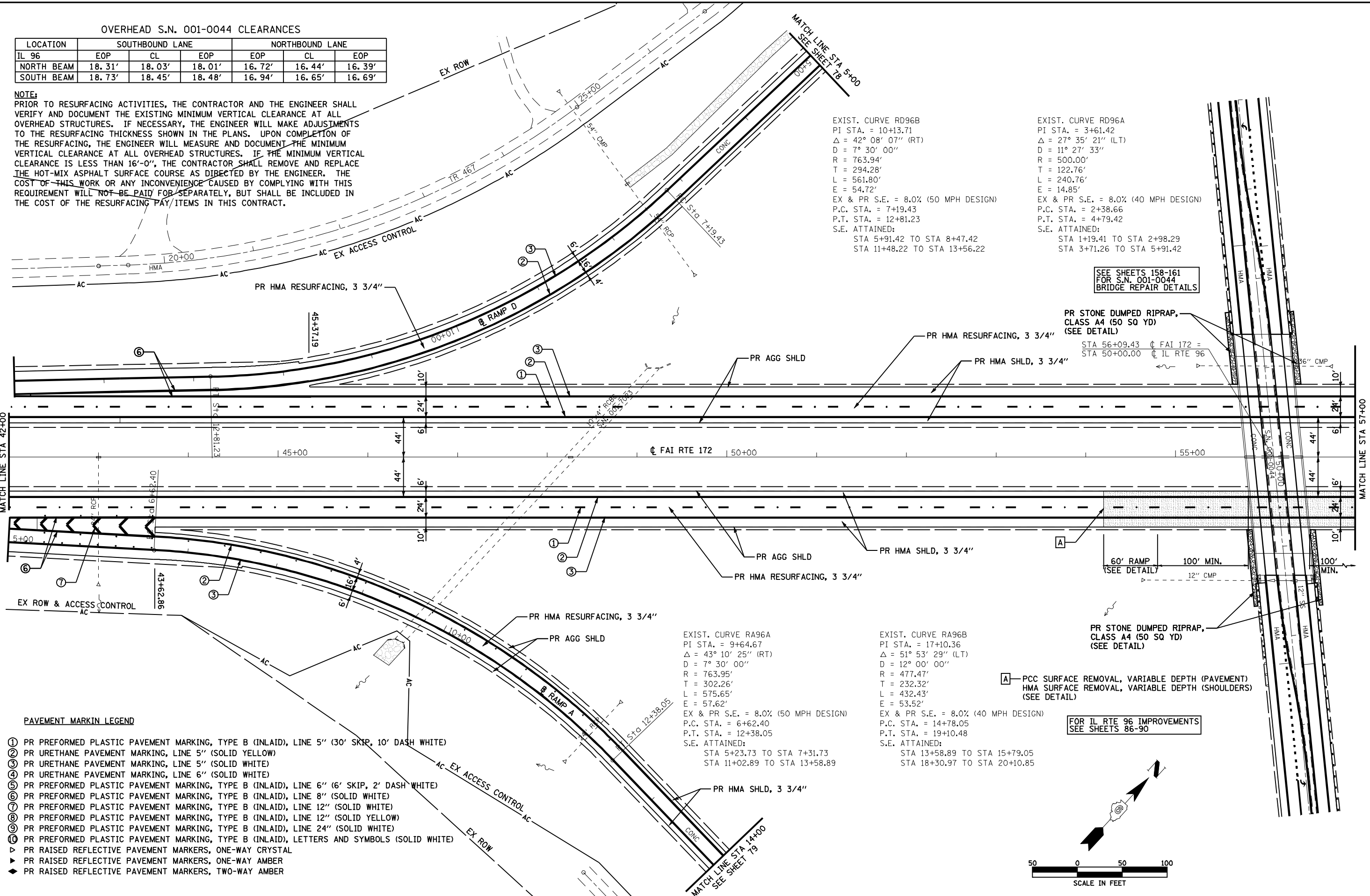

PAVEMENT MARKIN LEGEND

- ① PR PREFORMED PLASTIC PAVEMENT MARKING, TYPE B (INLAID), LINE 5" (30' SKIP, 10' DASH WHITE)
- ② PR URETHANE PAVEMENT MARKING, LINE 5" (SOLID YELLOW)
- ③ PR URETHANE PAVEMENT MARKING, LINE 5" (SOLID WHITE)
- ④ PR URETHANE PAVEMENT MARKING, LINE 6" (SOLID WHITE)
- ⑤ PR PREFORMED PLASTIC PAVEMENT MARKING, TYPE B (INLAID), LINE 6" (6' SKIP, 2' DASH WHITE)
- ⑥ PR PREFORMED PLASTIC PAVEMENT MARKING, TYPE B (INLAID), LINE 8" (SOLID WHITE)
- ⑦ PR PREFORMED PLASTIC PAVEMENT MARKING, TYPE B (INLAID), LINE 12" (SOLID WHITE)
- ⑧ PR PREFORMED PLASTIC PAVEMENT MARKING, TYPE B (INLAID), LINE 12" (SOLID YELLOW)
- ⑨ PR PREFORMED PLASTIC PAVEMENT MARKING, TYPE B (INLAID), LINE 24" (SOLID WHITE)
- ⑩ PR PREFORMED PLASTIC PAVEMENT MARKING, TYPE B (INLAID), LETTERS AND SYMBOLS (SOLID WHITE)
- ▷ PR RAISED REFLECTIVE PAVEMENT MARKERS, ONE-WAY CRYSTAL
- ▼ PR RAISED REFLECTIVE PAVEMENT MARKERS, ONE-WAY AMBER
- ◆ PR RAISED REFLECTIVE PAVEMENT MARKERS, TWO-WAY AMBER

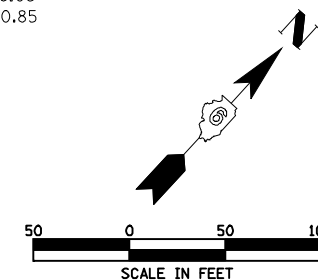

FILE NAME =	USER NAME = laughlinr1	DESIGNED -	REVISED -
es:\pwork\PWIDOT\LAUGHLINRL\0182983\073_Plan.dgn		DRAWN -	REVISED -
		CHECKED -	REVISED -
		DATE -	REVISED -

**STATE OF ILLINOIS
DEPARTMENT OF TRANSPORTATION**

FAI RTE 172 PLAN

SCALE: 1"=50' SHEET NO. 35 OF 52 SHEETS STA. 42+00 TO STA. 57+00

F.A.I. RTE.	SECTION	COUNTY	TOTAL SHEETS	SHEET NO.
172	1-(1,2,3,4,5)RS	ADAMS	165	73
CONTRACT NO. 72A09				
FED. ROAD DIST. NO. ILLINOIS FED. AID PROJECT				