

EXIST. CURVE RD57B
 PI STA. = 20+37.70
 $\Delta = 28^\circ 25' 39''$ (RT)
 $D = 7^\circ 30' 00''$
 $R = 763.94'$
 $T = 193.50'$
 $L = 379.03'$
 $E = 24.13'$
 EX & PR S.E. = 8.0% (50 MPH DESIGN)
 P.C. STA. = 18+44.20
 P.T. STA. = 22+23.23
 S.E. ATTAINED:
 STA 16+04.20 TO STA 19+08.20
 STA 20+59.19 TO STA 25+07.19

EXIST. CURVE RD57A
 PI STA. = 9+88.79
 $\Delta = 52^\circ 55' 30''$ (LT)
 $D = 16^\circ 47' 48''$
 $R = 341.11'$
 $T = 169.79'$
 $L = 315.09'$
 $E = 39.92'$
 EX & PR S.E. = 8.0% (35 MPH DESIGN)
 P.C. STA. = 8+19.00
 P.T. STA. = 11+34.09
 S.E. ATTAINED:
 STA 7+07.00 TO STA 8+75.00
 STA 10+78.09 TO STA 12+46.09

EXIST. CURVE RC57B
 PI STA. = 11+62.44
 $\Delta = 30^\circ 00' 00''$ (RT)
 $D = 15^\circ 00' 00''$
 $R = 381.97'$
 $T = 102.35'$
 $L = 200.00'$
 $E = 13.47'$
 EX & PR S.E. = 8.0% (35 MPH DESIGN)
 P.C. STA. = 10+60.09
 P.T. STA. = 12+60.09

EXIST. CURVE RC57C
 PI STA. = 17+90.17
 $\Delta = 129^\circ 39' 28''$ (RT)
 $D = 23^\circ 00' 00''$
 $R = 249.11'$
 $T = 530.08'$
 $L = 563.73'$
 $E = 336.59'$
 EX & PR S.E. = 8.0% (30 MPH DESIGN)
 P.C. STA. = 12+60.09
 P.T. STA. = 18+23.82
 S.E. ATTAINED:
 STA 17+75.82 TO STA 19+33.90

PAVEMENT MARKIN LEGEND

- ① PR PREFORMED PLASTIC PAVEMENT MARKING, TYPE B (INLAID), LINE 5" (30' SKIP, 10' DASH WHITE)
- ② PR URETHANE PAVEMENT MARKING, LINE 5" (SOLID YELLOW)
- ③ PR URETHANE PAVEMENT MARKING, LINE 5" (SOLID WHITE)
- ④ PR URETHANE PAVEMENT MARKING, LINE 6" (SOLID WHITE)
- ⑤ PR PREFORMED PLASTIC PAVEMENT MARKING, TYPE B (INLAID), LINE 6" (6' SKIP, 2' DASH WHITE)
- ⑥ PR PREFORMED PLASTIC PAVEMENT MARKING, TYPE B (INLAID), LINE 8" (SOLID WHITE)
- ⑦ PR PREFORMED PLASTIC PAVEMENT MARKING, TYPE B (INLAID), LINE 12" (SOLID WHITE)
- ⑧ PR PREFORMED PLASTIC PAVEMENT MARKING, TYPE B (INLAID), LINE 12" (SOLID YELLOW)
- ⑨ PR PREFORMED PLASTIC PAVEMENT MARKING, TYPE B (INLAID), LINE 24" (SOLID WHITE)
- ⑩ PR PREFORMED PLASTIC PAVEMENT MARKING, TYPE B (INLAID), LETTERS AND SYMBOLS (SOLID WHITE)
- ▶ PR RAISED REFLECTIVE PAVEMENT MARKERS, ONE-WAY CRYSTAL
- ▶ PR RAISED REFLECTIVE PAVEMENT MARKERS, ONE-WAY AMBER
- ◆ PR RAISED REFLECTIVE PAVEMENT MARKERS, TWO-WAY AMBER

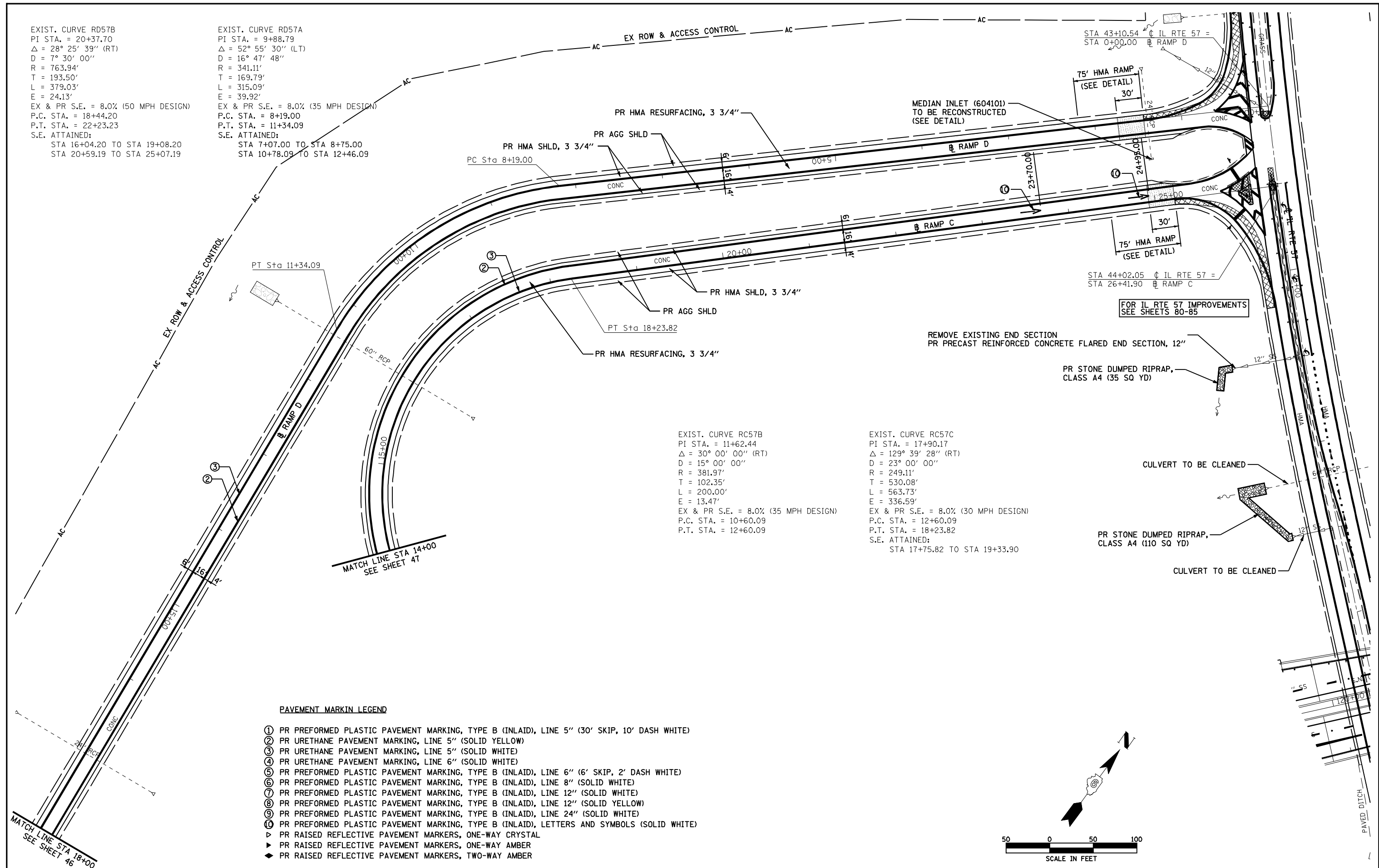
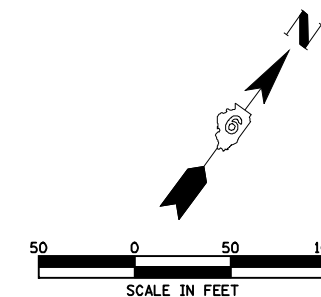

FILE NAME =	USER NAME = laughlinr1	DESIGNED -	REVISED -
es:\pwork\pwidot\LAUGHLINRL\0182983\076_Plan_IL57_Ramps.dgn		DRAWN -	REVISED -
	PLOT SCALE = 100.0000' / IN.	CHECKED -	REVISED -
	PLOT DATE = Feb-01-2010 09:36:40AM	DATE -	REVISED -

**STATE OF ILLINOIS
 DEPARTMENT OF TRANSPORTATION**

IL RTE 57 INTERCHANGE RAMPS C & D PLAN

SCALE: 1"=50' SHEET NO. 38 OF 52 SHEETS STA. TO STA.

F.A.I. RTE.	SECTION	COUNTY	TOTAL SHEETS	SHEET NO.
172	1-(1,2,3,4,5)RS	ADAMS	165	76
CONTRACT NO. 72A09				
FED. ROAD DIST. NO.	ILLINOIS FED. AID PROJECT			