

Notes:
 Hatched areas indicate concrete removal.
 For Sections A-A & B-B, bar details & Bill of Material see sheet No. 12 of 17.
 Care shall be taken to not damage name plate.

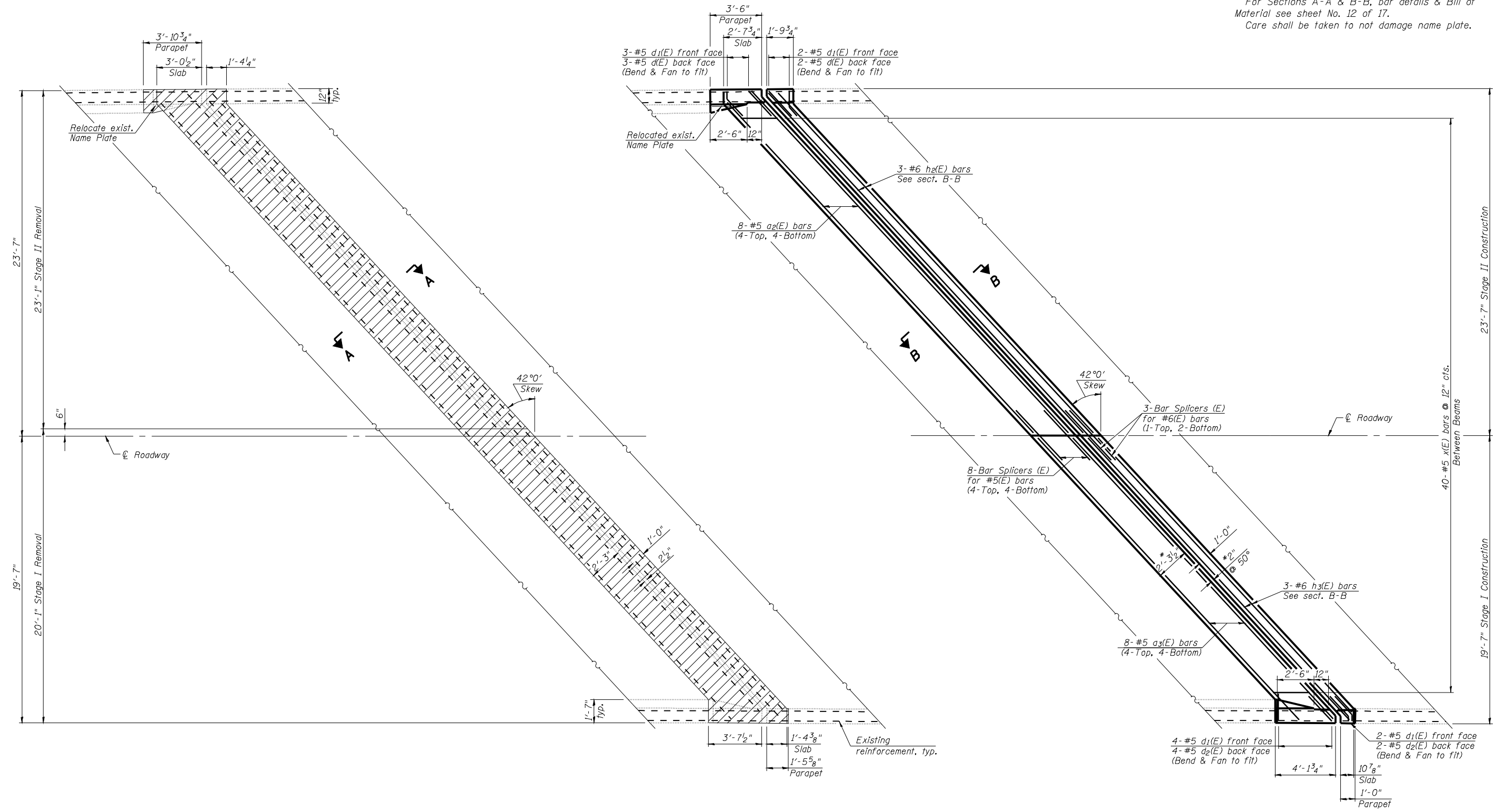

PARTIAL REMOVAL PLAN
 (North Abutment SN 001-0062)

PARTIAL PROPOSED PLAN
 (North Abutment SN 001-0062)

ABUTMENT DETAILS
FAI 172 OVER MILL CREEK
SN 001-0062 & 0063

DESIGNED	KTH
CHECKED	ADL
DRAWN	KTH
CHECKED	ADL

KLINGNER & ASSOCIATES, P.C.
 Engineers - Architects - Surveyors
 155 North 21st Street, Barrington, IL 60010
 4300 Paces Green, Round Rock, TX 78681
 400 N. 4th Street, Suite 100, Burlington, IL 60109
 111 West 1st Street, Galena, IL 60131
 Internet Address: www.klingner.com
 Ph: (815) 221-3030 Fax: (815) 221-3882
 Ph: (512) 753-9536 Fax: (512) 752-3885
 Ph: (815) 342-4842 Fax: (815) 342-3781
 STATE OF ILLINOIS DESIGN FIRM # 1842738

SHEET NO. 8	F.A. RTE.	SECTION	COUNTY	TOTAL SHEETS	SHEET NO.
	172	1-4B-1	ADAMS	165	142
17 SHEETS			CONTRACT NO. 72A09		
FED. ROAD DIST. NO.		ILLINOIS FED. AID PROJECT			