

EXIST. CURVE I55N-4
 PI STA. = 683+95.97
 $\Delta = 0^\circ 24' 33''$ (RT)
 $D = 0^\circ 02' 00''$
 $R = 171,887.30'$
 $T = 613.75'$
 $L = 1,227.50'$
 $E = 1.10'$
 $e = \text{-----}$
 T.R. = -----
 S.E. RUN = -----
 P.C. STA. = 677+82.22
 P.T. STA. = 690+09.72

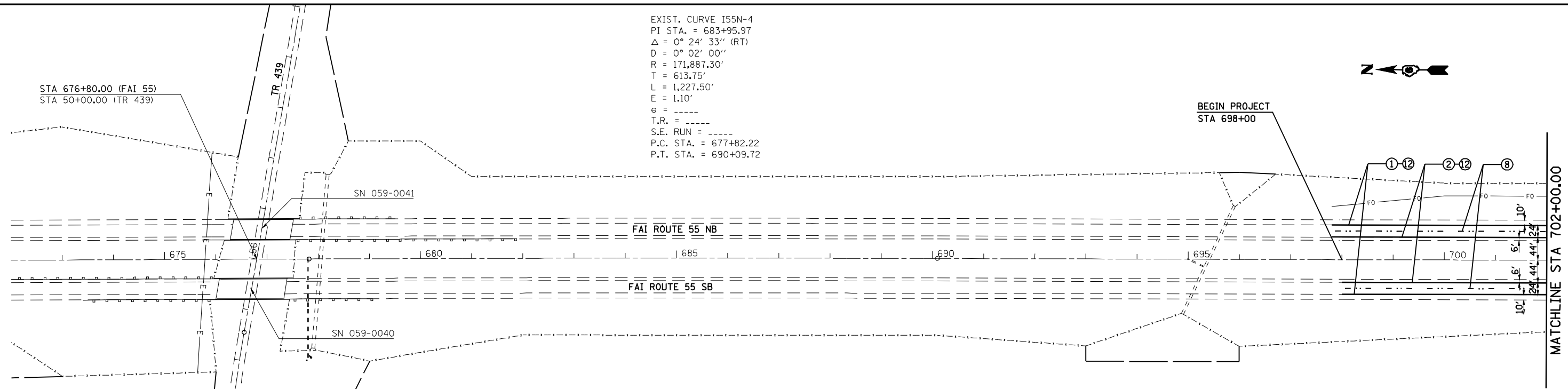

PAVEMENT MARKING LEGEND		
①	URETHANE PAVEMENT MARKING - LINE 5"	(SOLID WHITE LINE)
②	URETHANE PAVEMENT MARKING - LINE 5"	(YELLOW)
③	PREFORMED PLASTIC PAVEMENT MARKING, TYPE B-INLAID - 6"	(SOLID WHITE LINE)
④	URETHANE PAVEMENT MARKING - LINE 5"	(WHITE SKIP DASH)
⑤	URETHANE PAVEMENT MARKING - LINE 8"	(SOLID WHITE LINE)
⑥	URETHANE PAVEMENT MARKING - LINE 12"	(SOLID WHITE LINE)
⑦	PREFORMED PLASTIC PAVEMENT MARKING, TYPE B-INLAID - LETTER AND SYMBOLS	(WHITE SYMBOLS)
⑧	PREFORMED PLASTIC PAVEMENT MARKING, TYPE B-INLAID - 5"	(WHITE SKIP DASH)
⑨	PREFORMED PLASTIC PAVEMENT MARKING, TYPE B-INLAID - 8"	(SOLID WHITE LINE)
⑩	PREFORMED PLASTIC PAVEMENT MARKING, TYPE B-INLAID - 24"	(SOLID WHITE LINE)
⑪	URETHANE PAVEMENT MARKING - LINE 12"	(SOLID YELLOW LINE)
⑫	GROOVING FOR RECESSED PAVEMENT MARKING 6"	
⑬	PREFORMED PLASTIC PAVEMENT MARKING, TYPE B-INLAID - 12"	(SOLID WHITE LINE)

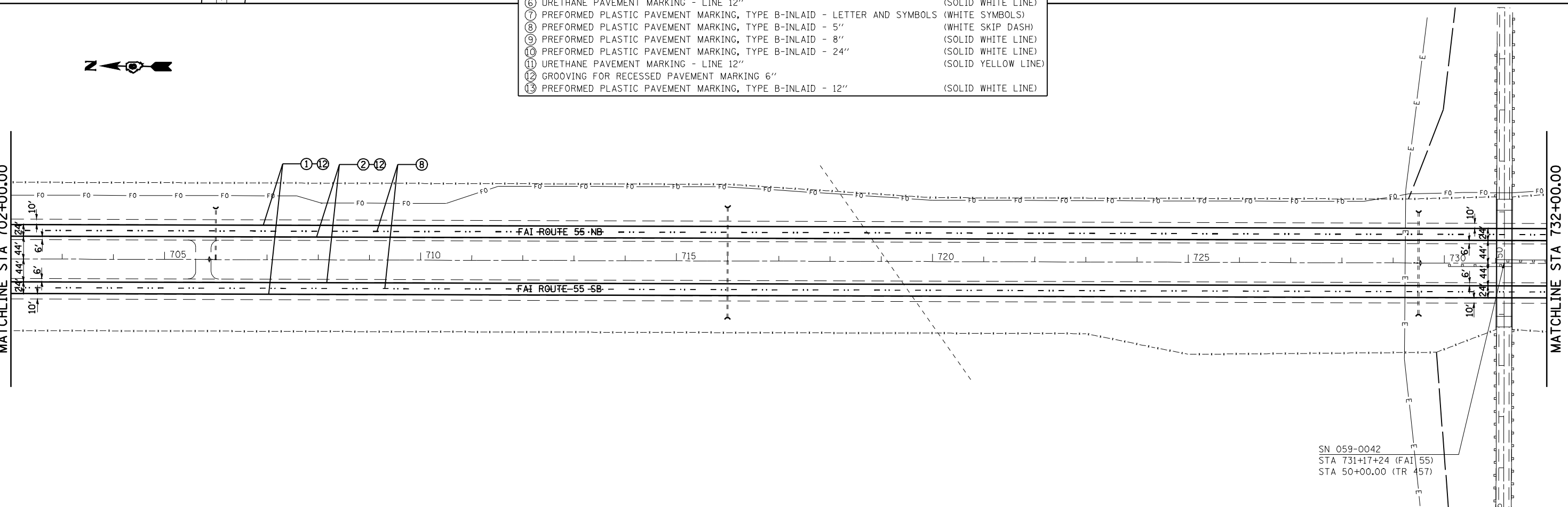

FILE NAME =	USER NAME = coxte	DESIGNED -	REVISED -	STATE OF ILLINOIS DEPARTMENT OF TRANSPORTATION	PAVEMENT MARKING PLAN SHEETS			F.A.I. RTE. 55	SECTION 59RS-2, BR	COUNTY MACOUPIN	TOTAL SHEETS 100	SHEET NO. 42
es:\pwork\PWID0T\COXTE\dms25312\0672A00-shs-pmk.dgn		DRAWN -	REVISED -		SCALE: 1" = 100'	SHEET NO.	OF SHEETS	STA.	TO STA. 732+00.00	ILLINOIS FED. AID PROJECT		
		CHECKED -	REVISED -							CONTRACT NO. 72A60		
		DATE -	REVISED -							CONTRACT NO. 72A60		