

CONTRACT NO. 76D61	
F.A. ROUTE	SECTION
999	82-1B-2
FED. AID PROJECT	ILLINOIS
COUNTY	ST. CLAIR
USER NAME = John Keeven	
PLOT SCALE = 50.0000' / IN.	
PLOT DATE = 4/14/2010	
DESIGNED	HNTB
CHECKED	CMT
DRAWN	CMT / HNTB
REVISED	-
REVISED	-
REVISED	-
REVISED	-

**PROPOSED PLAN
ACCESS ROADS**

ILLINOIS APPROACH STRUCTURE
FOR NEW I-70 MISSISSIPPI RIVER BRIDGE

STA. 47 + 00 TO STA. 56 + 50

**STATE OF ILLINOIS
DEPARTMENT OF TRANSPORTATION**

**MISSOURI HIGHWAYS
AND TRANSPORTATION COMMISSION**

HNTB

715 KIRK DRIVE
KANSAS CITY, MO 64105
TELEPHONE (816) 472-1201
CERTIFICATE OF AUTHORITY
NO. 001270

CMT

CRAWFORD, MURPHY & TILLY, INC.
2750 WEST WASHINGTON STREET
SPRINGFIELD, IL 62702
TELEPHONE (217) 787-8050
ENGINEERING CORPORATION - 000631

GENERAL NOTE:
CONTRACTOR SHALL CONTACT NORFOLK SOUTHERN (NS),
TERMINAL RAILROAD ASSOCIATION OF ST. LOUIS (TRRA),
KANSAS CITY SOUTHERN RAILWAY (KCS) AND UNION
PACIFIC RAILWAY COMPANY (UP) DIRECTLY FOR LOCATION
OF RAILROAD UTILITIES ON RAILROAD RIGHT-OF-WAY.

▨ TREE REMOVAL
X TREE REMOVAL UNITS

SEE SHEET NO. 24
ACCESS ROAD 1
MATCH LINE STA 47+00

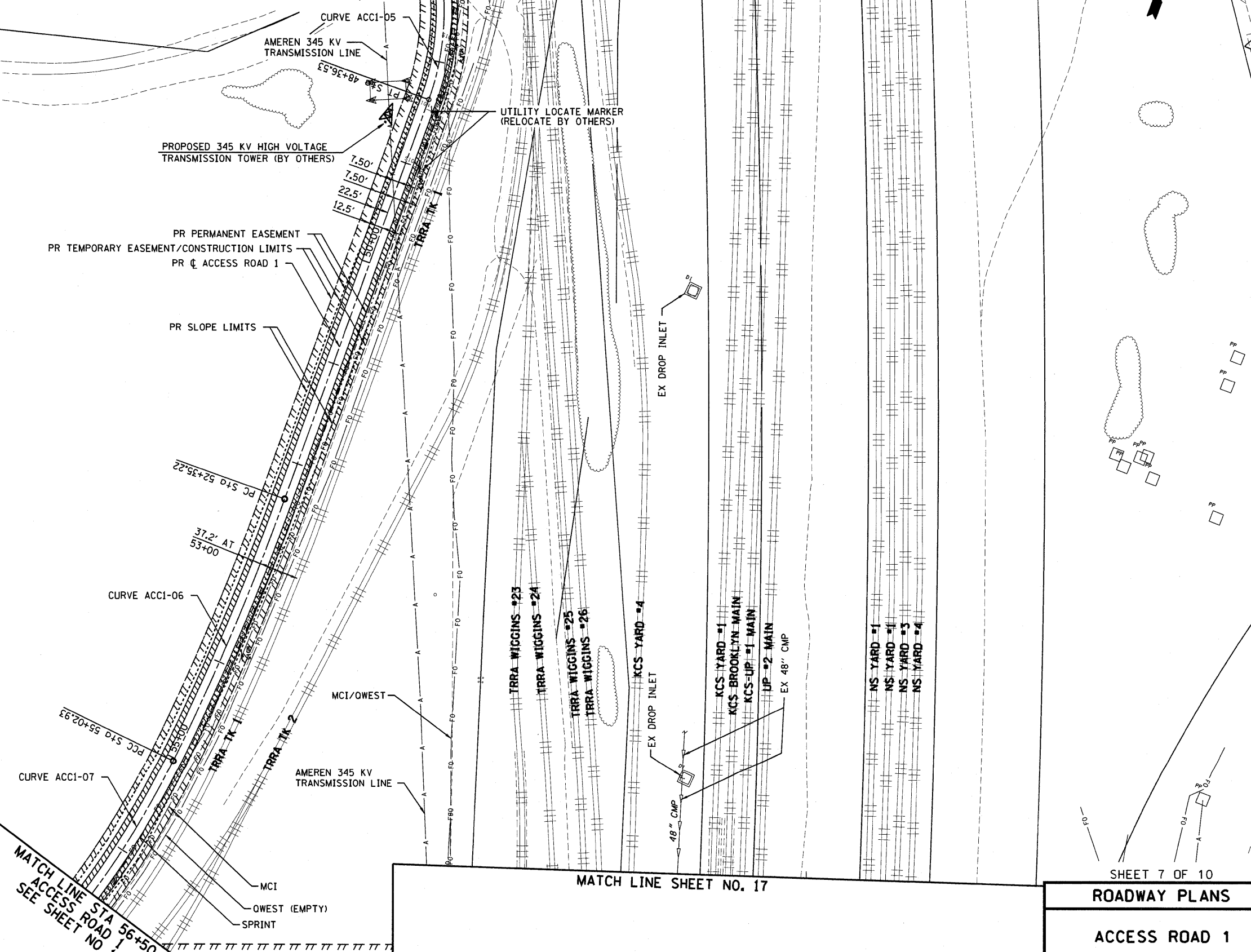

MATCH LINE SHEET NO. 17

SHEET 7 OF 10
ROADWAY PLANS

ACCESS ROAD 1