

**CURVE NO. 1**  
 PI STA. = 214+02.52  
 $\Delta = 42^\circ 38' 12''$   
 $D = 6^\circ 30' 00''$   
 $R = 881.47'$   
 $T = 344.00'$   
 $L = 655.95'$   
 $E = 64.75'$   
 $e = 0.050' /'$   
 P.C. STA. = 210+58.52  
 P.T. STA. = 217+14.47

**CURVE NO. 2**  
 PI STA. = 225+15.23  
 $\Delta = 41^\circ 27' 05''$   
 $D = 4^\circ 29' 56''$   
 $R = 1,273.57'$   
 $T = 481.89'$   
 $L = 921.38'$   
 $E = 88.12'$   
 $e = 0.035' /'$   
 P.C. STA. = 220+33.34  
 P.T. STA. = 229+54.72

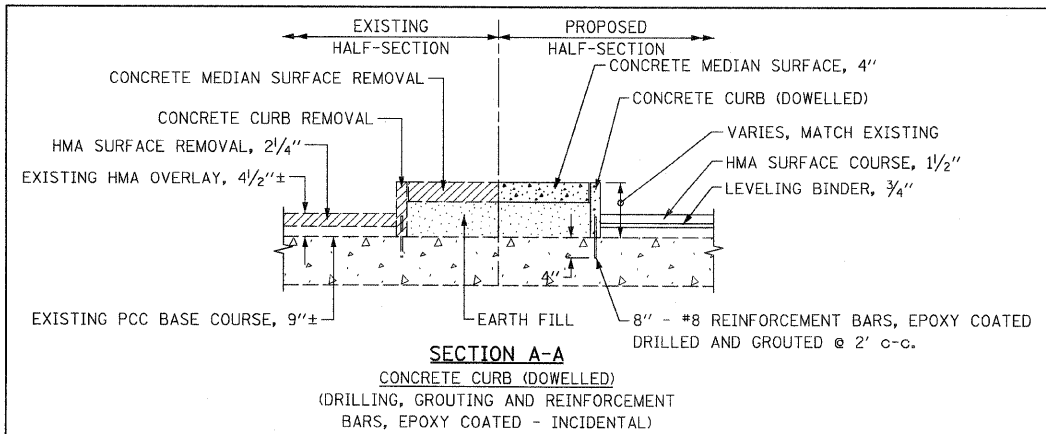
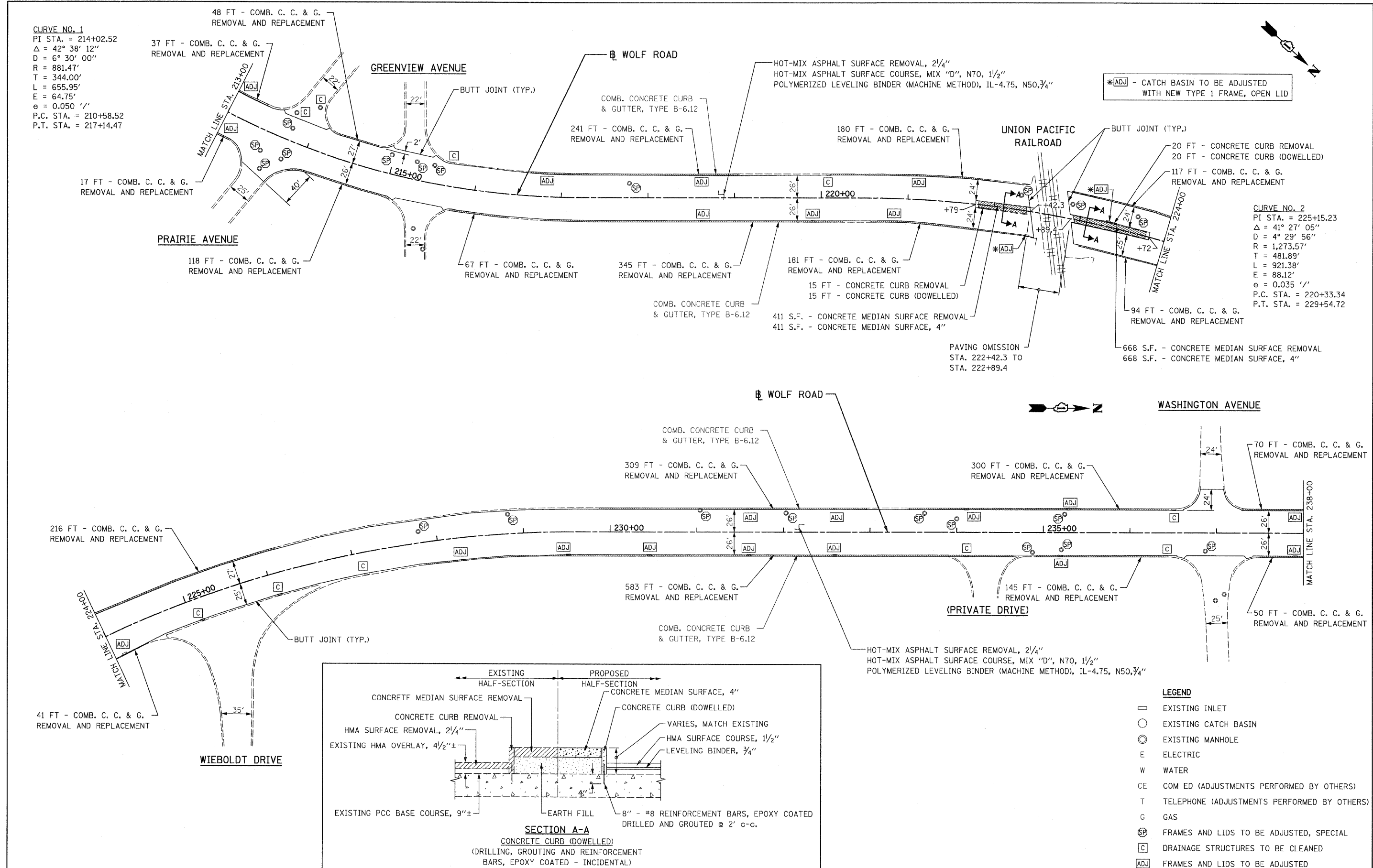

FILE NAME = 0168F49-shr-plot05.dgn  
 PLOT DATE = 3/30/2009

**CHRISTIAN-ROGE & ASSOCIATES, INC.**  
 ENGINEERS-PLANNERS-SURVEYORS  
 211 WEST WACKER DRIVE  
 CHICAGO, ILLINOIS 60606  
 PHONE: (312)372-2023 FAX: (312)372-5274

DESIGNED - G.F.L.	REVISED -
DRAWN - B.K.	REVISED -
CHECKED - M.P.	REVISED -
DATE - MARCH 2009	REVISED -

**STATE OF ILLINOIS**  
**DEPARTMENT OF TRANSPORTATION**

**ROADWAY PLAN**  
**WOLF ROAD ( IL 72 (TOUHY AVENUE) TO IL 58 (GOLF ROAD) )**

SCALE: 1" = 50' SHEET NO. 5 OF 6 SHEETS STA. 213+00 TO STA. 243+00

F.A.U. RTE.	SECTION	COUNTY	TOTAL SHEETS	NO.
2691	3134 RS-3	COOK	33	10
CONTRACT NO. 60F49				
FED. ROAD DIST. NO. 1 ILLINOIS FED. AID PROJECT				