

**PAVEMENT IMPROVEMENTS:**

HOT-MIX ASPHALT SURFACE REMOVAL, 2 1/2"  
 POLYMERIZED LEVELING BINDER (MACHINE METHOD), IL-4.75, N50, 3/4" - 1"  
 HOT-MIX ASPHALT SURFACE COURSE, MIX "D", N70, 1 1/2"

**NOTES:**

PERMANENT PAVEMENT MARKING SHALL BE THERMOPLASTIC (OF THE EXTRUDED TYPE) AND SHOULD BE PLACED IN ACCORDANCE WITH "DISTRICT ONE TYPICAL PAVEMENT MARKING DETAILS"  
 RAISED REFLECTIVE PAVEMENT MARKERS SHALL BE IN ACCORDANCE WITH THE DISTRICT ON "TYPICAL APPLICATION RAISED REFLECTIVE PAVEMENT MARKERS DETAILS"

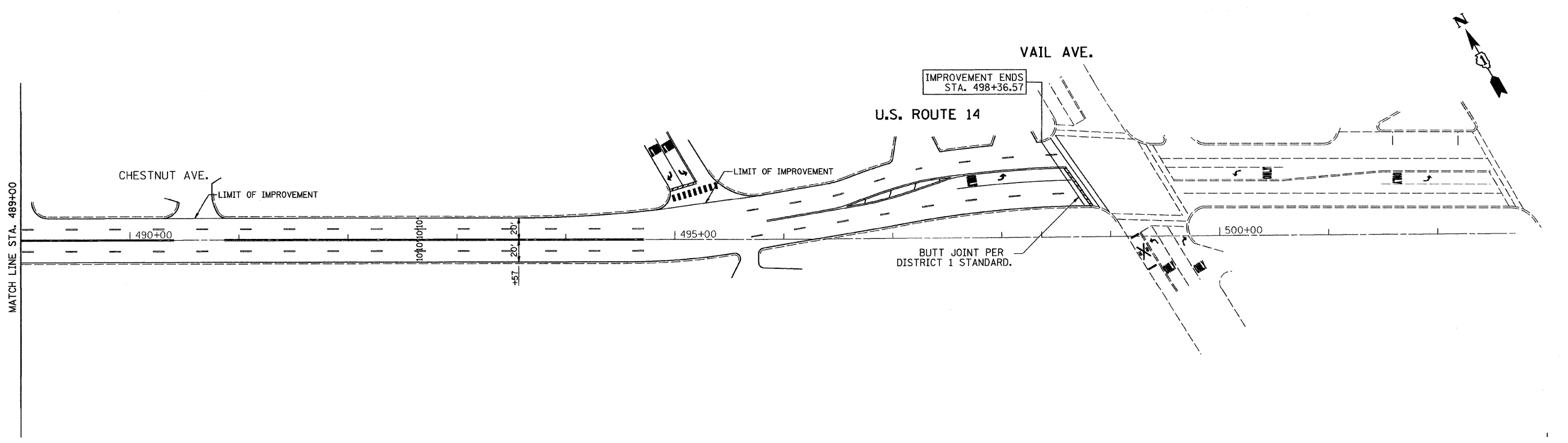

FILE NAME = ...\\p1ans\p1ans1709pp&mk06.dgn	USER NAME = gthesse	DESIGNED - TJR	REVISED -
		DRAWN - IS	REVISED -
		CHECKED - JAS	REVISED -
		DATE - 4/16/09	REVISED -

**STATE OF ILLINOIS  
 DEPARTMENT OF TRANSPORTATION**

**ROADWAY AND PAVEMENT MARKING  
 US 14 - HICKS ROAD TO VAIL AVENUE**

SCALE: 1"=50' SHEET NO. OF SHEETS STA. 475+00 TO STA. 501+65

F.A. RTE.	SECTION	COUNTY	TOTAL SHEETS	SHEET NO.
3512	(88 Y & 88-1Y)RS-4	COOK	22	10
FED. ROAD DIST. NO. [ILLINOIS] FED. AID PROJECT			CONTRACT NO. 60661	