

CONTRACT NO.		TOTAL SHEETS		SHEET NO.	
F.A. RTE.	SECTION	COUNTY			
STA.		TO STA.			
FED. ROAD DIST. NO.		ILLINOIS FED. AID PROJECT			

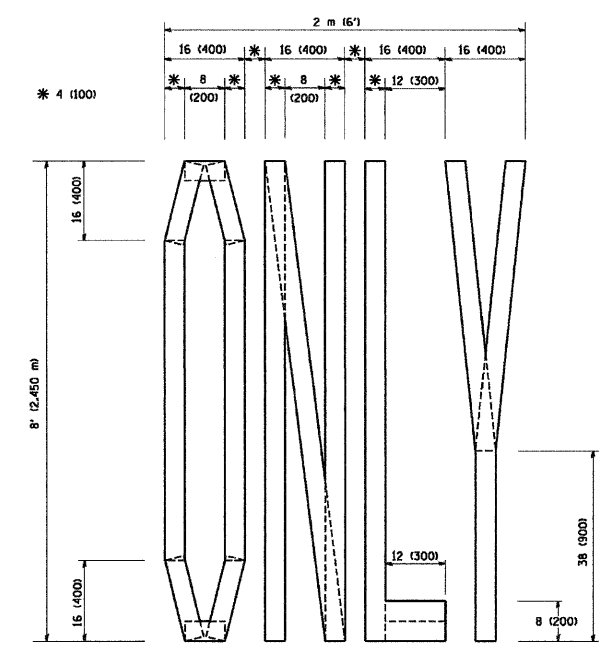

QUANTITY  
 4 (100) LINE = 64.1 ft. (19.7 m)  
 21.1 sq. ft. (1.97 sq. m)

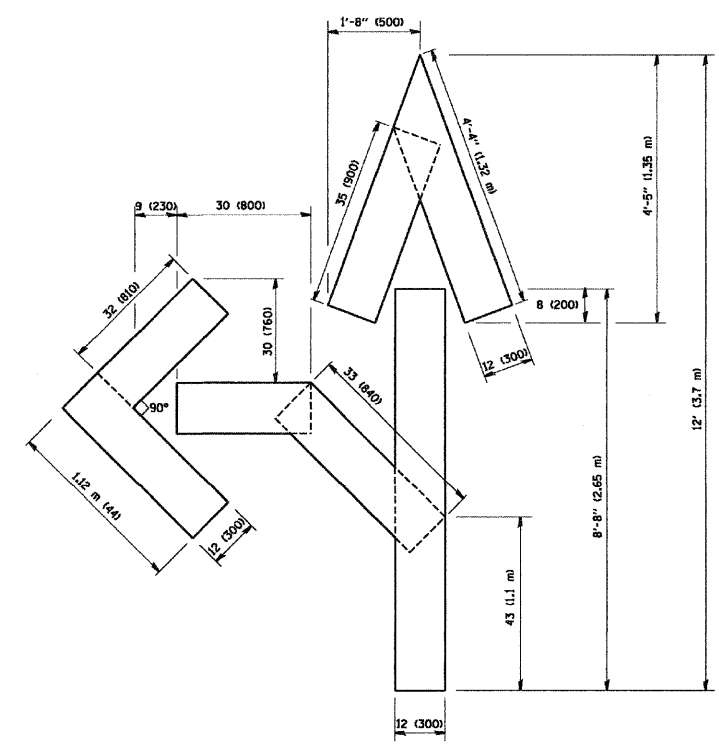

QUANTITY  
 4 (100) LINE = 82.5 ft. (25.3 m)  
 27.5 sq. ft. (2.53 sq. m)

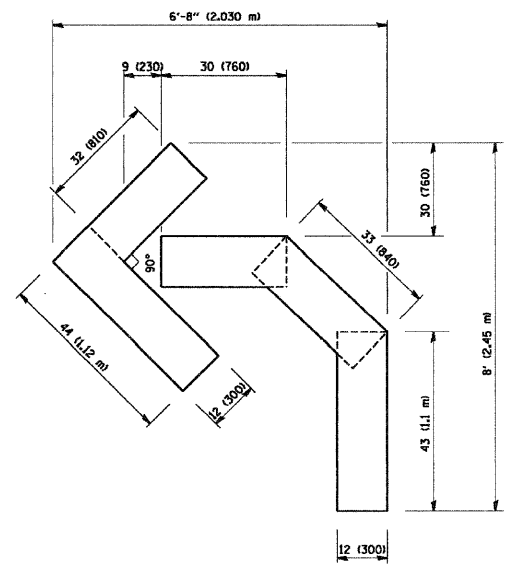

QUANTITY  
 4 (100) LINE = 45.5 ft. (13.9 m)  
 15.2 sq. ft. (1.39 sq. m)

All dimensions are in Inches (millimeters) unless otherwise shown.

REVISIONS	
NAME	DATE
T. RAMMACHER	09/18/94
J. OBERLE	06/01/96
T. RAMMACHER	06/05/96
T. RAMMACHER	11/04/97
T. RAMMACHER	03/02/98
E. GOMEZ	08/28/00

ILLINOIS DEPARTMENT OF TRANSPORTATION  
**PAVEMENT MARKING LETTERS AND SYMBOLS FOR TRAFFIC STAGING**

SCALE: NONE

DRAWN BY CADD  
 CHECKED BY TC-16

PLOT DATE = 4/17/2009  
 FILE NAME = K:\data\m\101\dgn  
 PLOT SCALE = 1/8" = 1'-0"  
 USER NAME = gthesse

FILE NAME = ...p\1-51709_01st1_0et09.dgn	USER NAME = gthesse	DESIGNED -	REVISED -	<b>STATE OF ILLINOIS DEPARTMENT OF TRANSPORTATION</b>	<b>PAVEMENT MARKING LETTERS AND SYMBOLS FOR TRAFFIC STAGING</b>				F.A. RTE. 3512	SECTION 88 Y & 88-1Y/RS-4	COUNTY COOK	TOTAL SHEETS 22	SHEET NO. 19
PLOT SCALE = N.T.S.	CHECKED -	REVISED -	REVISED -		SCALE: SHEET NO. OF SHEETS STA. TO STA.				CONTRACT NO. 60G61				
PLOT DATE = 4/17/2009	DATE -	REVISED -	REVISED -						ILLINOIS FED. AID PROJECT				