

**LEGEND:**

- 1 THERMOPLASTIC PAVEMENT MARKING - LINE 4" (DOUBLE YELLOW SOLID LINE 11" C-C)
- 2 THERMOPLASTIC PAVEMENT MARKING - LINE 4" (WHITE LANE LINE - 10' DASH, 30' SKIP) WITH RAISED REFLECTIVE PAVEMENT MARKERS (2 ONE-WAY CRYSTAL MARKER) (80' C-C)
- 3 THERMOPLASTIC PAVEMENT MARKING - LINE 6" (WHITE SOLID LINE)
- 4 THERMOPLASTIC PAVEMENT MARKING - LINE 6" (WHITE LANE LINE - 2' DASH, 6' SKIP)
- 5 THERMOPLASTIC PAVEMENT MARKING - LINE 12" (YELLOW DIAGONAL LINE)
- 6 THERMOPLASTIC PAVEMENT MARKING - LINE 12" (WHITE LINE)
- 7 THERMOPLASTIC PAVEMENT MARKING - LINE 24" (WHITE STOP LINE)
- 8 THERMOPLASTIC PAVEMENT MARKING - LETTERS AND SYMBOLS (TYP.)
- 9 RAISED REFLECTIVE PAVEMENT MARKERS (ONE-WAY AMBER MARKER) (40' C-C)
- 10 RAISED REFLECTIVE PAVEMENT MARKERS (TWO-WAY AMBER MARKER) (40' C-C)
- 11 RAISED REFLECTIVE PAVEMENT MARKERS (ONE-WAY CRYSTAL MARKER) (40' C-C)

HOT-MIX ASPHALT SURFACE REMOVAL - BUTT JOINT  
TEMPORARY RAMP

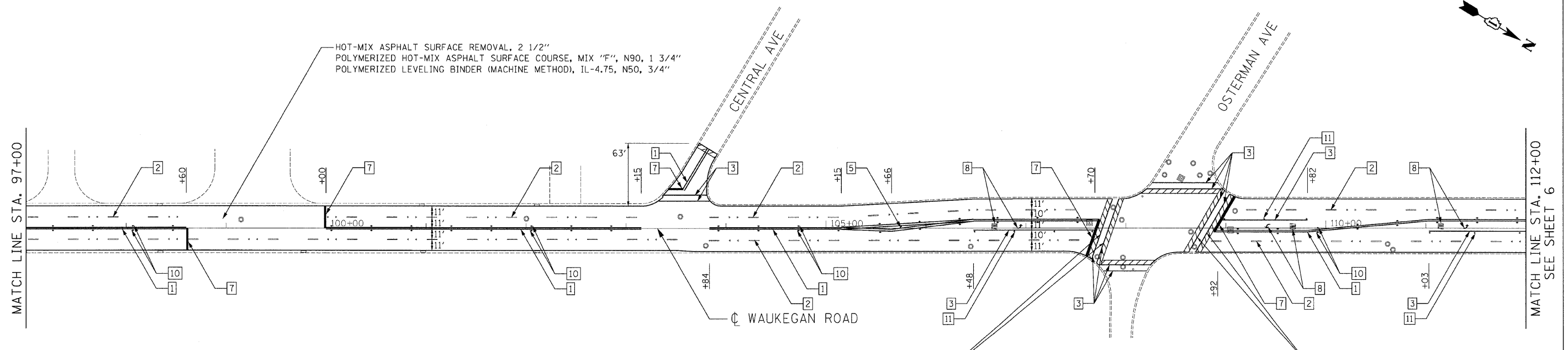
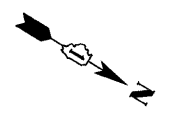

HOT-MIX ASPHALT SURFACE REMOVAL - BUTT JOINT  
TEMPORARY RAMP

FILE NAME = m:\p\proj\3366\3366\_18\design\proposed\plan\3366\_18-Prop01.dgn

**Ciorba Group, Inc.**  
CONSULTING ENGINEERS  
5507 North Cumberland Avenue, Suite 402  
Chicago, Illinois 60656  
Tel. 773.775.4009 Fax 773.775.4014

USER NAME = alou	DESIGNED - AL	REVISED -
PLOT SCALE = 50.0000' / IN.	DRAWN - RJR	REVISED -
PLOT DATE = 4/16/2009	CHECKED - WBL	REVISED -
	DATE - 4/22/2009	REVISED -

**STATE OF ILLINOIS  
DEPARTMENT OF TRANSPORTATION**

**IL 43 /WAUKEGAN ROAD  
0.2 MILES SOUTH OF CENTRAL AVENUE TO NORTH AVENUE  
PROPOSED ROADWAY AND PAVEMENT MARKING PLAN**  
SCALE: 1"=50' SHEET NO. 5 OF 25 SHEETS STA. 85+00 TO STA. 112+00

F.A.U. RTE.	SECTION	COUNTY	TOTAL SHEETS	SHEET NO.
2706	AY-RS-2	LAKE	25	5
CONTRACT NO. 60671				
FED. ROAD DIST. NO. 1 [ILLINOIS] FED. AID PROJECT				