

**SYMBOLS LEGEND**

- RAISED REFLECTIVE PAVEMENT MARKER (TWO - WAY AMBER)
- RAISED REFLECTIVE PAVEMENT MARKER (ONE - WAY AMBER)
- RAISED REFLECTIVE PAVEMENT MARKER (ONE - WAY CRYSTAL)
- MANHOLE STRUCTURE (APPROXIMATE LOCATION)
- DRAINAGE STRUCTURE (APPROXIMATE LOCATION)

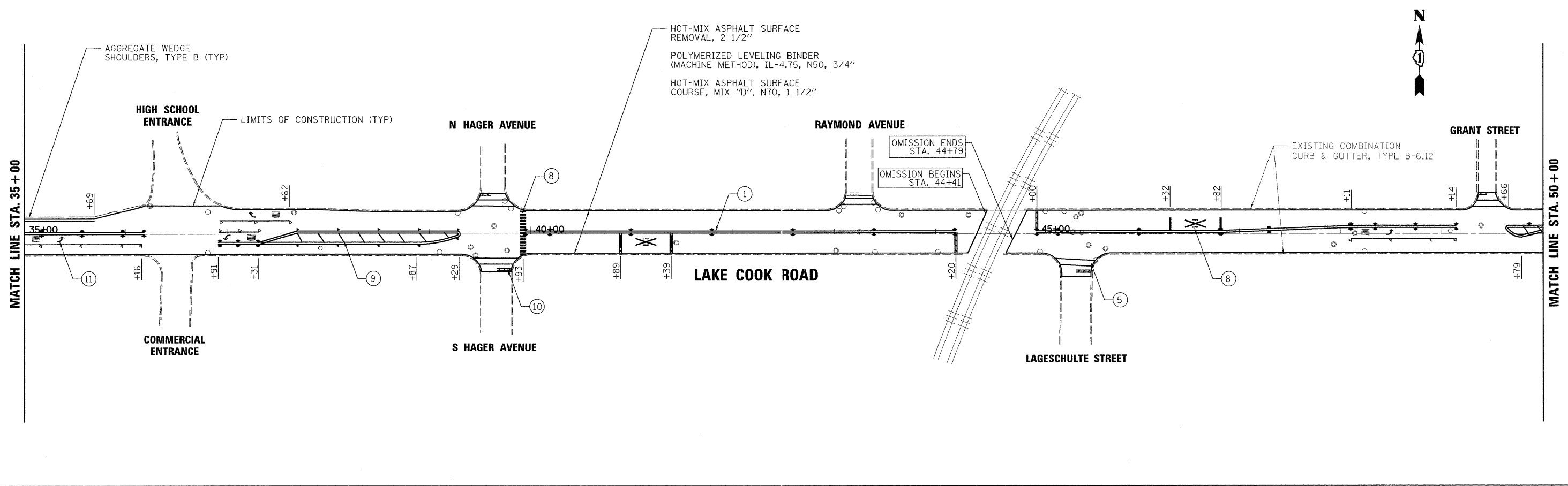

PLOT DATE = 4/16/2009  
 FILE NAME = H:\112251\Lake-cook-road\road\sheet\lakecook-21.dgn  
 PLOT SCALE = 1:50  
 PLOT NAME = Default  
 MODEL =

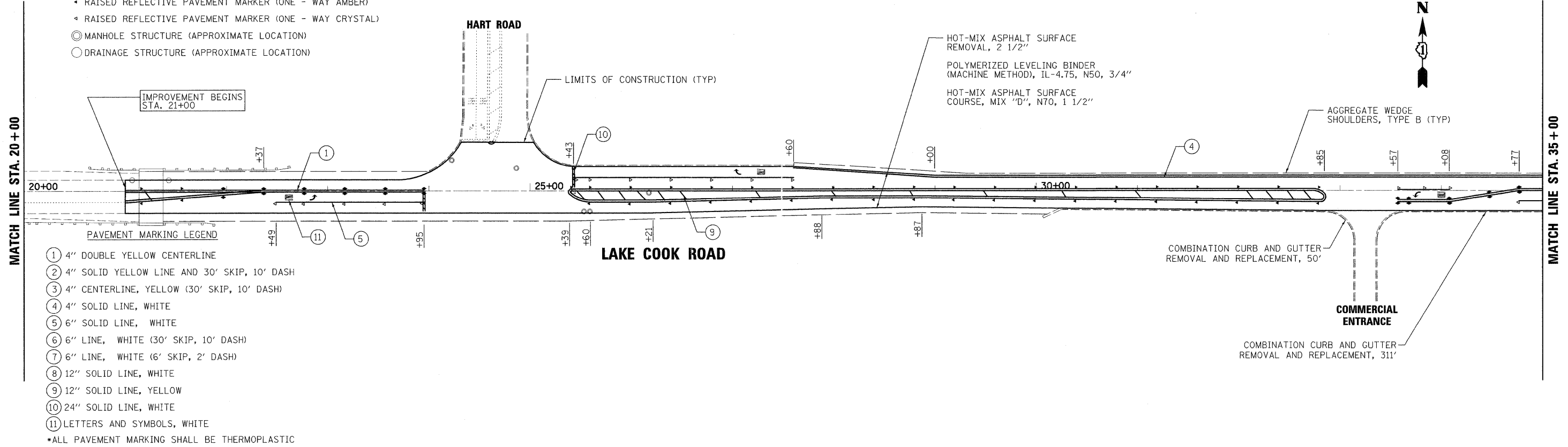

200 West Front Street  
Wheaton, IL 60187

DESIGNED - MAK	REVISED -
DRAWN - JMT	REVISED -
CHECKED - BLB	REVISED -
DATE - 4/16/2009 1:31:20 PM	REVISED -

**STATE OF ILLINOIS  
DEPARTMENT OF TRANSPORTATION**

**LAKE COOK ROAD**

**PLAN AND  
PAVEMENT MARKING DETAILS**

SCALE: 1"=50' SHEET NO. 6 OF 30 SHEETS STA.20+00 TO STA.50+00

F.A.P. RTE.	SECTION	COUNTY	TOTAL SHEETS	SHEET NO.
1270	0506 RS-12	LAKE	30	6
CONTRACT NO.60H02				
FED. ROAD DIST. NO. 1   ILLINOIS   FED. AID PROJECT				