

**TRAFFIC SIGNAL LEGEND**

	PROPOSED	EXISTING
DETECTOR LOOP		
SIGNAL HEAD		
G.S. CONDUIT IN TRENCH OR PUSHED		
SIGNAL HEAD WITH BACKPLATE		
RACEWAY FOR MAGNETIC DETECTOR, TYPE I OR II		
VEHICLE DETECTOR, NON-COMPENSATED MAGNETIC TYPE		

RESURFACING LIMIT

**SPECIAL DETAIL: LATERAL PLACEMENT OF DETECTOR LOOPS**

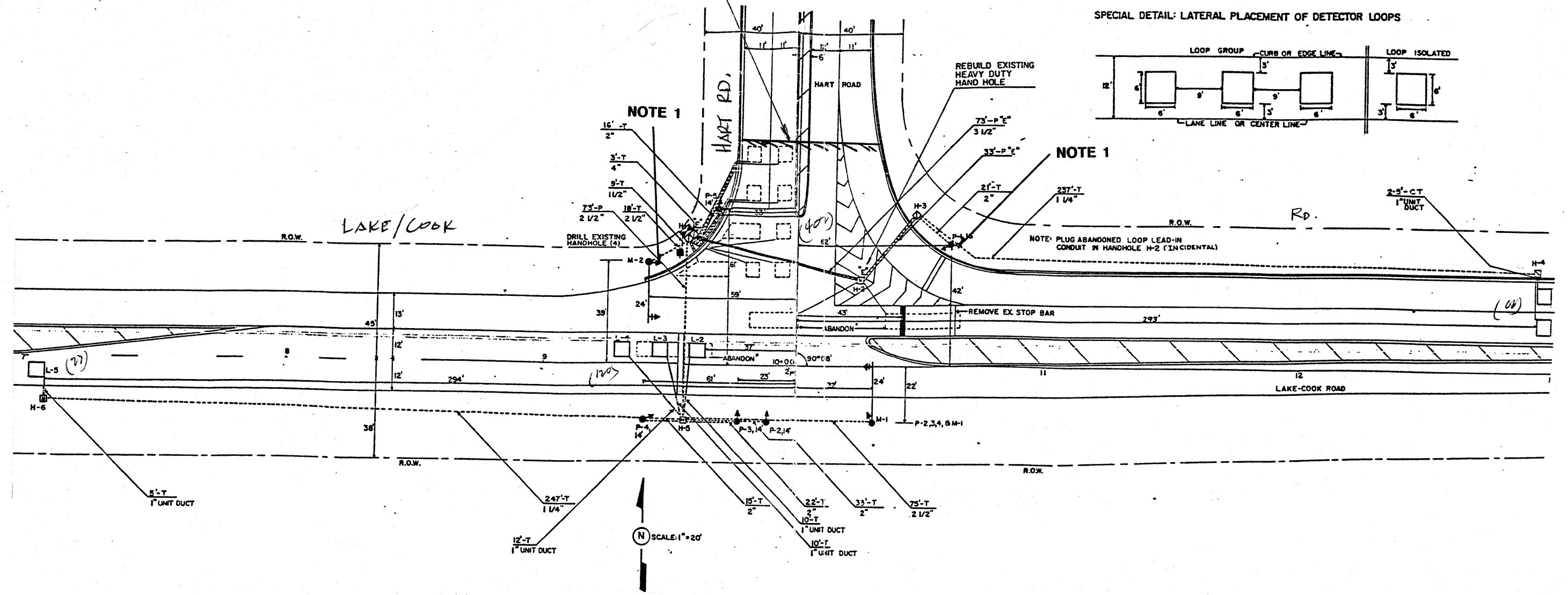
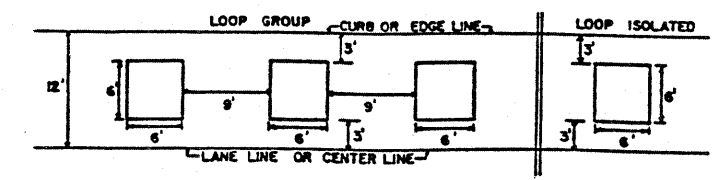

THIS PLAN IS FOR THE SOLE PURPOSE OF DETECTOR LOOP REPLACEMENTS ONLY

REPLACE ALL DETECTOR LOOPS AS SHOWN (WITHIN THE RESURFACING LIMITS)

CODE	QUANTITY	UNIT	ITEM
86600600	615	FOOT	DETECTOR LOOP, REPLACEMENT

FILE NAME =	USER NAME = kenthaphixaybc	DESIGNED - BCK	REVISED -
ct:\pwwork\pwwid\KANTHAPHIXAYBC\d01126	ct:\pwwork\pwwid\KANTHAPHIXAYBC\d01126	DRAWN - BCK	REVISED -
	PLLOT SCALE = 3/4" = 1' IN.	CHECKED - DAD	REVISED -
	PLLOT DATE = 4/3/2009	DATE -	REVISED -

**STATE OF ILLINOIS**  
**DEPARTMENT OF TRANSPORTATION**

**DISTRICT ONE - DETECTOR LOOP REPLACEMENT**  
**LAKE / COOK ROAD @ HART ROAD**

F.A. RTE.	SECTION	COUNTY	TOTAL SHEETS	SHEET NO.
1270	0506 RS-12	COOK	30	14
SCALE: NONE		SHEET NO. OF SHEETS		STA. TO STA.
FED. ROAD DIST. NO. (ILLINOIS) FED. AID PROJECT				