

INDEX OF SHEETS

- COVER SHEET
- COMMITMENTS, GENERAL NOTES,
JOB SPECIFIC NOTES
- SUMMARY OF QUANTITIES
- TYPICAL SECTIONS
- TABULATION OF RESURFACING
QUANTITIES
- TABULATION OF PAVEMENT
MARKING QUANTITIES
- SCHEDULES OF QUANTITIES
- ALIGNMENT, TIES. AND
BENCHMARKS
- LINE DIAGRAM
- PAVEMENT MARKING DETAILS
- DISTRICT CADD STANDARDS
- HIGHWAY STANDARDS

HIGHWAY STANDARDS

406201	701306
442201	701311
606001	701336
630301	701901
667101	780001
701006	781001
701011	

DISTRICT CADD STANDARDS

406101-D4	630101-D4
440001-D4	780001-D4
602006-D4	

ADT = 1,500
 MU = 12%
 SU = 6%
 (18% TRUCK TRAFFIC)

CONTRACT NO. 68890

**STATE OF ILLINOIS
 DEPARTMENT OF TRANSPORTATION
 DIVISION OF HIGHWAYS
 VARIOUS**

**SECTION (180X, 130, 102)RS-3; 129RS-4, 101RS-2
 PEORIA COUNTY
 C-94-081-09**

SHEET **66** OF 100
 D-94-056-09

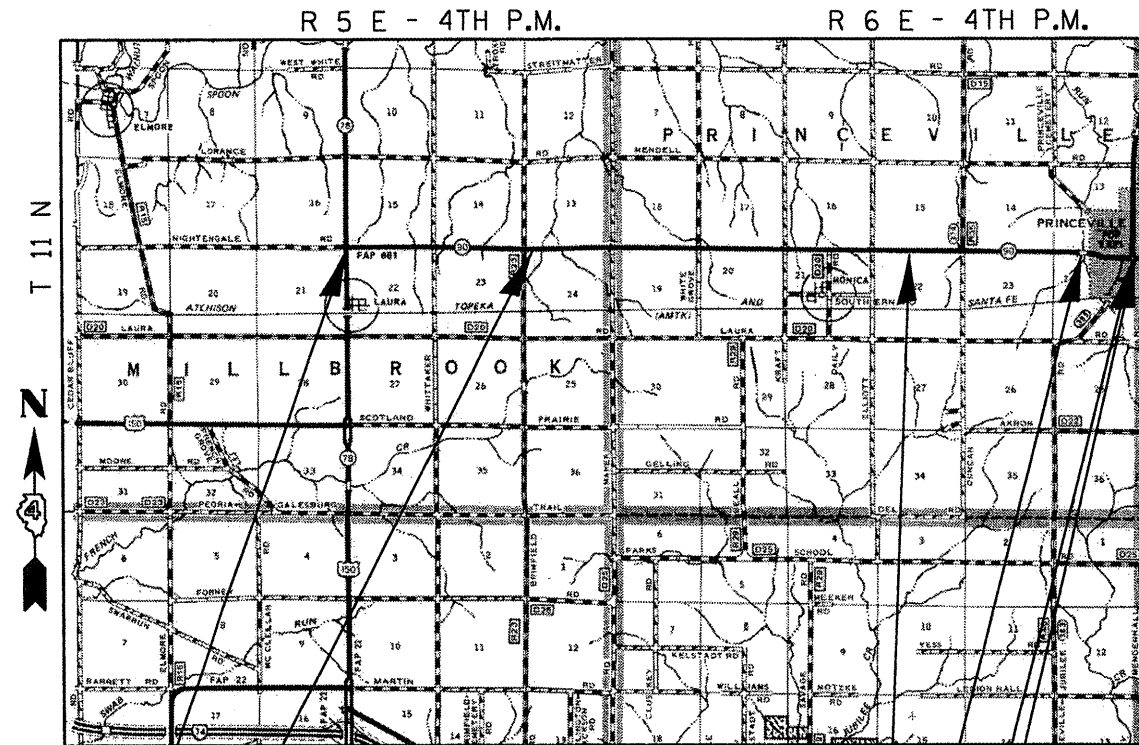

PROPOSED IMPROVEMENT

THIS IMPROVEMENT CONSISTS OF PAVEMENT
 PATCHING, HOT-MIX ASPHALT SURFACE
 REMOVAL AND OVERLAY, UPGRADING OF
 SAFETY FEATURES, AND OTHER COLLATERAL
 WORK.

Cover Sheet for Information Only

**J.U.L.I.E.
 JOINT UTILITY LOCATION INFORMATION FOR EXCAVATION
 1-800-892-0123**

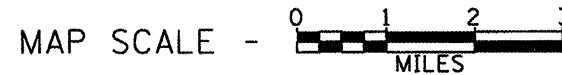

STATION EQUATION
 113+70.60 (BK) = 113+69.59 (AH)

STATION EQUATION
 332+01.31 (BK) = 10+70.84 (AH)

BRIDGE OMISSION (S.N. 072-0034)
 STA.114+97 TO STA. 115+63

STATION EQUATION
 149+02.31 (BK) = 592+04.48 (AH)

IMPROVEMENT BEGINS
 IL90 STA. 0+12

IMPROVEMENT ENDS
 IL90/IL91 STA.
 590+93

GROSS LENGTH = 47,108.27 FEET = 8.922 MILES

NET LENGTH = 47,042.27 FEET = 8.910 MILES

PRINTED BY THE AUTHORITY OF THE STATE OF ILLINOIS

PROJECT ENGR.: M. ADDIS

DESIGNER: K. KILMAN