

F.A.I. RTE.	SECTION	COUNTY	TOTAL SHEETS	SHEET NO.
72	*	**	104	40

STA. 1437+50 TO STA. 1460+00
 FED. ROAD DIST. NO. ILLINOIS FED. AID PROJECT

- 74(10-70)RS-3 & (10-71,73)RS-2
- PIATT & CHAMPAIGN CONTRACT NO. 70025

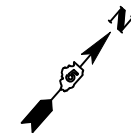

EXIST CURVE (MAINLINE)
 PI STA. = 1446+20.10
 $\Delta = 31^\circ 24' 31''$ (RT)
 D = $1^\circ 16' 00''$
 R = 4,523.55'
 T = 1,271.88'
 L = 2,479.74'
 E = 175.41'
 e = -----
 T.R. = -----
 S.E. RUN = -----
 P.C. STA = 1433+48.22
 P.T. STA = 1458+27.95

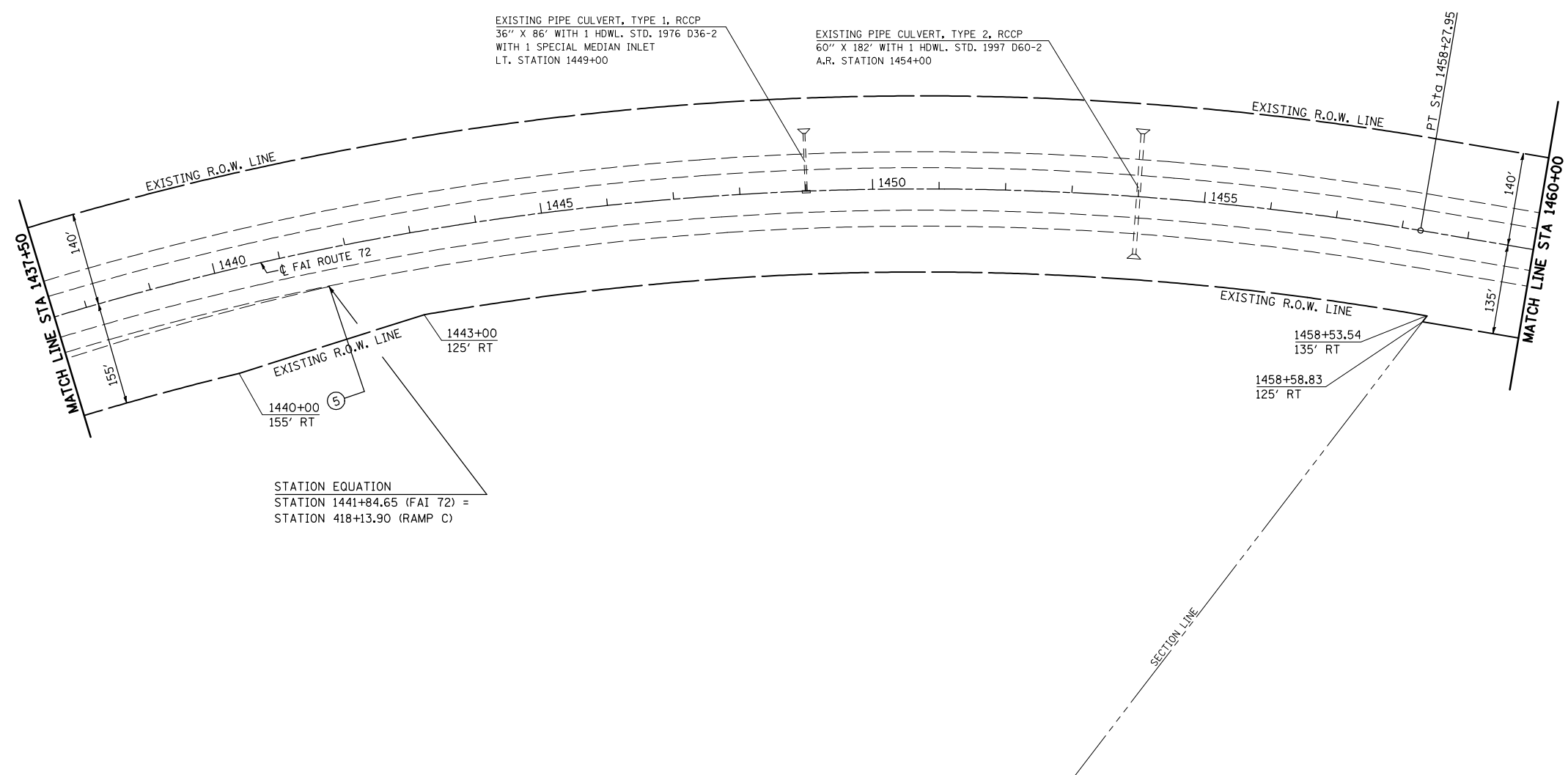

STATION EQUATION
 STATION 1441+84.65 (FAI 72) =
 STATION 418+13.90 (RAMP C)

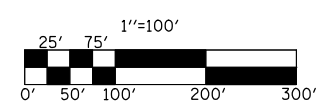

PLAN NOTE: THERE ARE GUARDPOSTS AND DELINEATORS TO BE REMOVED AND REPLACED IN THIS SECTION. THE ENGINEER SHALL CONDUCT A PRELIMINARY SURVEY TO DETERMINE QUANTITY OF EACH ITEM PRIOR TO CONSTRUCTION.

REVISIONS	
NAME	DATE

ILLINOIS DEPARTMENT OF TRANSPORTATION
PLAN VIEW
 F. A. I. ROUTE 72
 74(10,70)RS-3&(10-71,73)RS-2
 PIATT & CHAMPAIGN COUNTY
 SCALE: 1" = 100'
 DATE: JULY 2003
 DRAWN BY
 CHECKED BY