

F.A.I. RTE.	SECTION	COUNTY	TOTAL SHEETS	SHEET NO.
72	*	**	104	42

STA. 1487+00	TO STA. 1513+00
FED. ROAD DIST. NO.	ILLINOIS FED. AID PROJECT

- 74(10-70)RS-3 & (10-71,73)RS-2
- PIATT & CHAMPAIGN CONTRACT NO. 70025

EXIST CURVE (MAINLINE)  
 PI STA. = 1514+82.04  
 $\Delta = 27^\circ 38' 10''$  (RT)  
 $D = 1^\circ 00' 00''$   
 $R = 5,729.60'$   
 $T = 1,409.24'$   
 $L = 2,763.62'$   
 $E = 170.76'$   
 $e = \text{-----}$   
 $T.R. = \text{-----}$   
 $S.E. \text{ RUN} = \text{-----}$   
 $P.C. \text{ STA} = 1500+72.80$   
 $P.T. \text{ STA} = 1528+36.43$

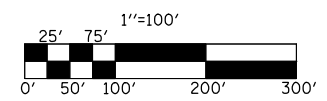
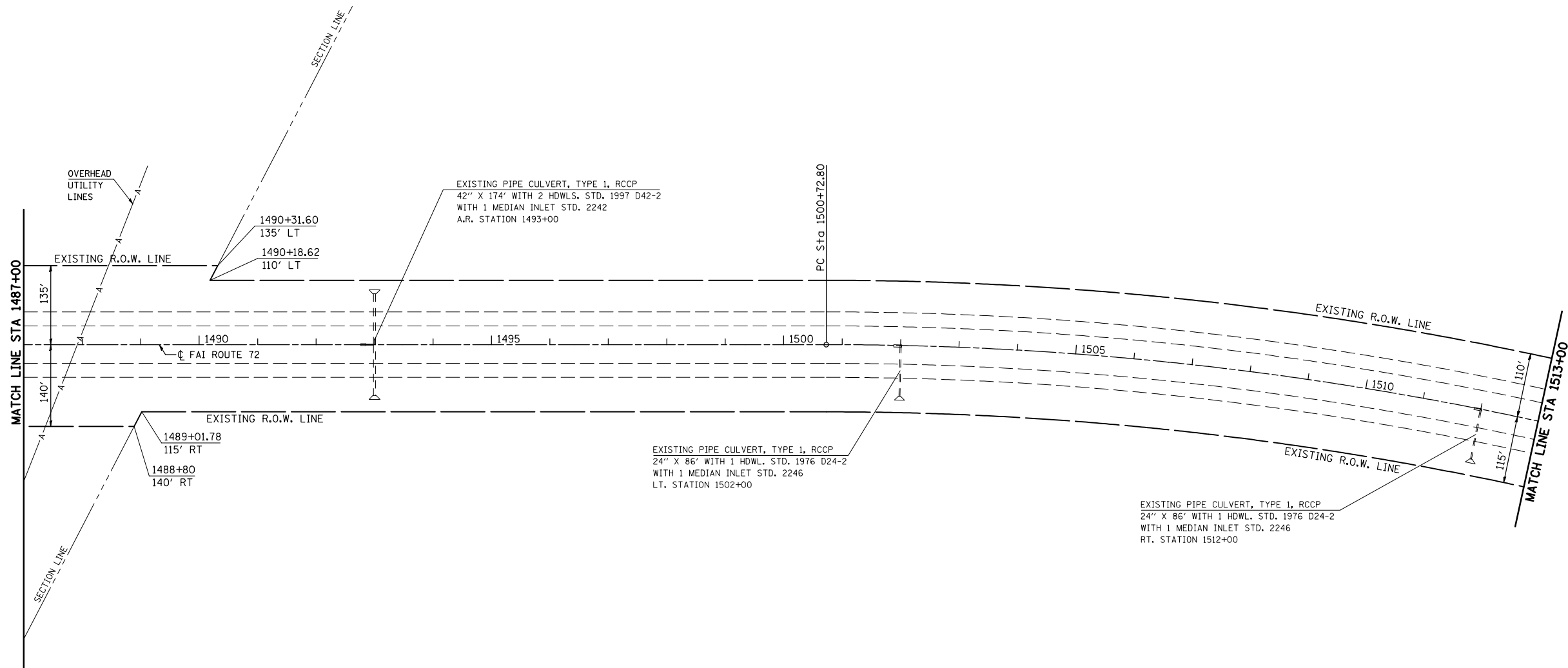

PLAN NOTE: THERE ARE GUARDPOSTS AND DELINEATORS TO BE REMOVED AND REPLACED IN THIS SECTION. THE ENGINEER SHALL CONDUCT A PRELIMINARY SURVEY TO DETERMINE QUANTITY OF EACH ITEM PRIOR TO CONSTRUCTION.

REVISIONS	
NAME	DATE

ILLINOIS DEPARTMENT OF TRANSPORTATION  
**PLAN VIEW**  
 F. A. I. ROUTE 72  
 74(10, 70)RS-3&(10-71, 73)RS-2  
 PIATT & CHAMPAIGN COUNTY  
 SCALE: 1" = 100'  
 DATE: JULY 2003  
 DRAWN BY \_\_\_\_\_  
 CHECKED BY \_\_\_\_\_