

F.A.I. RTE.	SECTION	COUNTY	TOTAL SHEETS	SHEET NO.
72	*	**	104	59

STA. 1974+00	TO STA. 2000+00
FED. ROAD DIST. NO.	ILLINOIS FED. AID PROJECT

- 74(10-70)RS-3 & (10-71,73)RS-2
- PIATT & CHAMPAIGN CONTRACT NO. 70025



EXIST CURVE (WB)  
 PI STA. = 1999+98.00  
 $\Delta = 17^\circ 12' 50''$  (RT)  
 $D = 2^\circ 00' 00''$   
 $R = 2,864.76'$   
 $T = 433.61'$   
 $L = 860.69'$   
 $E = 32.63'$   
 $e = \text{-----}$   
 $T.R. = \text{-----}$   
 $S.E. RUN = \text{-----}$   
 $P.C. STA = 1995+64.39$   
 $P.T. STA = 2004+25.08$

EXIST CURVE (EB)  
 PI STA. = 2001+62.95  
 $\Delta = 34^\circ 56' 40''$  (RT)  
 $D = 2^\circ 10' 00''$   
 $R = 2,644.41'$   
 $T = 832.37'$   
 $L = 1,612.81'$   
 $E = 127.91'$   
 $e = \text{-----}$   
 $T.R. = \text{-----}$   
 $S.E. RUN = \text{-----}$   
 $P.C. STA = 1993+30.58$   
 $P.T. STA = 2009+43.39$

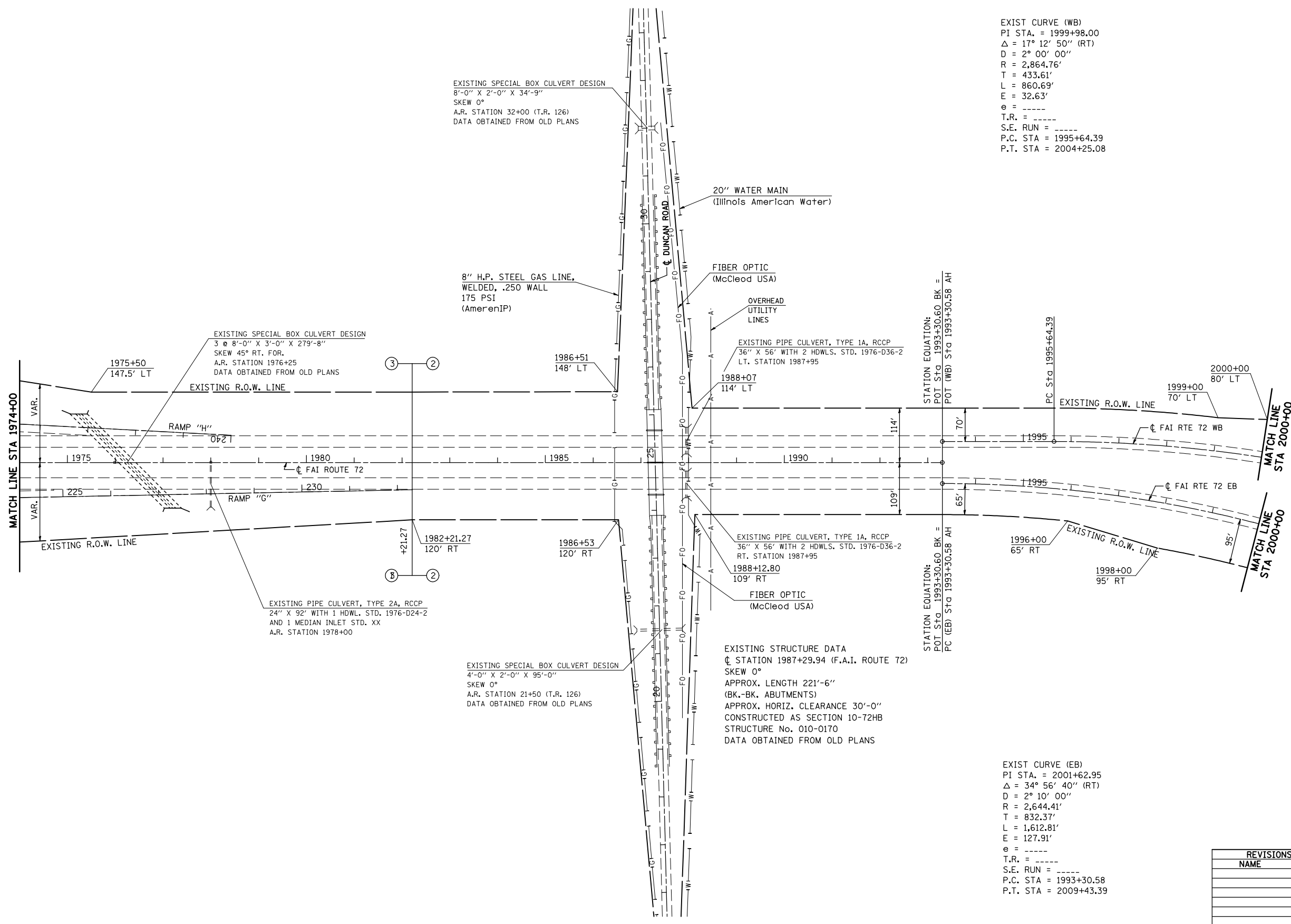

SEE DETAIL FOR IMPACT ATTENUATORS (NON-REDIRECTIVE) TEST LEVEL 3

PLAN NOTE: UPON COMPLETION OF THE PROJECT, THE VERTICAL CLEARANCES OF ALL AFFECTED OVERHEAD STRUCTURES SHALL BE VERIFIED AND REPORTED TO THE BUREAU OF OPERATIONS BY THE RESIDENT ENGINEER.

PLAN NOTE: THERE ARE GUARDPOSTS AND DELINEATORS TO BE REMOVED AND REPLACED IN THIS SECTION. THE ENGINEER SHALL CONDUCT A PRELIMINARY SURVEY TO DETERMINE QUANTITY OF EACH ITEM PRIOR TO CONSTRUCTION.

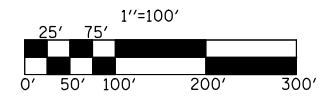

REVISIONS	
NAME	DATE

ILLINOIS DEPARTMENT OF TRANSPORTATION  
**PLAN VIEW**  
 F. A. I. ROUTE 72  
 74(10, 70)RS-3&(10-71, 73)RS-2  
 PIATT & CHAMPAIGN COUNTY  
 SCALE: 1" = 100'  
 DATE: JULY 2003  
 DRAWN BY  
 CHECKED BY