

F.A.P. RTE.	SECTION	COUNTY	TOTAL SHEETS	SHEET NO.
709	(104)RS-1	MCLEAN	21	1

STATE OF ILLINOIS
DEPARTMENT OF TRANSPORTATION
DIVISION OF HIGHWAYS

**PROPOSED
HIGHWAY PLANS**

F.A.P. ROUTE 709 (U.S. 136)
SECTION (104)RS-1
MCLEAN COUNTY

RESURFACING (SMART)
IL 54 TO CHAMPAIGN COUNTY LINE
C-95-029-06

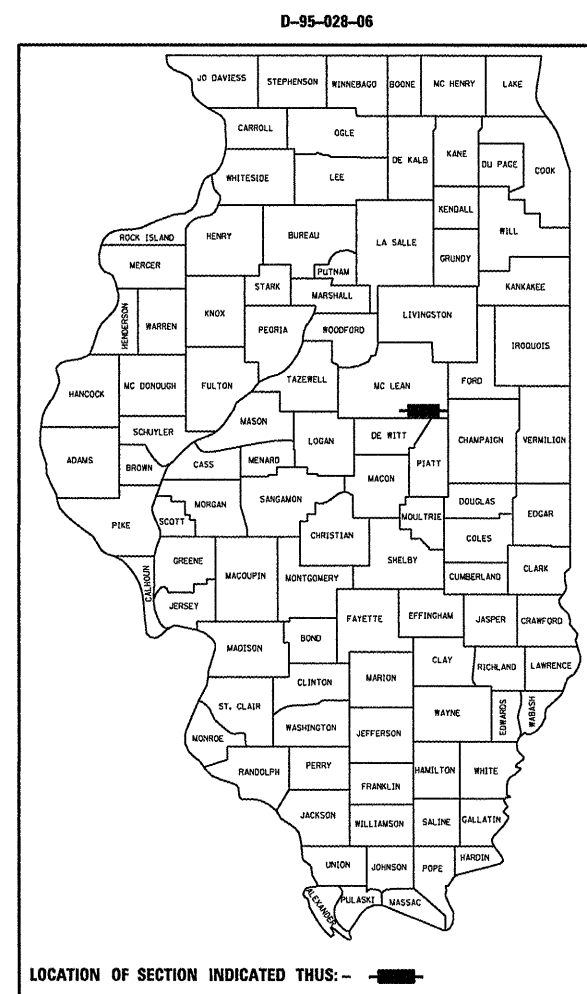

LOCATION OF SECTION INDICATED THIS: - [Black Box] -

FOR INDEX OF SHEETS, SEE SHEET NO. 2
FOR SUMMARY OF QUANTITIES, SEE SHEET NO. 4-5

CURRENT ADT
CURRENT ADT = 1,100 (2009)
20 YR ADT = 1,500 (2029)
PU & PC % = 76.1
SU % = 14.8
MU % = 9.1

DESIGN DESIGNATION
MINOR ARTERIAL (RURAL)

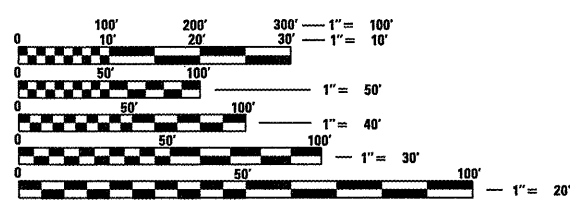

FULL SIZE PLANS HAVE BEEN PREPARED USING STANDARD ENGINEERING SCALES. REDUCED SIZED PLANS WILL NOT CONFORM TO STANDARD SCALES. IN MAKING MEASUREMENTS ON REDUCED PLANS, THE ABOVE SCALES MAY BE USED.

J.U.L.I.E.
JOINT UTILITY LOCATION INFORMATION FOR EXCAVATION
1-800-892-0123 BELLFLOWER TOWNSHIP

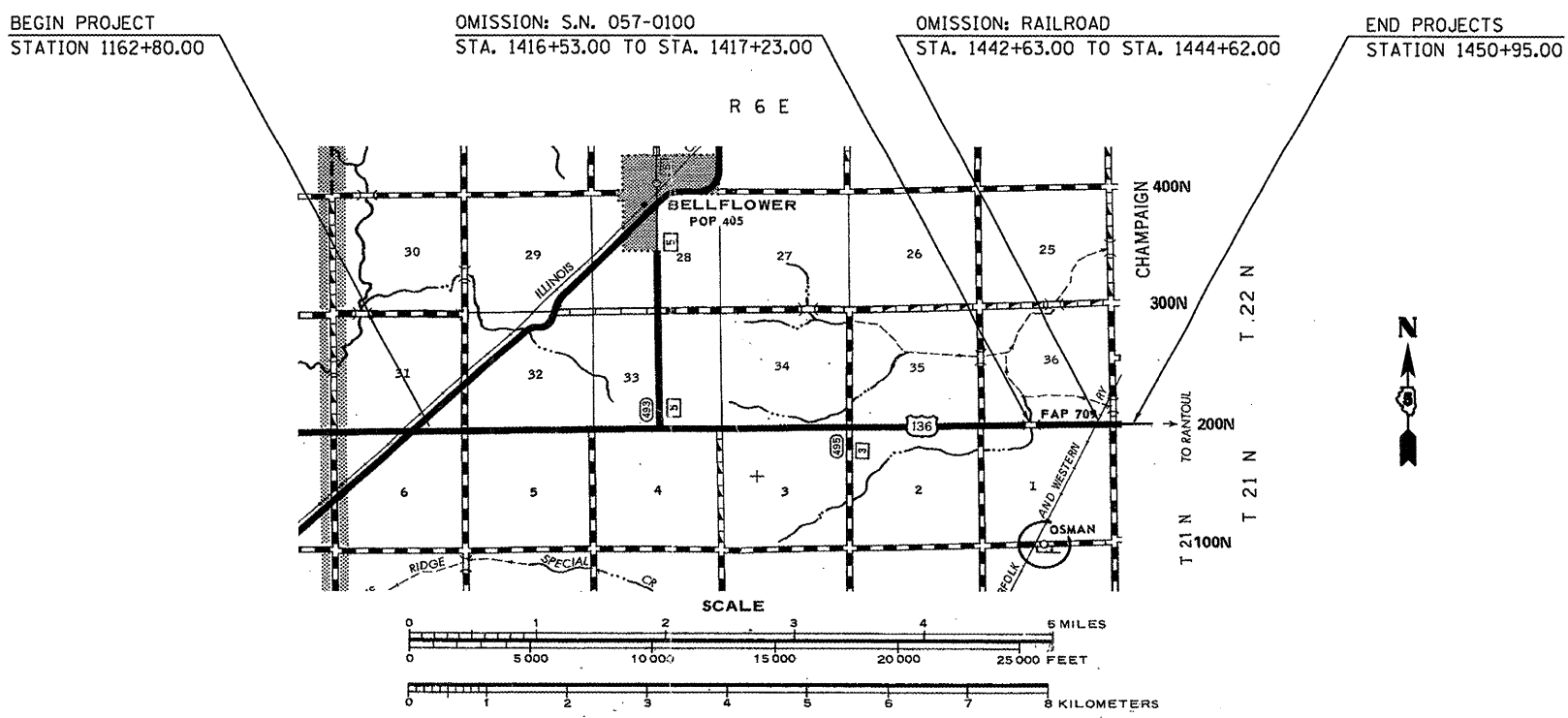

TOTAL LENGTH OF SECTION & PROJECT = 28,815.00 FEET = 5.457 MILES
NET LENGTH OF SECTION & PROJECT = 28,546.00 FEET = 5.406 MILES

STATE OF ILLINOIS
DEPARTMENT OF TRANSPORTATION
DIVISION OF HIGHWAYS
SUBMITTED 3/20 20 09
Jessie K. Gove
DEPUTY DIRECTOR OF HIGHWAYS, REGION ENGINEER
May 1, 20 09
Charles G. Ingewoll
ENGINEER OF DESIGN AND ENVIRONMENT
May 1, 20 09
Christine M. Reed
DIRECTOR OF HIGHWAYS, CHIEF ENGINEER

**PRINTED BY THE AUTHORITY
OF THE STATE OF ILLINOIS**

SQUAD LEADER: RANDY AUSTIN
 PROJECT ENGINEER: KEVIN TRAPP
 (217)465-4181
 3/17/2009
 FILE NAME = G:\p\w\k\p\w\DOT_AUSTIN\1\DOT_028975\70508\plan.dgn
 PLOT SCALE = 42.3529 / IN.
 USER NAME = oustrfmr