

LEGEND

- ☒ EXISTING BASE MOUNTED MEDIUM INTENSITY TAXIWAY LIGHT
- EXISTING STAKE MOUNTED MEDIUM INTENSITY TAXIWAY LIGHT
- ☒ EXISTING STAKE MOUNTED MEDIUM INTENSITY RUNWAY LIGHT
- ☒ EXISTING BASE MOUNTED MEDIUM INTENSITY RUNWAY LIGHT
- EXISTING STAKE MOUNTED THRESHOLD LIGHT
- ☒ EXISTING BASE MOUNTED THRESHOLD LIGHT
- (4) EXISTING CONCRETE ENCASED DUCT BANK (NUMBER OF WAYS)
- GRS EXISTING GRS CONDUIT (CONDUIT SIZE NOTED)
- ☒_{HH} EXISTING ELECTRICAL HANDHOLE
- ⊙ EXISTING ELECTRICAL SPLICE CAN
- ☒ EXISTING WIND CONE
- ☒ EXISTING AIRFIELD GUIDANCE SIGN
- CKT#1 --- EXISTING RUNWAY 4/22 CIRCUIT
- CKT#2 --- EXISTING RUNWAY 16/34 CIRCUIT
- CKT#3 --- EXISTING TAXIWAY A, AA, C, D, E CIRCUIT
- CKT#4 --- EXISTING TAXIWAY B/BB CIRCUIT
- CKT#5 --- EXISTING TAXIWAY H CIRCUIT
- CKT#7 --- EXISTING WINDCONE/RUNWAY 4 PAPI
- CKT#8 --- EXISTING WINDCONE/RUNWAY 22 PAPI
- CKT#10 --- EXISTING RUNWAY 22 REIL
- CKT#11 --- EXISTING AWOS
- CKT#17 --- EXISTING RUNWAY 16 PAPI
- CKT#18 --- EXISTING RUNWAY 34 PAPI
- ⊙_E EXISTING ELECTRICAL MANHOLE
- □ □ □ EXISTING PRECISION APPROACH PATH INDICATORS (PAPI) L-880 SYSTEM
- △ EXISTING RUNWAY END IDENTIFIER LIGHT (REIL)
- R EXISTING ITEM TO BE REMOVED

KA036
 K:\Konkakee\0707502\Draw\Sheets
 FILE: Econd-1.dwg
 LAYOUT: Layout1
 UPDATE BY: Jim Ohse
 SURVEY BOOK #
 DATE: Thursday, April 17, 2008 2:18:29 PM
 XREF DWG: tbcint.dwg
 tb.dwg
 elec-base.dwg



REVISIONS		
NUMBER	BY	DATE

0 1 2
 THIS BAR IS EQUAL TO 2" AT FULL SCALE (34X22).

**GREATER KANKAKEE AIRPORT
 KANKAKEE, ILLINOIS
 REHABILITATE AIRFIELD LIGHTING SYSTEM -
 RUNWAY 16/34 AND TAXIWAY H
 EXISTING CONDITIONS/PROPOSED REMOVALS
 RUNWAY 16/34
 STA. 0+00 TO STA. 11+00**

THE INFORMATION SHOWN ON THESE PLANS HAS BEEN OBTAINED FROM AVAILABLE RECORDS. NEITHER THE OWNER NOR THE ENGINEER ASSUMES ANY RESPONSIBILITY WHATSOEVER IN RESPECT TO THE ACCURACY OR SUFFICIENCY OF THE INFORMATION AND THERE IS NO GUARANTEE EITHER EXPRESSED OR IMPLIED THAT THE CONDITIONS INDICATED ARE REPRESENTATIVE OF THOSE TO BE ENCOUNTERED IN THE FIELD. IT SHALL BE THE CONTRACTOR'S RESPONSIBILITY TO VISIT THE SITE AND ACQUAINT HIMSELF WITH THE EXISTING CONDITIONS.

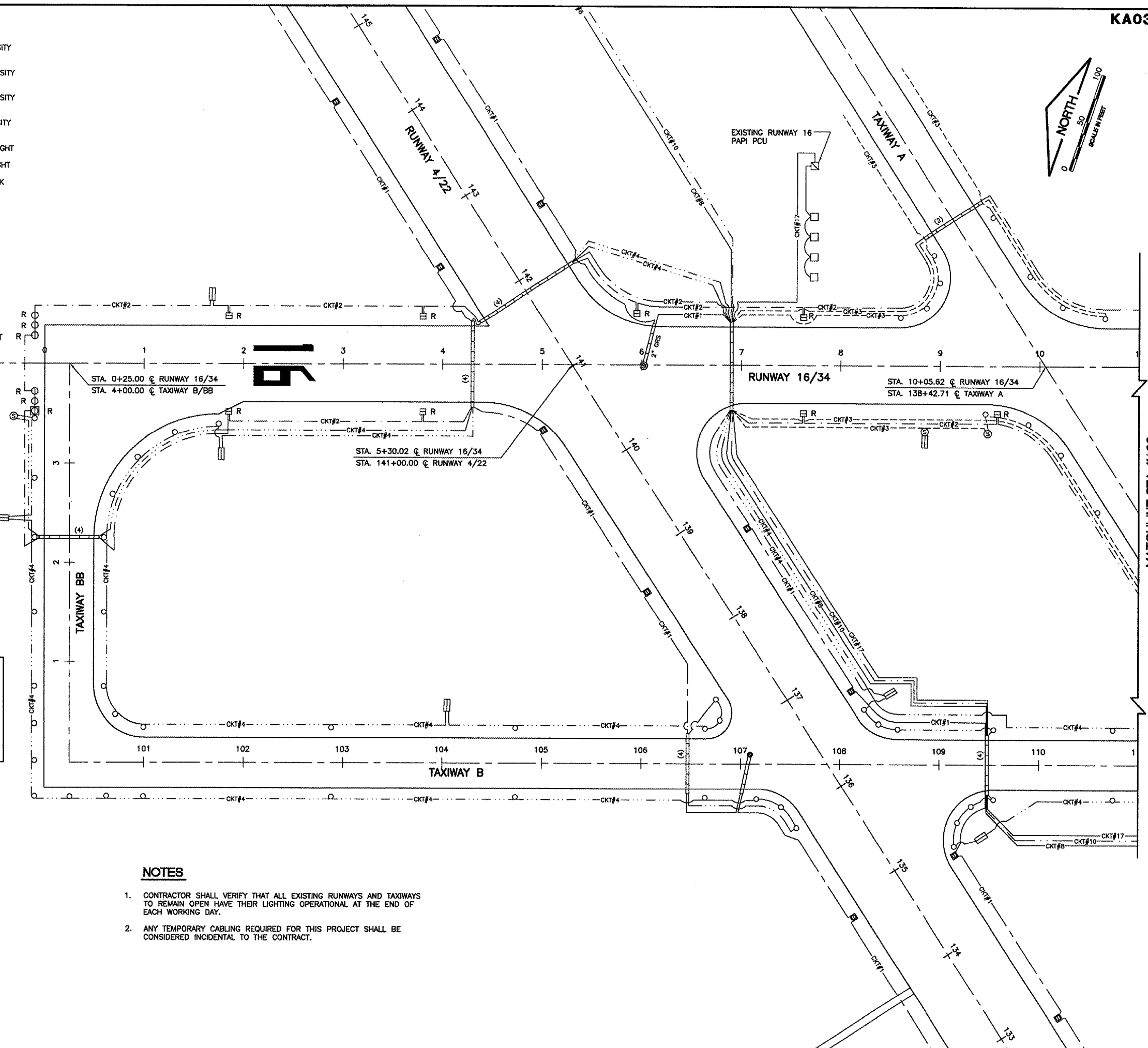
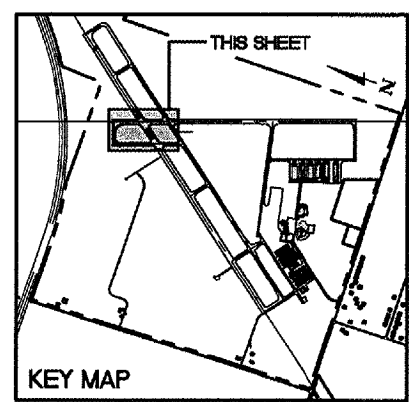

NOTES

1. CONTRACTOR SHALL VERIFY THAT ALL EXISTING RUNWAYS AND TAXIWAYS TO REMAIN OPEN HAVE THEIR LIGHTING OPERATIONAL AT THE END OF EACH WORKING DAY.
2. ANY TEMPORARY CABLING REQUIRED FOR THIS PROJECT SHALL BE CONSIDERED INCIDENTAL TO THE CONTRACT.

© Copyright CMT, Inc.

CMT
 CRAWFORD, MURPHY & TILLY, INC.
 CONSULTING ENGINEERS
 License No. 184-00085

DESIGN BY:	MND
DRAWN BY:	JRO
CHECKED BY:	MND
APPROVED BY:	
DATE:	02/29/08
JOB No:	07075-02
IL PROJECT:	IKK-3743
A.I.P. PROJECT:	3-17-0057-B13

SHEET 6 OF 17 SHEETS